



Trim tabs



AutoTrim Tabs

Made of crosslinked **polyethylene**, self adjusting. Special shape and ribbing, initially helps the hull to plane, increases, it aligns with the hull as speed increases, ensuring perfect attitude and stability; easy universal installation.

Code	mm	For boats
51.640.00	255x210	up to 6 m
51.650.00	380x260	up to 6/8 m

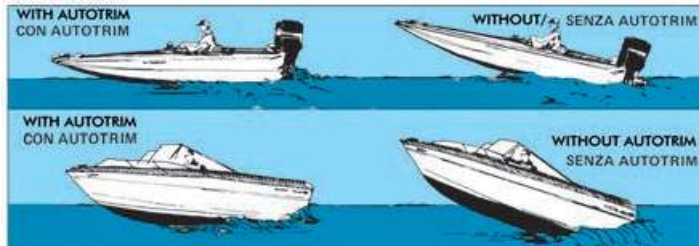

Standard series trim tabs, depth of 230 mm

Made of **stainless steel**, model fitted with 2.5 mm thickness and special swivelling hinge; the tab can rotate 180° without forcing or breaking the transom bracket.

Designed to be mounted: with **electro-hydraulic kit** Bennett 51.235.12/24; with **electro-mechanic kit** EM 52.350.00 (only standard series 51.134.01/02/03/04/05); with **mechanic kit** 51.134.00 (standard series 51.134.01/2/3/4 only).

Code	Flap pair cm	For boats m	Preset for hydraulic		
			actuators 51.235.12/24	actuators 51.350.00	actuators 51.134.00
51.134.01	30x23	4/4,5	x	x	x
51.134.02	40x23	4,5/5	x	x	x
51.134.03	55x23	5/6	x	x	x
51.134.04	75x23	6,5/7,5	x	x	x

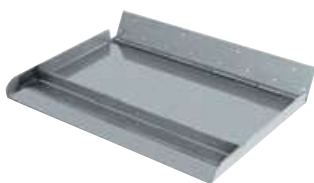

Pair of Maxi series trim tabs, 300-mm depth, fitted with side and central rib.

Made of **stainless steel**, model fitted with 2,5 mm thickness and special swivelling hinge; the tab can rotate 180° without forcing or breaking the transom bracket. Designed to be mounted: with **electro-hydraulic kit** Bennett 51.235.12/24; with **electro-mechanic kit** EM 52.350.00 (only standard series 51.134.01/02/03/04).

Code	Flap pair cm	For boats	Preset for hydraulic	
			actuators 51.235.12/24	Actuators 51.350.00
51.434.02	45x30	up to 6/7 m	x	x
51.434.03	55x30	up to 8/9 m	x	x
51.434.04	75x30	up to 9/10 m	x	x



Pair of HS series trim tabs suitable for hulls over 40-knot speed

Made of **stainless steel** exclusively by Osculati, model fitted with 2,5 mm thickness and special swivelling hinge; the tab can rotate 180° without forcing or breaking the transom bracket. Designed to be used: with **electro-hydraulic kit** Bennett 51.235.12/24; with **electro-mechanic kit** EM 52.350.00 (only standard series 51.134.01).

Code	Twin trim tabs cm	To match/order with
51.234.01	30x30	kit EM 51.350.00 - kit Bennett 51.235.12/24
51.234.02*	30x45	kit 51.235.12/24 + two cylinders separately 51.237.00 + 1 kit 51.240.00

* To be used with a **double cylinder** Bennet.

Trim tab actuators/pistons and accessories



Mechanical kit to operate Trim Tabs

Made of two 10-mm **stainless steel** turnbuckles, fitted with four **stainless steel** plates for mounting turnbuckles into the flaps and the hull, **four special cranks** to quickly lock and unlock turnbuckles by hand.

Code	For twin tabs
51.134.00	51.134.01; 51.134.02; 51.134.03; 51.134.04

Electro-mechanical trim tab actuator system EM

No hydraulic circuit, the whole mechanism is fitted into a **nylon fiberglass** cylinder. A small electric motor moves a series of worm gears to operate the lapped **stainless steel** piston. Easy and quick installation, the stern mounting plates and the tabs are interchangeable with Bennett cylinders.

Code	Version
51.350.00	Kit composed by 2 cylinder 12 V + command panel mod. 51.353.00 "Up-Down"
51.352.00*	Additional electromechanical rod "EM"

* When asking for flaps operated by 2 pairs of cylinders, please, order: 51.350.00 kit + 51.352.00 cylinder (2 pcs)

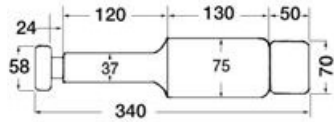

Additional or spare control panel for kit 51.350.00



Code	mm	For pistons
51.353.00	60x80	51.350.00

BENNET control panel for a hydraulic trim tab set



Includes: 2 switches, 4 LED lights for up and down control, 2 safety fuse holders.

Code	mm
51.239.03	60x80

Release relay RM 12

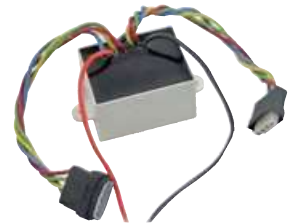

To be used with control panel models 51.239.01; 51.239.03, provides protection against damaging the control unit whenever the buttons up and down are activated simultaneously, or in case of two control stations.

Code	Suitable for
51.239.00	51.239.03

MENTE-MARINE control panels for flap automatic management

MENTE-MARINE control panel for flap automatic management

Compatible with all popular electromechanical and hydraulic trim tabs (Bennet, TrimTabs, Lenco, etc.). Control panel, position indicator and trim automatic management. No external parts. Connection instead of the series or existing panel and it uses the same cables. Wiring diagram of the different brands included.

Code	Model	Description
51.310.01	ACS R	Roll control (crosswise, only)
51.310.02	ACS RP	Roll and pitch control (crosswise and lengthwise)
51.310.03	ACS A	Roll and pitch control (crosswise and lengthwise with a possible second station for flybridge)
51.310.33	FCP	Second station panel to match to ACS A



Watch the video



Mente Marine

For the right attitude!

	51.310.02	51.310.01	51.310.03
Automatic pitch control Faster onto the plane and the bow is kept down at all speeds	<input checked="" type="checkbox"/>	<input checked="" type="checkbox"/>	<input checked="" type="checkbox"/>
Automatic roll control Crosswinds and uneven loading is automatically corrected	<input checked="" type="checkbox"/>	<input checked="" type="checkbox"/>	<input checked="" type="checkbox"/>
Manual control Manual control of the trim tabs	<input checked="" type="checkbox"/>	<input checked="" type="checkbox"/>	<input checked="" type="checkbox"/>
Tab position display The tab position is estimated and displayed for all kinds of trim tabs	<input checked="" type="checkbox"/>	<input checked="" type="checkbox"/>	<input checked="" type="checkbox"/>
Turning detection Automatic control is suspended while turning	<input checked="" type="checkbox"/>	<input checked="" type="checkbox"/>	<input checked="" type="checkbox"/>
For all sea conditions The automatic control adapts to varying sea conditions	<input checked="" type="checkbox"/>	<input checked="" type="checkbox"/>	<input checked="" type="checkbox"/>
Automatic retraction The trim tabs are retracted to prevent marine growth	<input checked="" type="checkbox"/>	<input checked="" type="checkbox"/>	<input checked="" type="checkbox"/>
Off the plane sleep Automatic control is suspended while off the plane	<input checked="" type="checkbox"/>	<input checked="" type="checkbox"/>	<input checked="" type="checkbox"/>
Direct connection The trim tabs are connected directly to the control panel	<input checked="" type="checkbox"/>	<input checked="" type="checkbox"/>	<input checked="" type="checkbox"/>
Separate control unit Optional flybridge panel available	<input checked="" type="checkbox"/>	<input checked="" type="checkbox"/>	<input checked="" type="checkbox"/>

LENCO electrical trim tabs

Easy to install since the mechanism is integral to the piston - no hydraulic component. The piston has a thrust force up to 340 kg and is made of high-resistance technopolymers while the rod is of stainless steel. A worm screw mounted on 12 ball bearings ensures a very precise and wearless movement for a long time. Suitable for vessels up to 70 feet.



LENCO

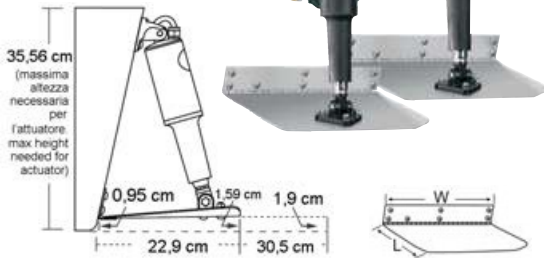

LENCO Trim Tab Kit - standard installation

The kit includes:

- 2 actuators 51.260.01 (LENCO code 15054-01)
- 2 stainless trim tabs
- 2 x 20' (6 m) extension cables 51.259.03 (LENCO code 30133-103D) to connect the actuator to the central unit, Watertight Deutsch Connectors.

The control panel has to be bought separately.

Code	Volt	flaps			Recommended for hulls m
		L mm	W mm	L"xW"	
51.250.01	12	229	305	9x12	5 - 7,5
51.250.02	12	229	457	9x18	6,6 - 9
51.250.03	12	229	610	9x24	8 - 12
51.250.07	12	305	457	12x18	8 - 10,8
51.250.08	12	305	610	12x24	9 - 13,2

LENCO

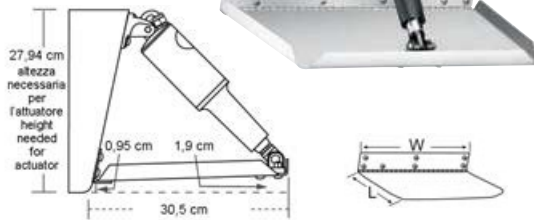

LENCO trim tab kit - Edge Mounting

Deep but narrow flaps.

Suitable for inflatables with little room on stern.

The kit includes:

- 2 actuators 51.260.01 (LENCO code 15054-01)
- 2 stainless steel tabs
- 2 x 20' (6 m) extension cables 51.259.03 (LENCO code 30133-103D) to connect the actuator to the central unit, Watertight Deutsch Connectors.

The control panel has to be bought separately.

Code	Volt	flaps			Recommended for hull metres m
		L mm	W mm	L"xW"	
51.251.01	12	305	229	12x9	5 - 6,5
51.251.02	12	305	305	12x12	6 - 9

LENCO



LENCO Heavy Duty Performance (HD) trim tab kit

Suitable for large/ high speed RIBS and small speed boats Equipped with sacrificial anodes.

The kit includes:

- 2 actuators 51.260.02 (LENCO code 15055-01)
- 2 stainless steel flaps
- 2 x 20' (6 m) extension cables 51.259.03 (LENCO code 30133-103D) to connect the actuator to the central unit, watertight Deutsch Connectors.

The control panel has to be bought separately.

Code	Volt	flaps			Recommended for hulls metres m
		L mm	W mm	L"xW"	
51.252.01	12	355	305	14x12	5,5 - 10,5
51.252.02	12	406	355	16x12	6 - 11,4
51.252.03	12	457	355	18x14	6,6 - 12,4

LENCO



LENCO trim tab kit - Super Strong

Suitable for fast or heavy vessels.

Trim tab thickness: 4,6 mm. Equipped with sacrificial anodes.

The kit includes:

- 2/4 actuators 51.260.03 at 12V (LENCO code 15056-01), or 51.260.04 at 24V (LENCO code 15063-001)
- 2 stainless steel flaps.

The control panel and the extensions cables to connect the actuator to the central unit have to be purchased separately.

Code	Volt	flaps			Actuator	Recommende for hulls metres m
		L mm	W mm	L"xW"		
51.253.01	12	305	610	12x24	single	8,1 - 13
51.253.03	12	406	765	16x30	double	12 - 18
51.253.12	24	305	765	12x30	single	10,5 - 14,4
51.253.13	24	406	765	16x30	double	13,5 - 18

LENCO High Performance HP trim tab

Suitable for high speed motorboats/racing boats

The kit includes:

- 2 actuators 51.260.03 (LENCO code 15056-01)
- 2 stainless trim tabs

The control panel and the extension cables to connect the actuator to the central unit have to be purchased separately.

Code	Volt	flaps			Recommended for hulls m
		L mm	W mm	L"xW"	
51.254.02	12	457	305	18x12	8 - 12

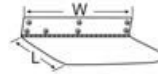
LENCO**LENCO High Performance HP double actuator trim tab kit**

Suitable for high speed motorboats/racing boats.

The kit includes:

- 4 actuators 51.260.03 (LENCO code 15056-1)
- 2 electro-polished stainless steel trim tabs.

The control panel and the extension cables for connection to the central unit are sold separately.

Code	V	flaps			Recommended for hulls
		L mm	W mm	L"xW"	
51.254.10	12	533	355	21x14	7,20 - 12,60
51.254.11	12	635	355	25x14	8,40 - 13,80

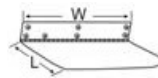
LENCO**LENCO Tactile Switch control panels**

Panel + watertight control box with Deutsch Connectors outlets. Plug&Play wiring and Retractor function to retract the flaps when disconnected from the power supply. 92-cm power cables. LED version with switching up every 5-mm move.

Code	LENCO code	Version	V	LED	flaps cm
51.256.01	15169-001	Standard	12	No	7x7
51.256.12	15170-001	Kit for single piston	12/24	Yes	7x7
51.256.13	15171-001	Kit for double piston	12/24	Yes	7x7

For OPTIONAL extension cables see 51.259.xx.

LENCO

▲ 51.256.12/13

▲ 51.256.01

LENCO Flybridge kit for second station

It includes: control panel with Cree LED lights + cable for connection to the main control panel.

Code	LENCO code	Version	V	flaps cables m
51.257.12	11841-002	With side LED lights	12/24	6
51.257.13	11841-003	With side LED lights	12/24	9



These kits only matches control panels 51.256.12/13.

LENCO**LENCO Retrofit kit for Bennet trim tabs. From hydraulic to electric system**

This kit includes:

- 2 electrical actuators
- 2 upper brackets (some bores as Bennet)
- 2 connectors for connection to Bennet wiring
- screws included.

This kit can replace a Bennet kit thus avoiding the hydraulic central unit. It uses the existing Bennet flaps, wiring and panel.

Code	LENCO code	Version	Volt
51.258.01	15064-001	universal kit	12

This kit isn't compatible with Bennet last-generation LED control panels (51.246.01; 51.246.02; 51.246.03)

**LENCO**



LENCO Autoglide™ automatic trim tab control device

This device automatically adjusts your trim tabs via a built-in GPS system + 3 gyroscopes + 3 accelerometers depending on the sea conditions.

Three working modes:

- 1) Drive in harbour: it prevents or minimizes the movement of flaps.
- 2) Gliding: it lowers the tabs while gliding and then retracts them when the boat has reached its trim.
- 3) Navigation: it automatically adjusts the flaps depending on the rolling and pitching angles, keeping the boat in its best trim according to sea conditions. It can also save 2 manually-set trims.

Version A: supplied with GPS receiver/antenna and NMEA 2000 Network.

Version B: supplied without receiver/antenna and NMEA 2000 Network. It can be connected to an existing GPS antenna and NMEA 2000 network.

Complete kit	LENCO code	For systems	Version	V
51.265.01	15500-101	single cylinder systems	A	12/24
51.265.02	15501-101	double cylinder systems	A	12/24
51.265.12	15505-101	double cylinder systems	B	12/24

The kit includes what's necessary for installation (keyboard, control box, cables, GPS antenna, adapters, etc.)



LENCO cables to connect actuators to the central unit

Cables with watertight Deutsch Connectors. They can be used as cables or extensions. Please, order 1 cable for each actuator.

Code	LENCO code	←→	
		feet	metres
51.259.02	30133-002D	14'	4.20
51.259.03	30133-103D	20'	6.00
51.259.04	30142-001	26'	7.80



LENCO spare actuators

Made of high-resistance glass-fiber reinforced nylon and mirror-polished stainless steel cylinder. UV-resistant.

Code	Model	V	For connector kit	Bore distance when closed mm	Stroke mm	Lower eye
51.260.01	15054-001	12	Standard Mount - Edge Mount	292	57	5/16" (8 mm)
51.260.11	15061-001	24	Standard Mount - Edge Mount	292	57	5/16" (8 mm)
51.260.02	15055-001	12	Heavy Duty Performance (HD)	273	57	5/16" (8 mm)
51.260.03	15056-001	12	Super strong - High Performance (HP)	273	57	5/16" (9,5 mm)
51.260.04	15063-001	24	Super strong	273	57	5/16" (9,5 mm)

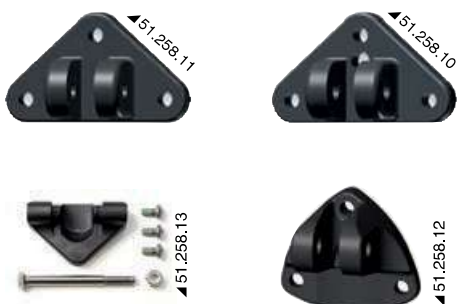
Spare mounting brackets

Fastening plates for LENCO cylinders.

Code	code	Description
51.258.10	50015-001D	Upper bracket for actuators up to 2007
51.258.11	50014-001D	Lower bracket for Standard actuators (51.260.01/11)
51.258.12	15085-001	Upper bracket for actuators after 2007
51.258.13	15140-001	Lower bracket for 101-XD actuators (51.260.02/03/04)

BENNETT trim tab

BENNETT trim tab kit

It includes: electronic central unit, **twin hydraulic actuators**, watertight control panel, electric wiring, etc.

Code	V
51.235.12	12
51.235.24	24

-  **51.237.01** Shorter cylinders available on request instead of standard cylinders 51.237.00 *OPTIONAL*
- 51.239.04** Spare control panel





Additional BENNETT hydraulic actuator

Additional cylinder for art. 51.235.12; 51.235.24

When a trim tab with **2 twin** cylinders is required, please **order**: kit 51.235.12; 51.235.24, **2 cylinders** 51.237.00 and 1 kit 51.240.00.

Code	Cylinder	Length mm		
		Total (closed)	Stroke	Total (opened)
51.237.00	1	340	80	420
51.237.01*	1	300	80	380

-  **51.240.00** Kit of fittings for additional pistons

 To be used when a standard cylinder cannot be installed for reasons of space



▲ 51.237.00/01



▲ 51.240.00

Euro Rocker control panel - BENNETT

Fitted with toggle keys.

Code	←→ mm	
	faceplate	recess
51.239.04	70x70	56x50



BENNET Flap Euro Rocker control panel

Paired with the LED light digital trim tabs and with the FLAP automatic closing system (when the power supply is shut off).
Fitted with central unit and sensor heads.

Code	Version	V
51.246.01	Single station	12
51.246.02	Single station	24



BENNETT spare parts

Code	Description
51.238.12	Bennet spare system 12 V
51.238.24	Bennet spare system 24 V
51.232.01	Spare solenoid valve for Bennet system red wire 12 V
51.232.02	Spare solenoid valve for Bennet system green wire 12 V
51.232.03	Spare solenoid valve for Bennet system red wire 24 V
51.232.04	Spare solenoid valve for Bennet system green wire 24 V



Mufflers and silencers



Horizontal silencers for water-cooled engines.

Made of HD polyethylene.

Code	D mm	A mm	B mm	C mm
51.376.01	40	150	105	372
51.376.02	45	150	105	372
51.376.03	50	150	105	372
51.376.04	60	150	105	372
51.376.05	75	150	105	372
51.377.01	90	183	135	460
51.377.02	102	183	135	460

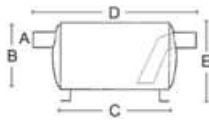

Exhaust systems

Silencer, wet exhaust systems. The silencer effectively silences engine exhaust noise with a minimum of back pressure.

The silencer also functions as an effective water-lock. Its large capacity for cooling water eliminates the risk of water siphoning back into the engine when stopped.

Adjustable mounting brackets make the silencer easy to install. Material: Reinforced rubber with acid resistant stainless steel end pieces.

Code	Ø A mm	Ø B mm	C mm	D mm	E mm	Volume liter	Max HP
51.390.01	40	160	250	420	190	5	50
51.390.03	45	127	250	400	145	3	35
51.390.05	51	160	250	420	190	5	50
51.390.07	60	160	375	560	190	7.5	100
51.390.09	76	160	375	560	190	7.5	100
51.390.11	90	203	500	760	215	15	200
51.390.13	100	203	500	760	215	15	200

Exhaust muffler-waterlock

Suitable for water-cooled engines, made of high density polyethylene.

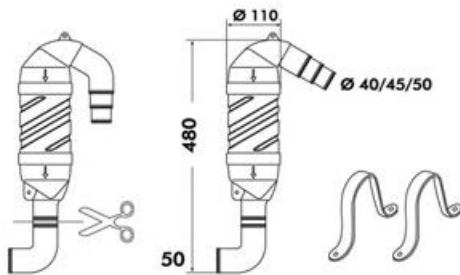

Code	Siphon	Size mm	Suitable for exhaust hoses mm
51.374.01	With inlet turned downwards	480x110	40/45/50
51.374.02	With 120° inlet	480x110	40/45/50



Exhaust muffler for water-cooled engines, 7 l

Made of high density polyethylene.



Code	Suitable for exhaust hose Ø mm	Capacity l	Working pressure	Length mm	Width mm	Height mm
51.370.00	40/45/50	7	max 0,3 BAR	760	290	400



Exhaust muffler for water-cooled engines

Made of high density Eltex.

Code	Max power HP	Mouths mm	Capacity l	A mm length	B mm length	C mm height	D mm width
51.371.00	115	55/60/65	20	322	660	320	220
51.372.00	150	75/90	33	370	760	400	290
51.372.01	300	100/115	33	370	760	400	290

Water/gas separator

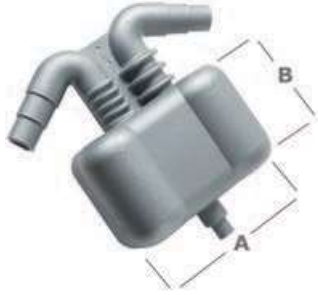

Code	Litres	Gas inlet/outlet fittings mm	Water inlet/outlet fittings mm	A mm	B mm
51.369.00	2,5	40/45/50	38/15	200	110
51.369.01	4,5	40/45/50	38/15	260	160

Antisiphon for water cooling engine



It must be installed on the exhaust line.

Code	Connection mm	Installation
51.368.00	da 13 a 38	wall

Antisiphon

Antisiphon device to be used on exhaust lines, seawater connectors and WCs installed under the floating line.

Code	Hose connector Ø mm	mm
51.367.00	13/19/25/32 (1/2"-3/4"-1"-1 1/4")	92x150



OSCULATI

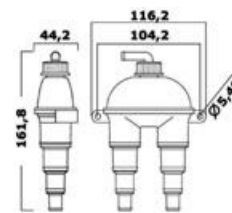

CENTEK mufflers

Vernatone CENTEK

Made of fiberglass.
Use: inboard engines
Application: above the waterline.

Code	A mm	B mm	C mm	D mm	Max power	
					gasoline	diesel
51.379.01	76	180	511	89	160	60
51.379.02	102	230	648	89	280	125
51.379.03	127	279	984	112	370	210
51.379.04	152	310	1054	127	440	280
51.379.05	203	412	1340	152	-	420

Two mufflers are required for "V" engines; in this case divide the engine power by two. Application: above floating line.

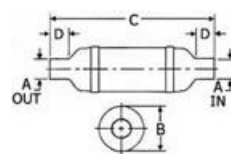

Vernalift In Line CENTEK

Made of fiberglass.
Use: inboard engines, sail, generators. **Application:** above or under the waterline.

Code	A 1/2 mm	B mm	C mm	D mm	E mm	Max power	
						petrol	diesel
51.378.01	40	50	267	162	124	30	10
51.378.02	50	50	267	162	124	60	25
51.378.03	60	60	356	212	157	90	35

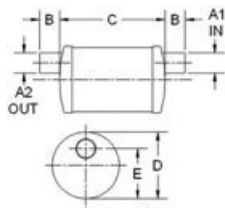

Vernalift Top CENTEK

Made of fiberglass.
Use: inboard engines, sail, generators. **Application:** above or below the waterline.

Loading above		A mm	B mm	C mm	D mm	Max power	
unloading lateral	loading above					HP gasoline	diesel
51.159.01	51.158.01	40	40	178	203	35	15
51.159.02	51.158.02	50	50	229	203	50	20
51.159.03	51.158.03	63	63	229	203	100	30
51.159.04	51.158.04	76	76	267	258	150	50
51.159.05	51.158.05	90	90	305	305	200	75

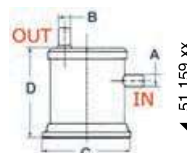
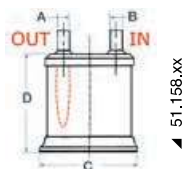

Exhaust pipes



Exhaust pipe scuppers

Made of **neoprene and stainless steel**, universal size, anti-vibration, rust-proof.

Code	Ø mm
51.381.01	40
51.381.02	50/60
51.381.03	75/90



Exhaust protection valves

Made of **rubber**, fitted with **stainless steel** clamp, for mounting on the exhaust terminals in order to avoid water from returning in case of quick shut down, **sold in pairs**.

Code	Type	Maximum Ø mm
51.381.99	2"	52
51.382.00	3"	75
51.382.01	4"	100
51.382.02	6"	150

OSCOLATI



Exhaust pipe scuppers fitted with anti-backflow check valve

AISI 316 Made of **mirror polished AISI 316 stainless steel**, fitted with rubber anti-backflow check valve. Fastening with 4 folding studs 6mm-Ø.

Code	Ø pipe mm	Ø flange mm	Ø net opening mm	Neck length mm
51.384.01	40	75	35	75
51.384.02	45	75	40	75
51.384.03	50	100	45	80
51.384.04	60	100	55	80
51.384.06	75	131	67	100
51.384.07	90	131	73	110
51.384.08	100	182	90	120
51.384.09	110	182	100	120
51.384.10	125	182	113	140

OSCOLATI

Polished AISI316 stainless steel finish ring



Technopolymer and stainless steel exhaust pipe scuppers with check valve

Made of reinforced technopolymer with polished AISI304 stainless steel finish ring. Hidden screws. Easy mounting. Stainless steel full design.

Code	For hose Ø mm	mm				
		A	B	C	D	E
51.386.01	40	41	60	30	85	65
51.386.02	45	46	60	30	85	65
51.386.03	50	51	60	30	85	65
51.386.04	60	61	90	35	110	89,5
51.386.06	75	76	90	35	110	89,5
51.386.07	90	91	90	45	138	116
51.386.08	100	101	90	45	138	116
51.386.09	110	111	110	50	165	141
51.386.10	125	126	110	50	165	141

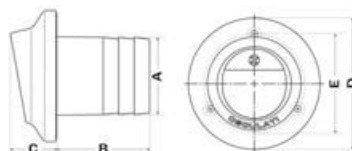

Supports and pipes

Pipes for exhaust systems

Made of **rubber**, type-approved by **RINA and LLOYD**, the pipes are fitted with a black smooth rubber substructure, high-resistance synthetic fabrics and built-in metal spirals, coating made with fire-proof black rubber, resistant to oil products, salt water, atmospheric agents and abrasion.

Code	Type	↔ mm	Curve radius mm	Roll m	Code	Type	↔ mm	Curve radius mm	Roll m
51.652.30	smooth	30x39	90	20	51.653.13	corrugated	130x143	260	10
51.652.35	smooth	35x44	105	20	51.653.15	corrugated	152x168	305	10
51.652.40	smooth	40x50	120	20	51.653.20	corrugated	200x220	815	10
51.652.45	smooth	45x55	135	20	51.653.40	corrugated	40x48	40	20
51.652.50	smooth	50,5x61	150	20	51.653.45	corrugated	45x53	45	20
51.652.60	smooth	60x70	180	20	51.653.50	corrugated	51x61	51	20
51.653.10	corrugated	101x113	152	10	51.653.60	corrugated	60x70	60	20
51.653.11	corrugated	110x123	220	10	51.653.75	corrugated	76x85	76	10
51.653.12	corrugated	125x136	255	10	51.653.90	corrugated	90x103	90	10

Pipes are sold **only** with standard sizes.



▲ 51.652.xx



▲ 51.653.xx

Elastic anti-vibration supports for inboard engines and generators, including counter-pads.

High-quality NBR rubber; shore hardness 55 +/- 3, female hole; available in **galvanized steel** or in **stainless steel**.

Stainless steel	Galvanized steel	Ø A mm	Ø E mm	Ø D mm	Ø H mm	Ø K mm	Ø L mm	S mm	Ø G mm (studs)	Max static nominal load kg	Studs*	
											code	↔ mm
-	51.656.01	62	25	8,2	30	78	100	2	10 MA	100	51.657.10	10x80
-	51.656.03	90	44	10,2	45	110	130	3	16 MA	350	51.657.16	16x120
51.655.02	51.656.02	62	25	8,2	30	78	100	2	10 MA	200	51.657.10	10x80
51.655.04	51.656.04	90	44	10,2	42	100	130	3	16 MA	350	51.657.16	16x120
51.655.07	51.656.07	115	61	16,2	46	142	190	4	18 MA	600	51.657.18	18x150

Apply an indicative 30% reduction for dynamic loads.

* In stainless steel, with 3 nuts for anti-vibration.

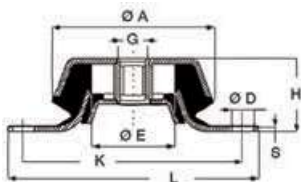

▲ 51.656.02 + 40.142.11



▲ 51.656.07

