

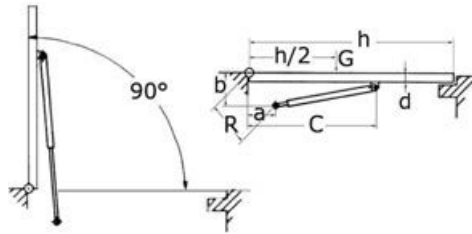

Gas springs for hatches, engine rooms etc.



Formula to choose the correct gas spring: you have to calculate the reaction value needed to open the pick using the following formula: $VR = (G \times h/2) / R$ where G is the hatch weight in kg - h/2 is the hatch thickness in centimeters divided by two and R is the shortest distance in centimeters between the rod fixing point and the rotation centre.

OSCULATI



Painted steel gas springs eye - eye

Made with chromed steel rod and epoxy-powder painted body.
Resistant to the marine environment.

Code	Open mm	Stroke mm	Response kg	Ø body mm	Ø rod mm
38.004.00	244	88	5	15	6
38.005.00	244	88	9	15	6
38.006.00	244	88	18	15	6
38.014.00	355	130	11	19	8
38.015.00	355	130	18	19	8
38.015.02	355	130	25	19	8
38.015.01	355	130	35	19	8
38.013.91	550	229	8	19	8
38.013.90	550	229	12	19	8
38.014.15	550	229	15	19	8
38.014.01	550	229	20	19	8
38.014.02	550	229	29	19	8
38.018.99	550	229	38	19	8
38.011.10	600	255	20	19	8
38.011.28	600	255	28	19	8
38.017.26	600	255	36	19	8
38.017.42	600	255	42	19	8
38.016.00	700	300	25	22	10
38.016.01	700	300	42	22	10
38.016.02	700	300	55	22	10
38.018.01*	850	360	50	27	10
38.018.02*	950	400	70	27	10

* Requires fixing plates: product numbers 38.012.99; 38.013.03

Painted steel gas springs eye - ball

Made with chromed steel rod and epoxy-powder painted body.
Resistant to the marine environment.

Code	Open mm	Stroke mm	Response kg	Ø body mm	Ø rod mm	Ø ball mm
38.115.00	355	130	18	19	8	10
38.114.01	550	229	20	19	8	10
38.118.99	550	229	38	19	8	10
38.117.26	600	255	36	19	8	10



Stainless steel gas springs eye – eye

AISI 316 fitted with eye terminals with hole size 8 mm.

Code	Open mm	Stroke mm	Response kg	Body mm	Rod Ø mm	
38.009.00*	250	90	5	15	6	
38.009.01*	250	90	10	15	6	
38.009.03*	250	90	18	15	6	
38.009.40	250	90	30	15	6	
38.009.04*	355	130	12	18	8	
38.009.05*	355	130	18	18	8	
38.009.06*	355	130	24	18	8	
38.009.07*	355	130	30	18	8	
38.009.41	432	170	15	18	8	
38.009.42	432	170	25	18	8	
38.009.43	432	170	35	18	8	
38.009.44	432	170	45	18	8	
38.009.09*	500	210	14	18	8	
38.009.11*	500	210	20	18	8	
38.009.12*	500	210	30	18	8	
38.009.15*	500	210	40	18	8	
38.009.16*	500	210	50	18	8	
38.009.17*	600	255	20	18	8	
38.009.18*	600	255	30	18	8	
38.009.19*	600	255	40	18	8	
38.009.20*	600	255	50	18	8	
38.009.23	700	300	25	22	10	
38.009.24	700	300	35	22	10	
38.009.25	700	300	45	22	10	
38.009.26	700	300	55	22	10	
38.009.30	New	700	300	65	22	10
38.009.31	New	700	300	85	22	10
38.009.27		900	380	45	22	10
38.009.29		900	380	60	22	10
38.009.32	New	900	380	75	22	10
38.009.33	New	900	380	90	22	10
38.009.34	New	700	300	100	28	14
38.009.35	New	700	300	150	28	14
38.009.36	New	950	400	100	28	14
38.009.37	New	950	400	150	28	14

OSCULATI



* 38.020.25 OPTIONAL: SS head, 10-mm Ø ball
38.009.99 Spare SS head

Stainless steel gas spring with ball head

AISI 316 Composite ball terminals.

Code	Open mm	Closed mm	Stroke mm	Response kg	Body Ø mm	Rod Ø mm	Requested ball Ø mm
38.020.31*	254	178	76	9	15	6	10
38.020.32*	254	178	76	14	15	6	10
38.020.35*	305	216	89	20	15	6	10
38.020.40*	380	240	140	12	18	8	10
38.020.41*	380	241	140	18	18	8	10
38.020.42*	380	241	140	26	18	8	10
38.020.43*	380	241	140	38	18	8	10
38.020.45*	500	295	205	20	18	8	10
38.020.46*	500	295	205	29	18	8	10
38.020.47*	500	295	205	38	18	8	10
38.020.48*	600	345	255	20	18	8	10
38.020.49*	600	345	255	30	18	8	10
38.020.50*	600	345	255	40	18	8	10
38.020.51	700	401	299	30	22	10	10
38.020.52	700	401	299	45	22	10	10
38.020.55**	922	536	386	60	22	10	10

OSCULATI



* 38.020.25; 38.012.00 OPTIONAL SS head, 10-mm Ø ball
** 38.020.55 OPTIONAL SS heads



Stainless steel gas spring eye – ALROSE eye

Fitted with eye terminals made of **stainless steel with 8-mm bore**. They match plates in our catalogue. Fitted with **air vent valves** that adapt the reaction load.

Code	Open length mm	Stroke mm	Reaction kg*		Body Ø mm	Rod Ø mm
			from	to		
38.020.03	355	130	10	40	18	8
38.020.07	500	200	10	50	18	8
38.020.09	600	255	10	50	18	8
38.020.11	730	315	20	70	23	10
38.020.14	950	400	20	200	28	14

* State the kg required reaction.



Eye-eye stainless steel gas spring with adjustable pressure setting

Fitted with **vent valve** for **perfect setting** of the elevated standard push-in force of the spring depending on the weight of the hatch/peak. Setting is possible only when fully extended. Fitted with stainless steel end eyelets, 8-mm Ø bore, and key for the vent valve.

Code	Open mm	Stroke mm	Basic push-in force kg	Body Ø mm	Rod Ø mm
38.010.00*	272	81	40	15	6
38.010.03*	377	132	70	18	8
38.010.07*	522	205	70	18	8
38.010.09*	622	255	70	18	8
38.010.11	752	315	120	23	10
38.010.14	972	415	160	28	14



* 38.020.25 OPTIONAL: SS head, 10-mm Ø ball

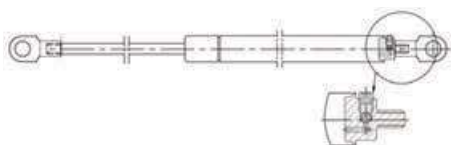

Safety automatic lock for gas springs

It automatically locks the spring at its maximum extension and releases it with a single movement. This safety device prevents hatches from closing unintentionally in case of rolling or pitching. AISI316 stainless steel body.

NB: 1) The addition of this lock increases the spring declared length by 25 mm.
2) In case of mounting in pairs, order extension 38,040,90.

Code	Matching springs	Spring characteristics		New length with lock mm	25-mm extension for second spring OPTIONAL
		Length mm	body Ø mm		
38.040.01	38.009.04/05/06/07; 38.020.03	355	18	380	38.040.90
38.040.03	38.020.45/46/47	500	18	525	38.040.90



Gas spring fixing plate and bases



fork base

AISI 316

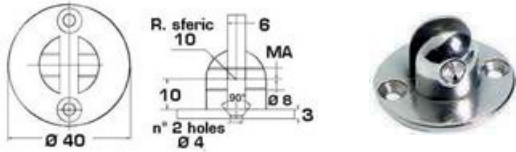

Code	Fork pin mm
38.013.66	6
38.013.68	8

Deluxe fork base

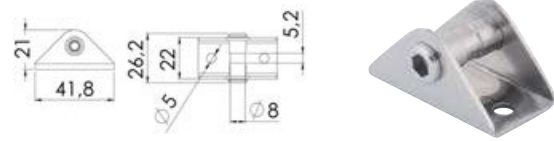

Code	Fork pin mm
38.013.27	8

Pin base

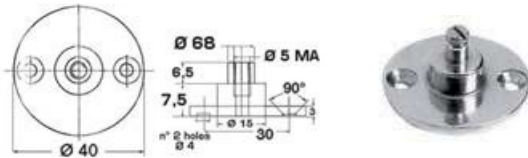

Code	Fork pin mm
38.013.56	6
38.013.58	8

Deluxe base with pin

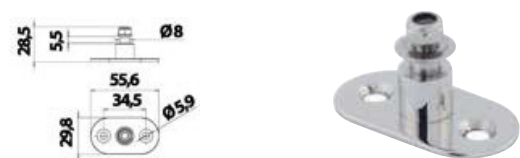

Code	Fork pin mm
38.013.28	8

Steel ball for snap mounting of gas springs

Code	Ball-Ø mm
38.012.00	10



Fastening plates, flat version

Code	A mm	B mm	Type	Version
38.013.00	60	50	standard	threaded pin 8 mm
38.013.40	60	50	standard	ball Ø 10 mm
38.012.99	60	50	standard	threaded pin 8 mm, length 23 mm, only for gas springs 38.018.01; 38.018.02
38.013.20	45	35	compact	threaded pin 8 mm
38.013.21	45	35	compact	ball Ø 10 mm

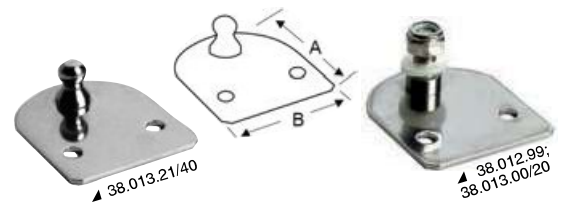

Flat fastening plates, 90° version

Code	A mm	B mm	C mm	Size	Version
38.013.01	30	50	30	Standard	External 8-mm threaded pin
38.013.02	30	50	30	Standard	Internal 8-mm threaded pin
38.013.41	30	50	30	Standard	External 10-mm Ø ball
38.013.42	30	50	30	Standard	Internal 10-mm Ø ball
38.013.03	30	50	30	Standard	External 8-mm threaded pin, 23-mm long, for 38.018.01/02
38.013.23	25	35	25	Compact	External 8-mm threaded pin
38.013.25	25	35	25	Compact	Internal 8-mm threaded pin
38.013.24	25	35	25	Compact	External 10-mm Ø ball
38.013.26	25	35	25	Compact	Internal 10-mm Ø ball



Fastening plates, embossed version

Code	A mm	B mm	C mm	Version
38.013.10	55	48	10 (overhang)	8-mm Ø threaded pin
38.013.11	55	48	10 (overhang)	10-mm Ø ball



Fastening plates, angle embossed version

Code	Version	Type
38.013.16	threaded pin 8 mm	left
38.013.17	threaded pin 8 mm	right

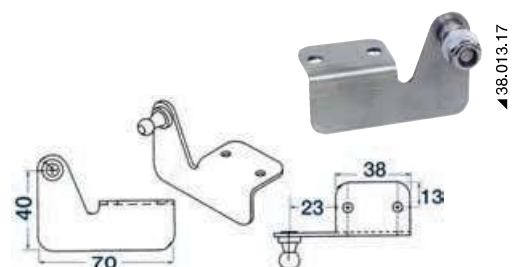

Powered Stays

LENCO



LENCO linear powered stay

Linear stay thrust: 225 kg.
60-cm cable with Deutsch plug.
Extension cables available (51.259.xx).
Stainless steel quick release plug.
It can work in pairs (use switch 38.376.02).
100% rustproof parts.
Friction system to prevent end-of-stroke burning (extended and retracted).
Current draw: 10A (12V), 5A (24V).

Code	Lenco code	Model	V	Total length when retracted (bracket to bracket) mm	Stroke mm	Total length when extended mm
38.374.64	20764-001	HL-800S	12	508	204	712
38.374.66	20766-001	HL-800	12	610	204	813
38.374.68	20768-001	HL-1200S	12	610	305	915
38.374.70*	20770-001	HL-1200	12	737	305	1042
38.374.74*	20774-001	HL-1600S	12	737	407	1143
38.374.76	20776-001	HL-1600	12	839	407	1245
38.374.78	20778-001	HL-2000S	12	839	508	1347
38.374.80	20780-001	HL-2000	12	940	508	1448
38.374.82	20782-001	HL-2400S	12	940	610	1550
38.374.84*	20784-001	HL-2400	12	1042	610	1651
38.374.86*	20786-001	HL-2600	12	1194	661	1855
38.375.65	20765-001	HL-800S/24V	24	508	204	712
38.375.69	20769-001	HL-1200S/24V	24	610	305	915
38.375.79*	20779-001	HL-2000S/24V	24	839	508	1347
38.375.83	20783-001	HL-2400S/24V	24	940	610	1550
38.375.87	20787-001	HL-2600S/24V	24	1194	661	1855

* Available only upon order

38.376.01 Switch for single jacks.

38.376.02 Switch to operate **two** actuators at the same time

38.376.06 OPTIONAL Bracket for emergency opening in case of current failure.

The housing can be lifted by 12.7 cm and the lock plug can be pulled out.

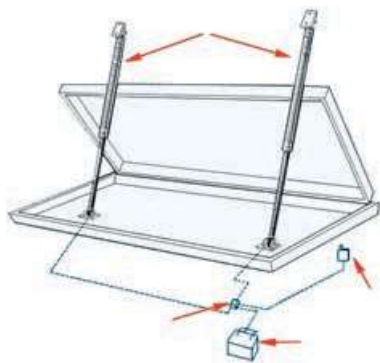

Powered stay for hatches type AV, designed for heavy loads

Body Ø 48 mm, maximum thrust for a single actuator: 120 kg; manual emergency opening, electronic system, if mounted in **pairs** or a **higher number** it balances the engine cycles to provide a synchronous lift, speed 17 mm/sec. **Aluminium** body and stainless steel telescopic stem, water resistant IP65; total or partial hatch opening in all desired positions.

Code	Single type	Double type	Travel mm	Thrust kg	Closed length mm	volt	Amp absorption
38.370.12	x	-	300	120	677	12	10
38.370.13	x	-	300	120	677	24	5
38.370.14	x	-	450	120	827	12	10
38.370.15	x	-	600	120	977	12	10
38.370.21	x	-	450	120	827	24	5
38.370.16	x	-	600	120	977	24	5
38.370.17	-	x	450	240	827	12	20
38.370.18	-	x	600	240	977	12	20
38.370.19	-	x	450	240	827	24	10
38.370.20	-	x	600	240	977	24	10



38.370.10/11 OPTIONAL relay box



Powered stay for hatches type model Ulysses designed for light loads

Electrical linear single mounting stay, 34-mm Ø body, 65-kg maximum thrust, absorption 2 A at 12 V, speed 4 mm/sec at 12 V, 6 mm/sec at 24 V. Fitted with **aluminium** body and stainless steel telescopic stem, water resistant IP65. Total or partial hatch opening in all desired positions. They cannot be mounted in pairs.

Code	Travel mm	Thrust kg	Closed length mm	volt
38.370.40	180	65	515	12
38.370.41	180	65	515	24
38.370.43	300	65	635	12
38.370.44	300	65	635	24



Relay boxes enable cycle inversion and synchronization

Code	Version
38.370.10	12 V (RB 12)
38.370.11	24 V (RB 24)

For switches with "O" in the middle and spring return, see the various models available on group 14 of this catalogue.

Lever latches

Anti-vibration peak latch

With eccentric lever lock, made of **elastic thermorubber**, fitted with mounting plate and **stainless steel** hook.

Code	Colour	mm					
		A	B	C	D	E	F
38.200.00	White	96/106	31	29	22	118	129
38.200.01	Black	96/106	31	29	22	118	129

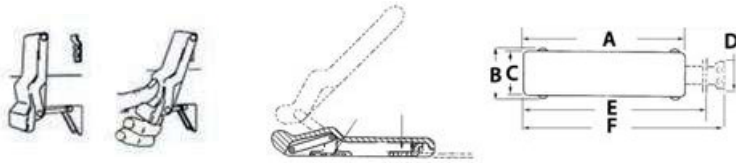

OSCULATI



Locker anti-vibrating lock with stainless steel cover

With eccentric lever lock. Made of elastic thermo-rubber with mirror-polished stainless steel front. 6-mm spring travel.

Code	mm				Padlock eyelet
	A	B	C	D	
38.200.10	95	19	30	12	No
38.200.11	95	19	30	12	Yes

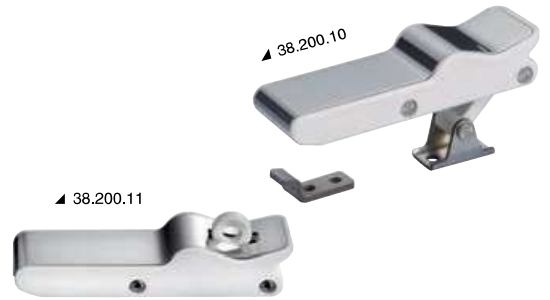
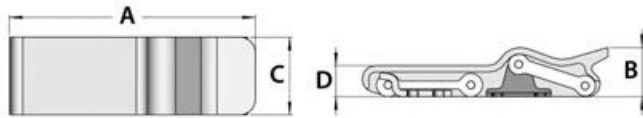

Locker latch

Made of technopolymer with padlock holder. Opening/closing fit with antivibration hidden snap spring.

Code	mm		
	A	B	C
38.208.50	111	40	17.5

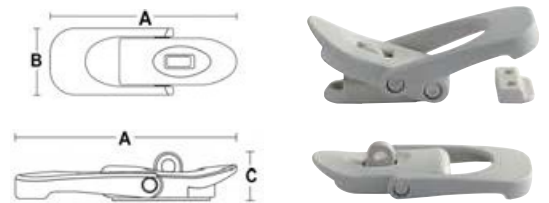

Stainless steel toggle fastener suitable for trunks and hatches

3.2-mm Ø fastening bores.

Code	Version	Length mm	Max pull kg	Max load kg
38.203.00	Standard	102	150	55
38.203.01	With padlock holder	102	150	55

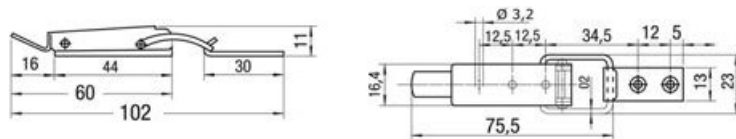

Stainless steel toggle fastener lockable



Code	Length mm	max traction kg	Max load kg
38.206.01	113	250	100

Locking with adjustable stainless steel lever

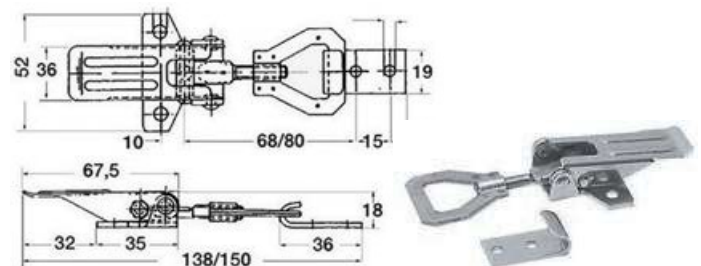

High strength model.

Code	Max working load kg	Max tension load kg
38.210.00	110	250



Adjustable faired lever latch

Made of stainless steel. Fitted with padlock ring.

Code	External fairing	Adjustable part	Size
38.241.00	70x25 mm	60x70 mm	18 mm

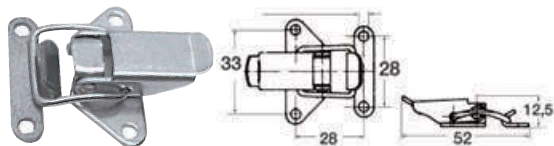

Stainless steel toggle fastener suitable for trunks and hatches

Code	Length mm	Max traction kg	Max load kg
38.204.00	52	150	100

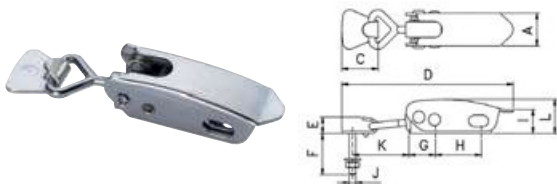

Elastic level lock

Made of polished stainless steel is equipped with padlock holder and has a internal compensating spring avoid all vibrations

Code	Length mm	A mm	C mm	D mm	E mm	F mm	G mm	H mm	I mm	J mm	K mm	L mm
38.207.01	106	20	22	104	10	25	16	28	15	M4	34	21



Peak toggle fastener fitted with padlock eye

Adjustable up to 12 mm, made of mirror polished stainless steel.

Code	Length mm	Width mm	Run mm
38.209.00	110 (total)	30	12

OSCULATI



Toggle fastener SLIM series

AISI 316

Fitted with padlock eye; adjustable length; made of mirror polished AISI 316 stainless steel.

Code	Total length mm	Width mm	Size mm	Adjustable travel
38.208.01	82	20	18,8	4,5
38.208.02	115	30	16,5	13



OSCULATI



RIVIERA lever latch

AISI 316

38.212.00 Made of polished stainless steel. Ready for locking with a padlock.



OSCULATI



New Stainless steel lever latch

Mirror-polished AISI316 stainless steel lever latch designed to be used for different applications and to close any peak.

The closing pin with eccentric hole can be rotated to reach the closing tension wished. Once installed, the device has a flush design with ergonomic handle for easier use. When open, the closing hook rotates at 180° and doesn't exceed the handle overall dimensions thus preventing to be hit by mistake. It includes a PVC template for easier installation.

Code	mm			Screw size
	A	B	C	
38.213.00	80	26	13	M4
38.213.01	100	32	16	M5

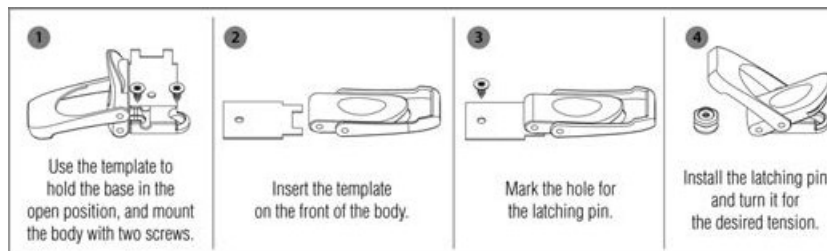

Adjustable stainless steel toggle fastener with padlock ring

Code	Length mm	Coupling mm	Padlock ring
38.904.10	from 75 to 90	18	Yes
38.904.12	from 100 to 125	25	No
38.904.11	from 123 to 137	29	Yes



▲ 38.904.10



Lock for hoods and hatches, 90° hook type, lightweight and sturdy

Locking for trunks, hatches, portholes, 90° coupling, light weight and sturdy.

Code	Material	mm
38.107.70	chromed brass	82x36x22

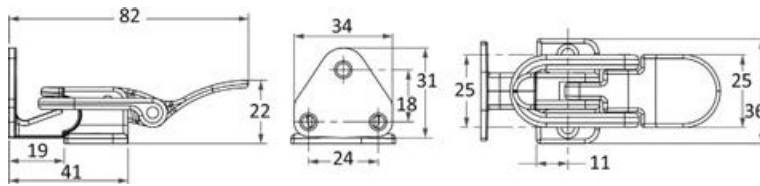

Lever latch with screw-covering hinge

Made of **chromed brass**, fitted with padlock holder, safety system with screws protected by the hinge.

Code	mm
38.195.00	82x30



Lever closures

Locker latch with padlock ring

Code	Material	A mm	B mm	C mm	L mm
38.107.30	Chromed brass	50	50	42	110
38.107.31	AISI 316 stainless steel	48	48	42	110
38.107.32	AISI 316 stainless steel	37	38	30	75

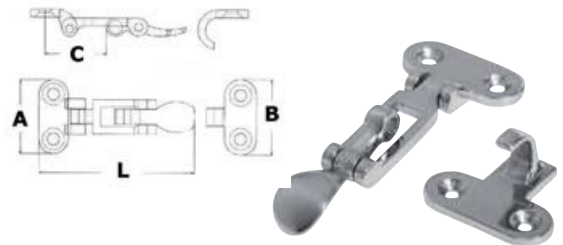

AISI316 lever fastener

AISI 316 Suitable for lockers. With eye for padlock

Code	Material
38.107.34	AISI 316 Stainless Steel

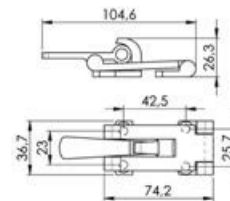

Hidden vertical lock

Ideal to lock and lift benches and outside kitchen furniture.

Code	Pin	Plastic handle
38.109.00	SS	Black
38.109.01	SS	White

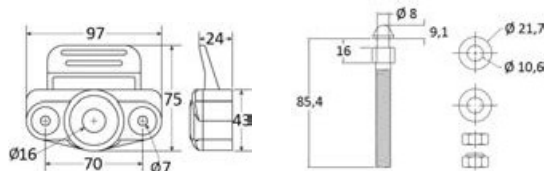

Hatch stays and brackets for lockers



Telescopic hatch adjuster, heavy duty

Code	Description	Range mm
38.191.40	chromed brass	320/500
38.191.41	chromed brass	360/640



Telescopic hatch adjuster

Code	Description	Range mm
38.191.50	Made of chromed brass. Very sturdy.	205/305



Extra-sturdy spring hatch stay

Made of **stainless steel**, fitted with spring hatch opening system, **supports heavy loads**, suitable for hatches and bilge peaks.

Code	Length mm	spring Ø mm	INCLUDED
38.421.67	350	22	2 fixing plates size 47x47 mm



Telescopic hatch stay

Made of **mirror polished stainless steel**, telescopic version with locking on each position by rotation the conical point.

Code	Adjustable mm
38.281.00	250/425
38.282.00	300/525



Spring hatch stay

Made of **stainless steel**, fitted with hatch opening spring, includes fork U-bolt and L shape plate. **Equipped with safety stainless steel cable to prevent the springs from stretching.**

Code	Terminal (1)	Terminal (2)	Length mm	Spring Ø mm	L mm	M mm	N mm	O mm	P mm
38.421.65	A	D	220	10,6	235	40	30	4,2	18
38.421.47	A	D	470	10,6	425	40	30	4,2	18
38.421.66	B	D	260	14	275	45	35	4,7	23
38.421.64	C	D	220	10,6	235	17	30	4,2	27
38.421.68	C	D	260	14,2	275	24	36	5,1	42

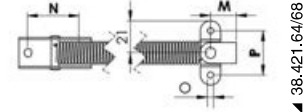
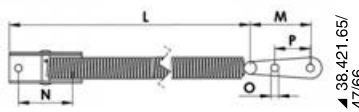

Mini gas spring

Made of **stainless steel**, designed to lift small hatches or kitchen furniture.

Code	Open size mm	Travel mm	Thrust kg
38.008,00	144	38	5

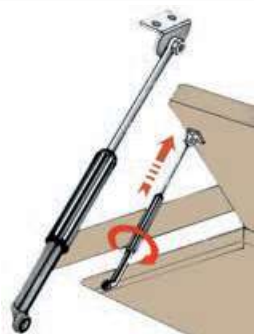

Telescopic hatch stay

Suitable for **nylon** portholes and hatches, fitted with **stainless steel** sliding rod; this special sliding system ensures an extraordinary locking and a remarkable travel at the same time.

Code	Travel mm
38.191.60	220/480

Ready to be used with plates 38.013.00; 38.013.01 included on the drawing..

38.013.00; 38.013.01 OPTIONAL Plates **sold separately.**

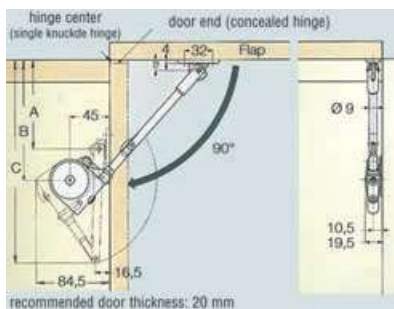

Soft Down Stay - upward window stay

Once the hatch is raised, the bracket keeps it under position, when is closed the bracket dampens the descending until the door is completely closed; colour: white, includes mounting plate, torsional moment calculation: **bracket**: door length (cm) x 1/2 x door weight (kg).

Code	For door	Mounting plate
48.610.00	90° opening	Included

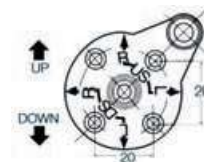

SUGATSUNE Soft Down Stay for opening downwards

Version with stopper. For doors **opening downwards**.
 Soft-opening door (right or left opening).
 The door has a **stopper** for **closed** position.
 Torque calculation, Arm: length of door (cm) x 1/2 x weight of door (kg).

Code	Colour	Torque
38.611.01	Black	0,49 - 1,18 N•m (5 - 12 kgf•cm)
38.611.02	White	0,49 - 1,18 N•m (5 - 12 kgf•cm)
38.611.03	Black	1,62 - 3,68 N•m (16,5 - 37,6 kgf•cm)
38.611.04	White	1,62 - 3,68 N•m (16,5 - 37,6 kgf•cm)



38.611.01/03

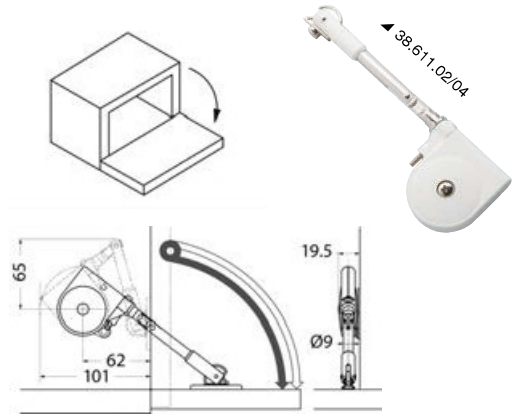

Self-supporting hinge

AISI 316
FRICION HINGE
 Made of precision-cast AISI 316 stainless steel.
 Constant torque: 30 kg/cm ± 15%.
 Example: 2 hinges hold a hatch 2-kg heavy and 40-cm deep.

Code	mm	Thickness mm
38.832.01	76x38	3,2

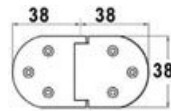

Self-supporting friction hinge

FRICION HINGE
 Constant torque: 55 kg/cm ± 15%.
 Example: 2 hinges can bear a 3,8-kg, 40-cm deep hatch.
 Made of AISI316 stainless steel.

Code	mm	Thickness mm	Pin Ø mm	Model
38.839.00	100x65	3	6	Overhanging pin
38.839.01	100x65	3	6	Reverse

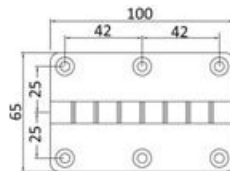

Hinges by the metre

Hinges - 2-m bars

Made of mirror polished stainless steel.

Code	Width mm	Thickness mm	Bore Ø mm	Bore pitch mm	Centre distance mm	Type	Material
38.999.01	30	0,8	3,3	60	16	With bores	AISI304
38.999.02	40	1,5	4,3	90	23	With bores	AISI304
38.999.03	50	1,5	4,3	90	28	With bores	AISI304
38.998.01	30	1	3,3	60	16	With bores and countersunk	AISI304
38.998.02	40	1,5	4,3	90	23	With bores and countersunk	AISI304
38.998.05	30	1,5	3,5	50	19	With bores and countersunk	AISI 316



Short piano hinge

It can be used as single or multiple to replace the piano hinge.

Code	mm	Ø thickness mm
38.997.01	50x150	1,5

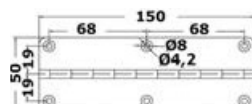

Hinges 0.8 mm thickness



0.8-mm hinges

Made of **polished stainless steel**, designed for hatches, small peaks.

Code	AxB mm
38.600.25	25x30
38.600.30	30x30
38.600.40	40x40

Hinges 1.2 mm thickness

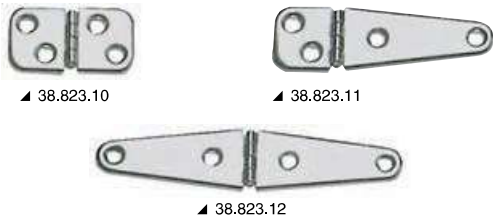

1.2-mm hinges

Made of pressed mirror polished **stainless steel**.

Code	mm
38.823.10	60x32
38.823.11	103x32 (asimetric)
38.823.12	145x32

Hinges 1,3 mm thickness

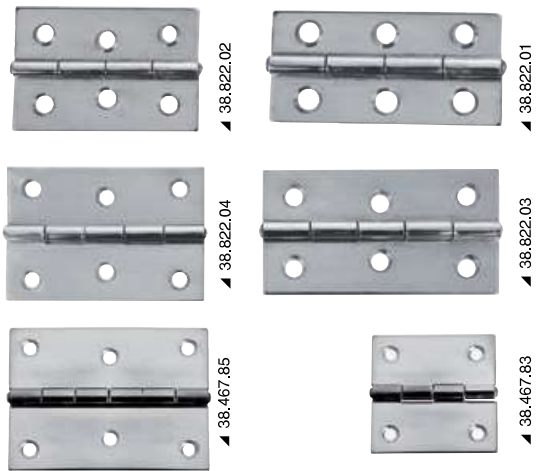

1.3-mm hinges

rectangular hinges made of mirror polished **stainless steel**

Code	AxB mm	Code	AxB mm
38.467.80	38x33	38.822.01	60x30
38.467.81	51x38	38.822.02	60x40
38.467.83	51x51	38.822.03	75x40
38.467.85	75x75	38.822.04	75x50



Hinges 1.5 mm thickness

1.5-mm hinges

AISI 316

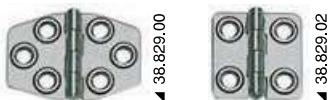

Pressed polished **AISI 316** stainless steel hinges, with relief flaring, screw holes 5 mm.

Code	mm
38.829.02	44x46
38.829.00	68x46

1.5-mm hinges

AISI 316



Pressed polished **AISI 316** stainless steel hinges, with relief flaring.

Code	mm
38.829.03	73x46
38.829.04	102x46

Hinge 2 mm thickness



Made of stainless steel.
Flush- or external-mount version.

Code	mm	Type
38.440.17	47x30	standard pin
38.440.07	47x30	reversed pin

Hinges 1.7 mm thickness

1.7-mm hinges

Made of **stainless steel without screws**, thickness of 1.7 mm, fitted with female bushing, threaded 4MA, welded under the hinge at the same position of the passing holes.

Code	mm	Shape	No. of bushings
38.821.01	51x38	Rectangular	4
38.821.02	51x45	Rectangular	4
38.821.05	51x38	Trapezoidal	6

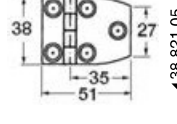
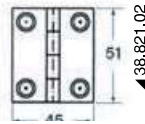
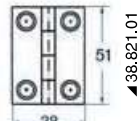

Low-cost 1.7-mm hinges

Low-cost version, made of **stainless steel**, electrolytically polished finish.

Code	mm
38.491.30	51,5x38
38.491.00	70x38



1.7-mm hinges

Made of modelled **mirror polished stainless steel**, thickness of 1.7 mm.

Code	mm
38.467.90	101x27
38.467.89	101x38



Hinges 2 mm thickness



2-mm hinges thickness

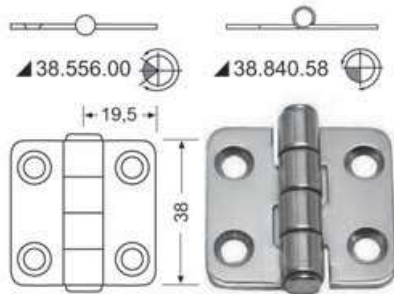

Made of mirror polished stainless steel. Vibration damping by means of a braked central axle.

Code	mm	Type
38.840.58	38x39	standard pin
38.556.00	38x39	central pin

Hinges 2 mm thickness

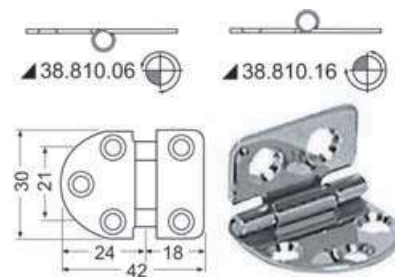

Made of mirror polished stainless steel. Vibration damping by means of a braked central axle.

Code	mm	Type
38.810.16	42x30	standard pin
38.810.06	42x30	reversed pin

Hinges 2 mm thickness

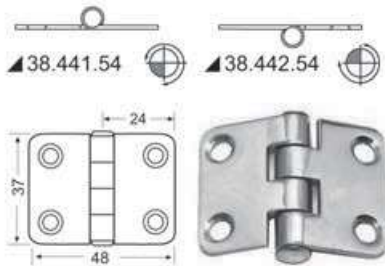

Made of mirror polished stainless steel. Vibration damping by means of a braked central axle.

Code	mm	Type
38.441.54	48x37	standard pin
38.442.54	48x37	reversed pin

2-mm hinges thickness

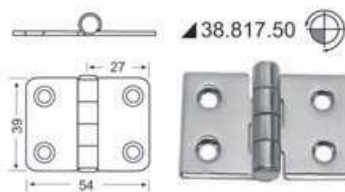

Made of mirror polished stainless steel. Vibration damping by means of a braked central axle.

Code	mm	Type
38.817.50	54x39	standard pin

Hinges 2 mm thickness

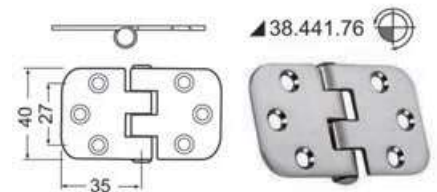

Made of mirror polished stainless steel. Vibration damping by means of a braked central axle.

Code	mm	Type
38.441.76	70x39	reversed pin

Hinges 2 mm thickness

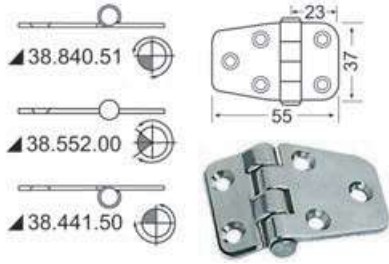

Made of mirror polished stainless steel.
Vibration damping by means of a braked central axle.

Code	mm	Type
38.840.51	55x37	standard pin
38.441.50	55x37	reversed pin
38.552.00	55x37	central pin

Hinges 2 mm thickness

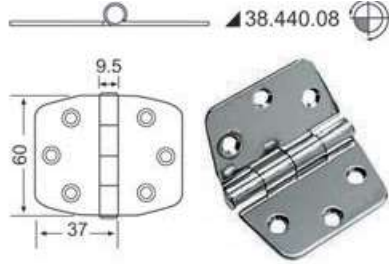

Made of mirror polished stainless steel.
Vibration damping by means of a braked central axle.

Code	mm	Type
38.440.08	74x60	standard pin

Hinges 2 mm thickness

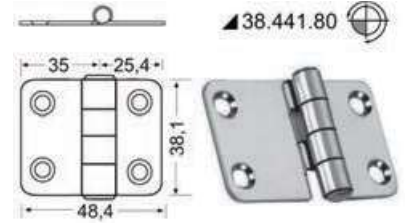

Made of mirror polished stainless steel.
Vibration damping by means of a braked central axle.

Code	mm	Type
38.441.80	60,4x38,1	standard pin

Hinges 2 mm thickness

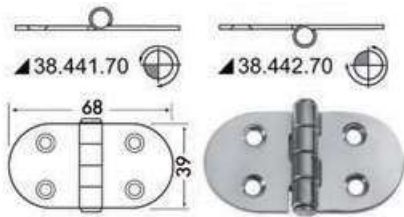

Made of mirror polished stainless steel.
Vibration damping by means of a braked central axle.

Code	mm	Type
38.441.70	68x39	standard pin
38.442.70	68x39	reversed pin

Hinges 2 mm thickness

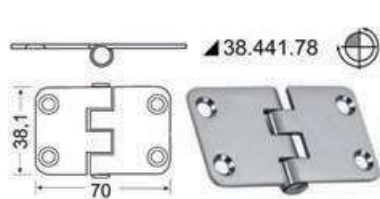

Made of mirror polished stainless steel.
Vibration damping by means of a braked central axle.

Code	mm	Type
38.441.78	70x38,1	reversed pin

Hinges 2 mm thickness

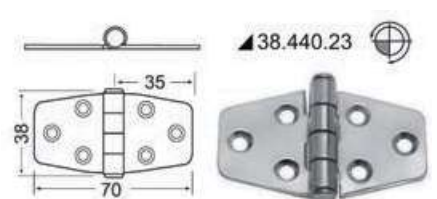

Made of mirror polished stainless steel.
Vibration damping by means of a braked central axle.

Code	mm	Type
38.440.23	68x42	standard pin

Hinges 2 mm thickness

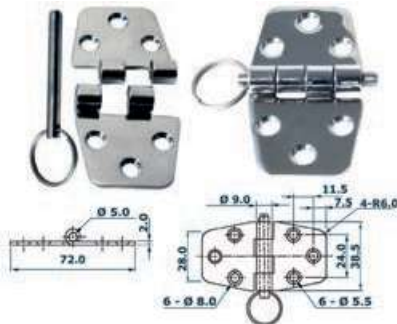

Made of mirror polished stainless steel.
Vibration damping by means of a braked central axle.

Code	mm	Type
38.441.51	72x38,5	standard pin

Hinges 2 mm thickness

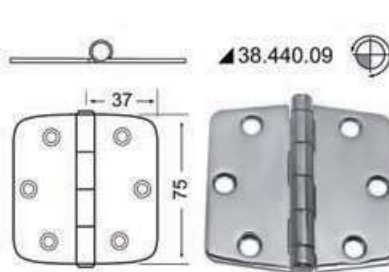

Made of mirror polished stainless steel.
Vibration damping by means of a braked central axle.

Code	mm	Type
38.440.09	74x75	standard pin

Hinges 2 mm thickness

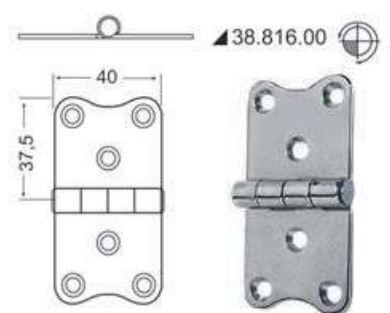

Made of mirror polished stainless steel.
Vibration damping by means of a braked central axle.

Code	mm	Type
38.816.00	75x40	standard pin

Hinges 2 mm thickness

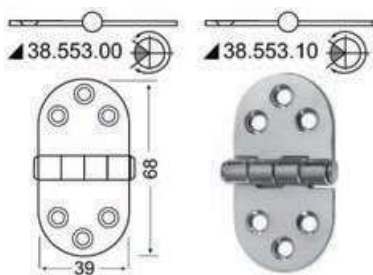

Made of mirror polished stainless steel.
Vibration damping by means of a braked central axle.

Code	mm	Model
38.553.00	68x39	Semi-recessed
38.553.10	76x38	Semi-recessed

Hinges 2 mm thickness

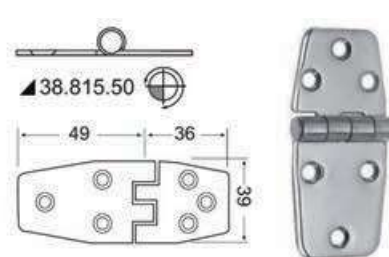

Made of mirror polished stainless steel.
Vibration damping by means of a braked central axle.

Code	mm	Type
38.815.50	85x39	standard pin

Hinges 2 mm thickness

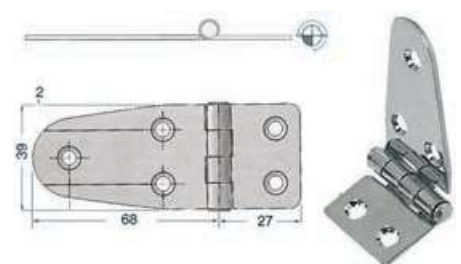

Made of mirror polished stainless steel.
Vibration damping by means of a braked central axle.

Code	mm	Type
38.217.40	95x39	standard pin

Hinges 2 mm thickness

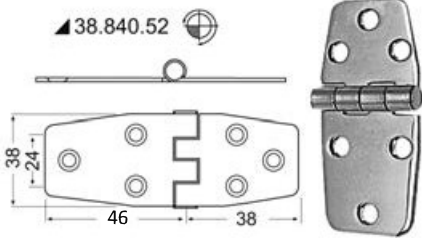

Made of mirror polished stainless steel.
Vibration damping by means of a braked central axle.

Code	mm	Type
38.840.52	84x38	standard pin

Hinges 2 mm thickness

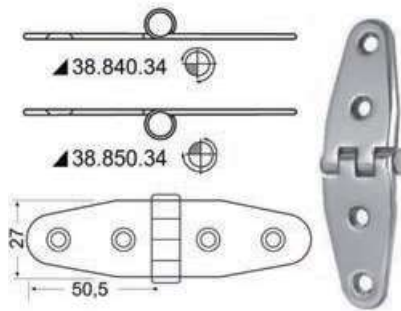

Made of mirror polished stainless steel.
Vibration damping by means of a braked central axle.

Code	mm	Type
38.840.34	101x27	standard pin
38.850.34	101x27	reversed pin

Hinges 2 mm thickness

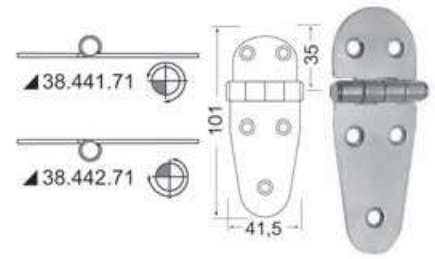

Made of mirror polished stainless steel.
Vibration damping by means of a braked central axle.

Code	mm	Type
38.441.71	101x41,5	standard pin
38.442.71	101x41,5	reversed pin

Hinges 2 mm thickness

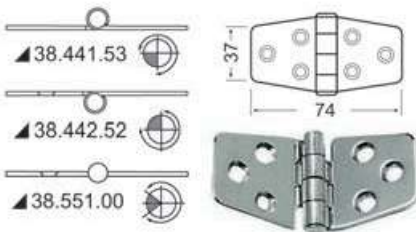

Made of mirror polished stainless steel.
Vibration damping by means of a braked central axle.

Code	mm	Type
38.441.53	74x37	standard pin
38.441.52	74x37	reversed pin
38.551.00	74x37	central pin

Hinges 2 mm thickness

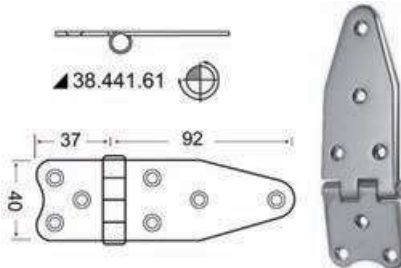

Made of mirror polished stainless steel.
Vibration damping by means of a braked central axle.

Code	mm	Type
38.441.61	129x40	reversed pin

Hinges 2 mm thickness

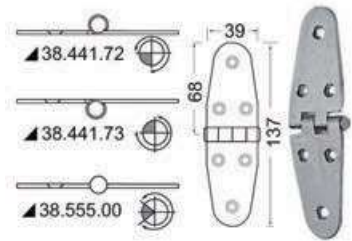

Made of mirror polished stainless steel.
Vibration damping by means of a braked central axle.

Code	mm	Type
38.441.72	137x39	standard pin
38.441.73	137x39	reversed pin
38.555.00	137x39	central pin

Hinges 2 mm thickness

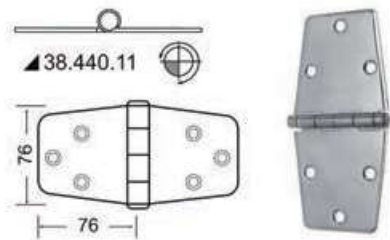

Made of mirror polished stainless steel.
Vibration damping by means of a braked central axle.

Code	mm	Type
38.440.11	152x76	standard pin

Hinges 2 mm thickness

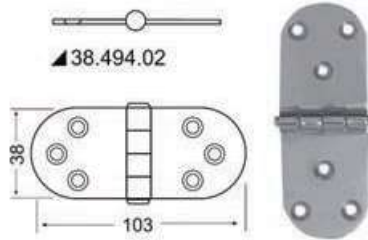

Made of mirror polished stainless steel.
Vibration damping by means of a braked central axle.

Code	mm	Model
38.494.02	103x38	standard pin

Hinges 2 mm thickness



Made of mirror polished stainless steel.
Vibration damping by means of a braked central axle.

Code	mm	version
38.441.69	65x40	standard pin

Hinges with studs

Made of mirror polished stainless steel, with hidden mounting system using 4-mm welded studs.
Vibration damping by means of a braked central axle.

Code	mm	Model	Stud length mm
38.441.68	68,5x38,5	standard pin	15 - 30
38.442.68	68,5x38,5	reversed pin	15 - 30

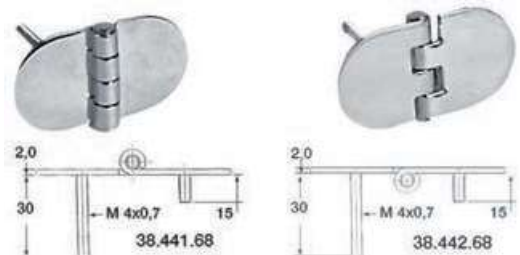
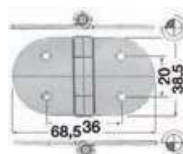



Hinges 2 mm thickness

Semi-embedded polished stainless steel hinge. Fitted with central oval bores to provide perfect centering. Designed for peak hinges. Vibration damping by means of a braked central axle.

Code	mm	Model
38.814.03	80x50	standard pin

AISI316 mirror polished stainless steel cover for hinges

Made of mirror polished stainless steel. Self-adhesive fastening, vibration damping by means of a braked central axle.

Code	Cover ref.	For hinge
38.441.10	1 pc for 1/2 hinge	38.441.70; 38.553.00
38.840.10	1 pc for 1/2 hinge	38.840.58; 38.556.00
38.551.10	1 pc for 1/2 hinge	38.441.53; 38.551.00
38.840.41	1 pair per hinge	38.840.51; 38.552.00
38.840.42	1 pair per hinge	38.440.09



Oval hinges

Oval hinges

Made of mirror polished stainless steel OVAL TYPE series; semi-embedded central axis; 270° opening.

mm	With semi-embedded knuckle and screw mounting	With overhanging knuckle	Thickness mm
35x51	38.450.01	-	1,5
48x67	38.450.02	-	2
56x78	38.450.03	-	2
78x56	-	38.451.01	2
78x56	38.450.53	-	3
84x56	38.452.01	-	2

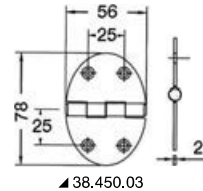
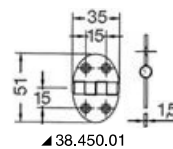
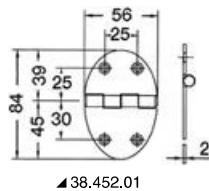
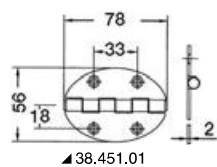
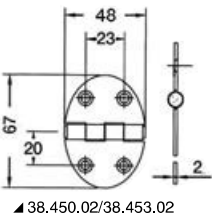

Overhang hinges 2 mm thickness

2-mm overhang hinges

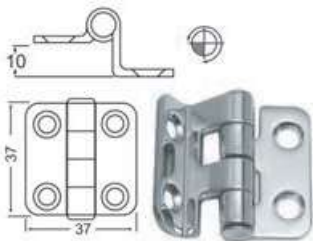

Made of mirror polished stainless steel. Vibration damping by means of a braked central axle.

Code	mm
38.441.59	37x37

2-mm overhang hinges

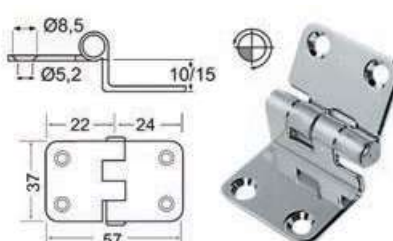

Made of mirror polished stainless steel. Vibration damping by means of a braked central axle.

Code	mm
38.441.55	57x37x10
38.441.56	57x37x15

2-mm overhang hinges

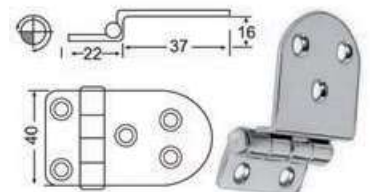

Made of mirror polished stainless steel. Vibration damping by means of a braked central axle.

Code	mm
38.441.58	59x40

2-mm overhang hinges

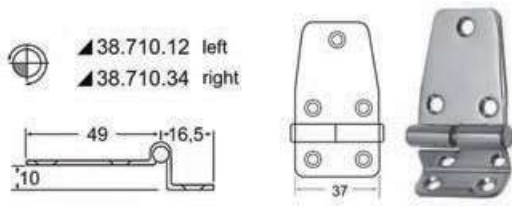

▲ 38.710.12 left
▲ 38.710.34 right

Made of mirror polished stainless steel.
Vibration damping by means of a braked central axle.

Code	mm
38.710.12	65,5x37
38.710.34	65,5x37

2-mm overhang hinges

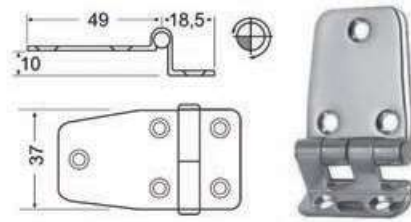

Made of mirror polished stainless steel.
Vibration damping by means of a braked central axle.

Code	mm
38.441.57	67,5x37

2-mm overhang hinges

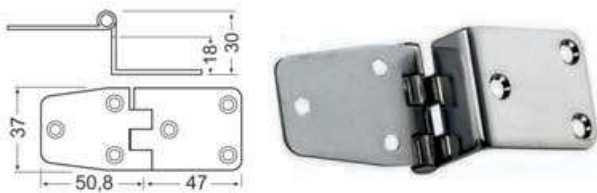

Made of mirror polished stainless steel.
Vibration damping by means of a braked central axle.

Code	mm
38.441.84	97,8x37

2-mm overhang hinges

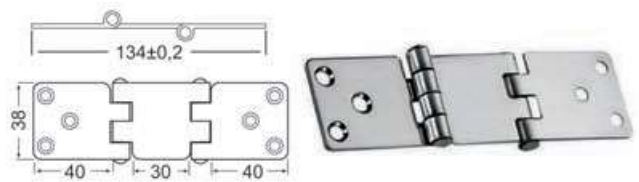

Made of mirror polished stainless steel.
Vibration damping by means of a braked central axle.

Code	mm
38.441.82	134x38

Hinges 2 mm thickness foldable

Hinges 2 mm foldable

Made of mirror polished stainless steel. Flush design for folding tables.
Fitted with precision-cast central unit.

Code	A mm	B mm
38.460.50	50	38
38.460.76	76	38
38.440.06	84	30

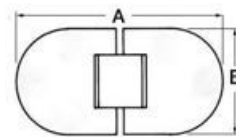

Hinges 2 mm foldable

Made of mirror polished stainless steel. Flush design for folding tables.
Fitted with precision-cast central unit.

Code	mm
38.460.79	68x42
38.460.78	70x40

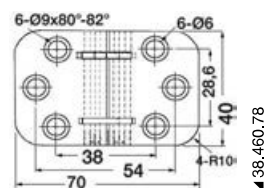
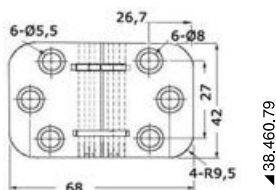

Hinges 2,5 mm thickness

Hinges 2,5 mm

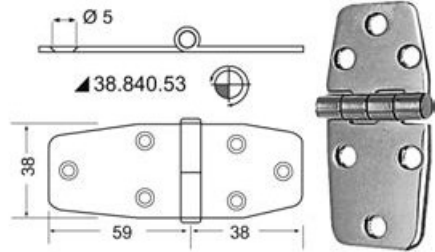

Code	mm	Type
38.840.53	97x38	standard pin

Hinges 2,5 mm

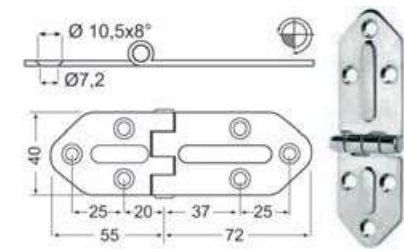

Code	mm	Type
38.444.00	127x40	standard pin

Hinges 2,5 mm

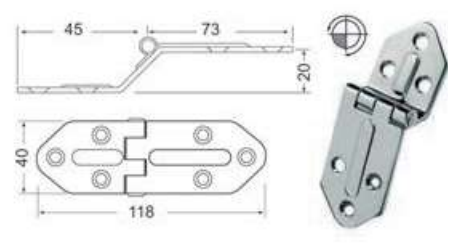

Code	mm	Type
38.445.05	118x40	standard pin

Hinges 2,5 mm

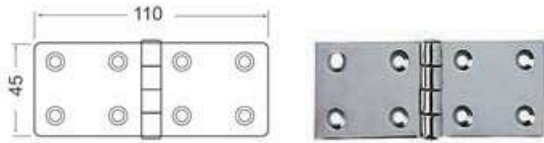

Code	mm
38.822.05	45x110

Hinges 2,5 mm

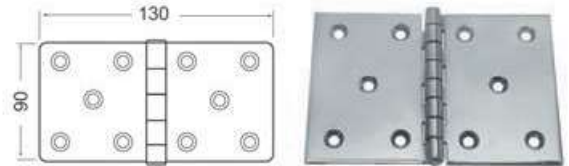

Code	mm
38.822.06	130x90

Special stainless steel extra strength hinges, mirror polished finish, suitable for engine trunks and heavy duty usage.

Hinges 3 mm thickness



Hinges 3 mm; HEAVY DUTY

Code	Model	mm	Thickness mm
38.455.01	reversed pin	110x60	3
38.455.02	reversed pin	130x60	3
38.455.03	reversed pin	160x60	3

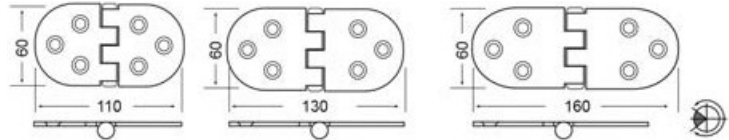

OSCOLATI



Foldable precision hinge, 180° rotation and screw cover

AISI 316 HIGH - PRECISION INVISIBLE SCREW

Made of mirror-polish AISI316 stainless steel. For tip-top tables or hatches. Fitted with screw cover to be fixed after mounting for neat design.

Code	mm	Thickness mm
38.292.00	110x42	3



180° rotation tip-top precision hinge

AISI 316

Made of mirror-polished AISI316L stainless steel. To be fixed to the edge of the table (19-mm thickness). Designed for as little clearance as possible for a stable tip-top table.

Code	mm
38.291.00	110x40

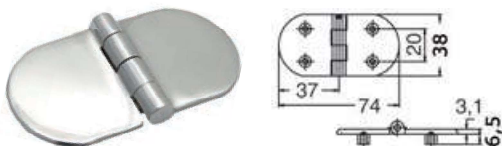

Precision-cast covered hinge

AISI 316

Mirror-polished AISI316 stainless steel hinge. Mounting from the lower side with 4 threaded bushings. SOFT seam friction, lids at both ends.

Code	mm
38.963.10	74x38

Hinges 4 mm thickness

Precision microcast hinges, 180° rotation

AISI 316 Mirror-polished AISI 316 stainless steel. Suitable for hatches and tilting tops.

Version with bores	Blind version with 5-mm studs (optional)	↔ mm	Thickness mm
38.290.01	38.290.10	80x30	3
38.290.02	38.290.20	100x40	4
-	38.290.30	140x70	2.8
38.460.75	38.460.77	140x70	2.8

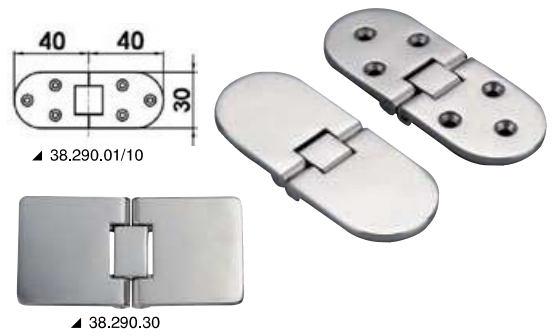
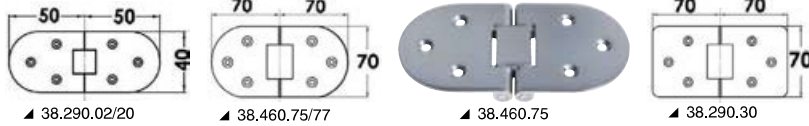

Hinges 4 mm

AISI 316 Precision-cast mirror-polished AISI316 stainless steel hinges, very sturdy. Ideal for engine trunks and cockpit floor opening (the 21x65-mm side has to be mounted vertically).

Code	↔ mm
38.863.25	72x65
38.863.26	103x65



Hinges 4 mm

AISI 316 Maxi hinges, made of mirror polished AISI 316 stainless steel, 8 mm pin.

Code	↔ mm
38.440.13	130x100
38.440.14	230x100
38.440.15	180x100

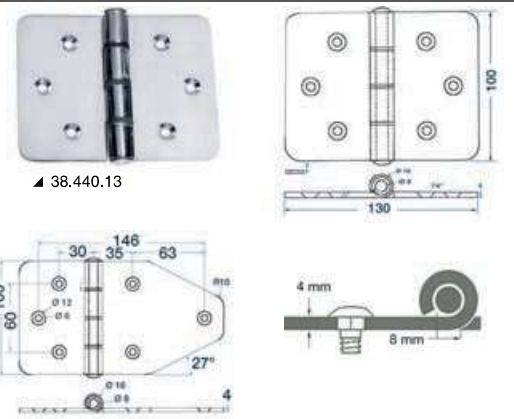
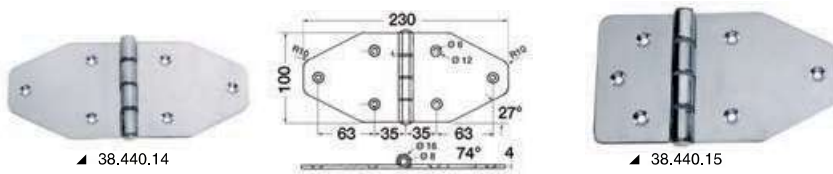

Hinges 5 mm thickness

Hinges 5 mm thickness

AISI 316 Cast mirror-polished AISI316 stainless steel hinges. Very sturdy, accurate finish.

Code	↔ mm	Pin	Thickness mm
38.285.00	38x72	protruding	5
38.280.00	38x100	protruding	5
38.283.00	38x38	protruding	5
38.284.00	50x50	protruding	5
38.287.00	38x74	flush	5
38.831.00	39x74	protruding	5
38.831.01	38x57	protruding	5
38.831.02	38x57	reversed	5



Hinges 5 mm thickness

Cast mirror-polished AISI316 stainless steel hinge designed for doors and removable trunks, high quality finish.

Code	↔ mm	Version
38.512.00	100x50	right
38.512.01	100x50	left



Hinges 5 mm thickness

Cast hinges "long wing" made of mirror polished stainless steel.

Code	Length mm
38.830.15	152x29



Stainless Steel hinges - Investment Cast

Mega precision-cast hinges

AISI 316

Made of **mirror polished AISI 316 stainless steel**; very sturdy, anti-friction nylon inserts.

Code	Shape	mm			Thickness mm
		A1	A2	B	
38.921.00	rectangular	38	38	76	3
38.921.01	rectangular	38	38	102	3
38.921.02	rectangular	51	51	102	3
38.921.03	rectangular	63	63	127	3
38.921.04	rectangular	76	76	152	4.8
38.921.10	rounded off	51	51	102	3.2
38.921.11	rounded off	63	63	127	3.2

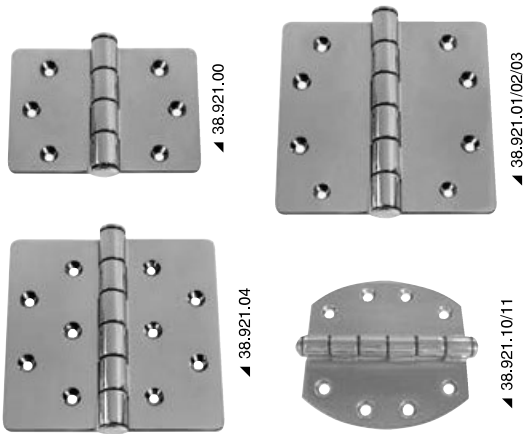
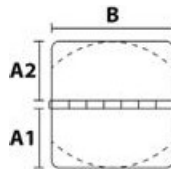

Precision-cast hinges

AISI 316

Made of **AISI 316 stainless steel**, high strength, fine design, mirror polished finish.

Code	Shape	mm	Thickness mm
38.923.00	trapezoidal	96x56	4
38.923.01	trapezoidal	62x37	3.5
38.922.06	rectangular	130x90	4



Precision-cast hinge

AISI 316

Made of very sturdy mirror-polished AISI316 stainless steel.

Code	Model	mm	Thickness mm
38.455.14	Rectangular	102x102	4
38.455.16	Trapezoidal	153x75	3.6

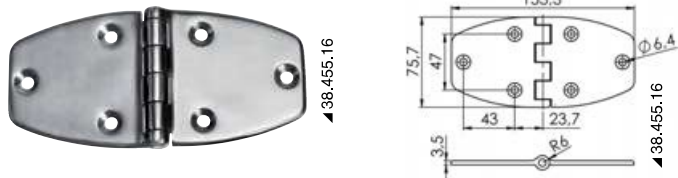
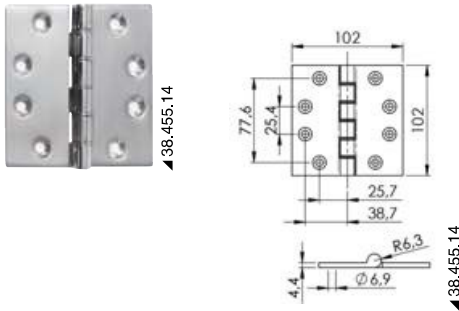

Hinges

AISI 316

Made of precision cast mirror polished **AISI316 stainless steel**, very sturdy, 4-mm thickness. Available versions: standard "A" version with 180° opening, or "B" version with overturned knot and completely smooth surface with 95° opening. Available in the following sizes.

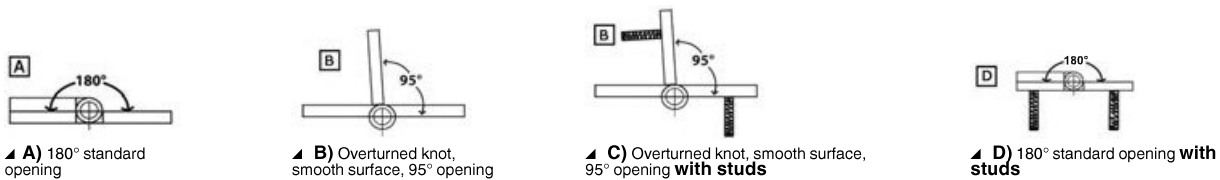

A	B	C	D	mm
38.963,18	38.863,18	38.873,18	38.883,18	66x66
38.963,19*	38.863,19	38.873,19	38.883,19	76x40

A	B	C	D	mm
38.963.20	38.863.20	38.873.20	-	65x65
			-	
38.963.21	38.863.21	38.873.21	-	83x65
			-	
38.963.22	38.863.22	38.873.22	-	145x65
			-	
38.963.23	38.863.23	-	-	128x65
		-	-	
38.963.24	38.863.24	38.873.24	-	190x65
			-	
38.963.30	38.863.30	38.873.30	38.883.30	70x40
38.963.31	38.863.31	38.873.31	-	63x40
			-	
38.963.32	38.863.32	38.873.32	38.883.32	126x40
38.963.33	38.863.33	-	-	116x40
		-	-	
38.963.40	38.863.40	38.873.40	-	141x29
			-	
-	-	38.873.50	-	160x70
-	-		-	

* 135° opening.



Hatch hinges

AISI 316 Made of mirror polished AISI 316 stainless steel.

Code	Size closed mm	Thickness mm	Wall mount mm	Door mount mm
38.926.01	45x30	10	25x30	20x30
38.926.00	57x30	10	26x30	30x30
38.926.02	70x30	10	39x30	31x30



OSCULATI

Hinge PIRAMID for hatches

AISI 316 Made of mirror polished AISI 316 stainless steel



Code	A x B mm	C mm	D x E mm	F x B mm
38.928.01	45x30	8,2	14x23	60x30
38.928.02	70x30	10	30x23	100x30
38.928.03	95x40	10	40x30	135x40



OSCULATI

Hinge for 90° Piramid doors

AISI 316 Mirror-polished AISI 316 stainless steel. Wall mounting.

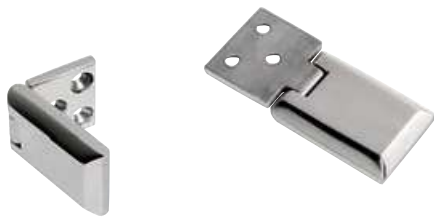

Code	A x B mm	C mm	D x E mm	F x B mm
38.929.01	43x30	8	25x30	68x30

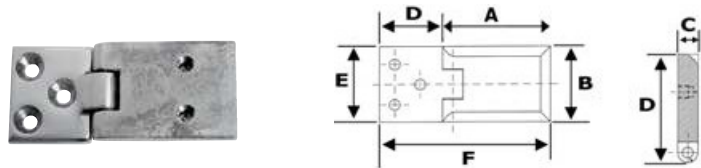

OSCULATI

Built-in hinge for hatches

AISI 316 Mirror-polished AISI 316 stainless steel.



Code	AxB mm	C mm	DxE mm	F mm
38.925.02	75x35	10	34x28	110
38.925.03	100x50	10	47x40	148

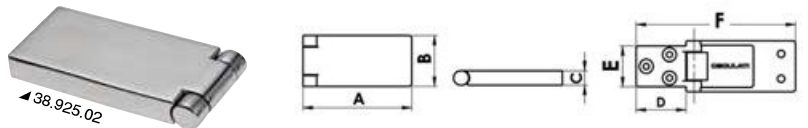

Hatch hinges

AISI 316 Made of mirror polished AISI 316 stainless steel.

Code	AxB mm	C mm	DxE mm	FxG mm
38.927.01	70x36	10	35x36	35x35
38.927.02	90x47	10	45x47	45x46

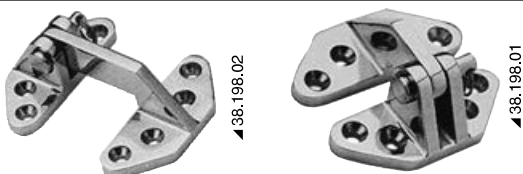
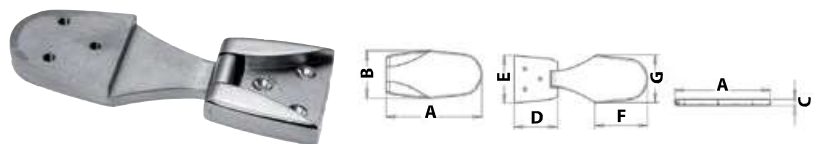

Hinges for hatches and engine boxes

AISI 316 Made of mirror polished AISI 316 stainless steel, fitted with removable pin.

Code	mm
38.198.01	67x73
38.198.02	88x73

Hinges for hatches

SUGATSUNE spring hinges for cabinet doors

Made completely of stainless steel; fitted with nylon cleat to adjust the step.

Code	Version	hinge over all mm	Surface plate, all out mm	For doors thickness mm
38.525.42	With half overlapping door on the frame (5-9 mm)	94x54	41x44	15/20
38.525.43	With total overlapping door on the frame (15-19 mm)	94x54	41x44	15/20



38.525.43

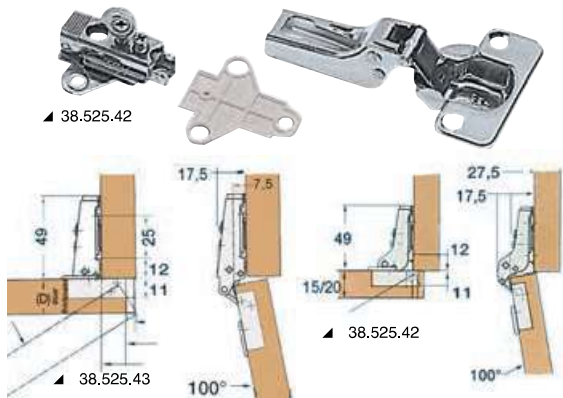

Spring hinges for Soft Close cabinet doors

SOFT CLOSE

Made completely of stainless steel. 105° opening. When exceeding 45° opening, the door stays open in any position. **Soft Close braked** closure. Fitted with click-in device for quick release of the hatch.

Code	Version	hinge over all mm	Surface plate, all out mm	For doors thickness mm
38.526.01	Full Overlay	110x64	47x54	14/24
38.526.02	Half Overlay	110x64	47x54	14/24
38.526.03	Inset	110x64	47x54	14/24

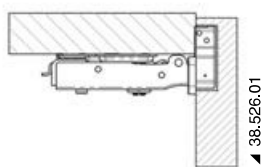

38.526.01

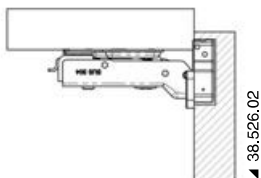

38.526.02

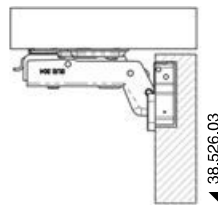

38.526.03

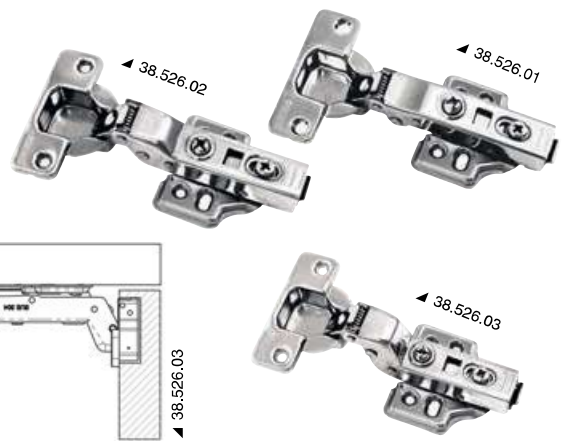

New

Spider hinge

AISI316

HEAVY DUTY

38.527.01 Polished AISI316 stainless steel spider hinge. Ideal for high-load hatches and pantograph opening systems up to 180°. Its dynamic geometry keeps the hinge far from the seal of the door or hatch.

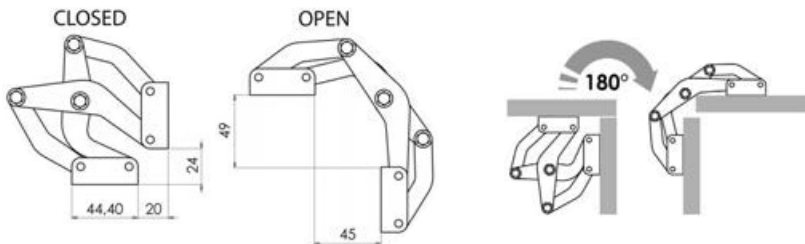

OSCOLATI



Video



Stainless steel hatch hinges

It is advisable to use stopper model 38.107.41 or similar models for locking.

Code	Type	mm	For hatches
71.607.00	with overhanged part of 10 mm	57x44	71.607.20; 71.607.22; 71.607.24; 71.607.26
71.607.01	no overhang	38x46	flat stop

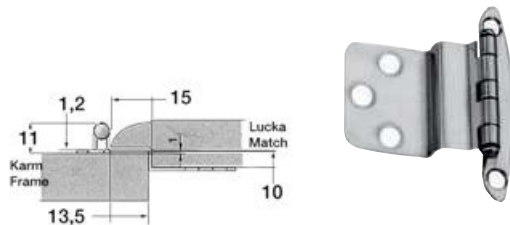
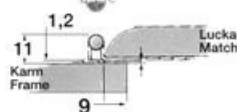

Eccentric hinges for long neck hatches

AISI 316

38.924.00 Made of mirror polished AISI 316 stainless steel.

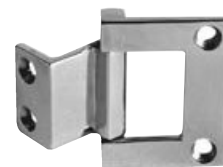
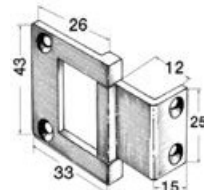

Brass hinges

Die-cast hinges



Made of **chromed brass**, designed for seats, hatches, doors etc. Very sturdy, 7-mm pin.

Code	mm
38.823.00	100x60

Hinges for ladders



Made of die-cast **chromed brass**, very sturdy.

Code	mm
38.825.00	145x20x15

Hatch hinge



Made of **chromed brass**.

Code	mm	stop mm
38.825.02	96x59x70	8

Hinge for hatch



Made of **chromed brass**, designed for hatch opening.

Code	Length mm	Height mm
38.825.01	110	40



Hidden-screw hinge

Made of **chromed brass**, no screws, mounting from underneath with studs.

Code	mm	Wings	Opening
38.819.01	65x55	unequal, for fixing onto the rope on the stop	190°

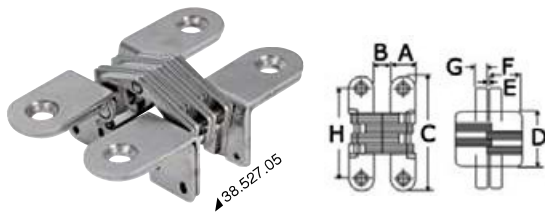

Hidden hinges for AISI 304 doors and hatches

Hinges for built-in doors, 180° opening. Satin finish.

Code	Bearable weight kg	A mm	B mm	C mm	D mm	E mm	F mm	G mm	H mm	ORDER BY BOX
38.527.03	7	12.4	11.5	44.5	12	0.5	16.7	1.5	32	2
38.527.04	10	13.3	9.5	53	16	0.5	18.5	2	40	2
38.527.05	20	15.7	10.5	69	21	0.8	19	3	52	2
38.527.06	30	18.5	14	84	28	0.8	24	4	64	2

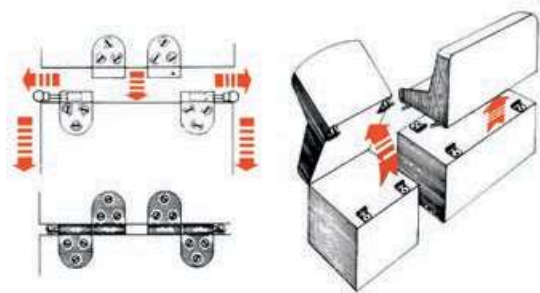

Hinges fitted with slip-off spring lock

38.983.00 Made of **chromed brass** with **stainless steel** pin and spring. Ideal for a fast removal of hatches, doors, seats, etc. without using any tools. Sold in pairs (right and left) two male parts + two female parts.



"Flush Deck" hinges for small hatches



No overhang part, made of **chromed brass**.

Code	mm
38.196.00	34x28

Ladder hinge with hook support



38.569.00 Made of **chromed brass**; fitted with snap-in safety to lock the ladder, **stainless steel** spring.

Ladder hook



38.570.00 Made of **chromed brass** and fitted with **chromed brass** support.

Plastic hinges

Hinges

Made of reinforced nylon.

white	Black	Length mm	Width mm
38.823.81	38.823.80	38	38
38.823.71	38.823.70	54	38
38.823.31	38.823.30	65	40
-	38.823.60	82	26
38.823.21	38.823.20	98	65



▲ 38.823.71



▲ 38.823.81



▲ 38.823.31



▲ 38.823.20



▲ 38.823.21



▲ 38.823.30



▲ 38.823.60



▲ 38.823.70



▲ 38.823.80

Hollow tile locks and closures

Hollow tile plate doorstop or cabinet doorstop

Made of chromed brass.

Code	mm
38.148.00	52x33

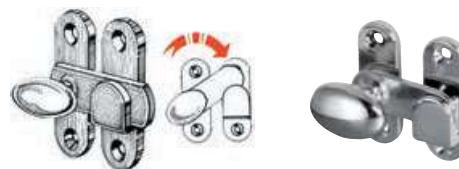

Hollow tile lock

Made of chromed brass, fitted with flush square and key, suitable for peaks and hatches.

Code	Hole part mm	Frame mm	Ring Ø mm
38.311.40	80x25	7x60	30



Cylinder locks with YALE key

Made of chromed brass and stainless steel; no iron or zamak parts; fitted with waterproof protection cap.

Code	Length (C) mm	Ø mm
38.131.80	15	20
38.131.81	20	20
38.131.82	25	20
38.131.83	30	20
38.131.84	35	20



Hollow lock

Made of chromed brass, 90° rotation.

Code	Neck Ø mm	Mounting useful length of neck mm	Lever pulling mm	Levers supplied	Watertight cap
38.310.00	20	14	12/33	2	Yes
38.310.01*	20	19	15/38	1	No

* Supplied without watertight protection cap.

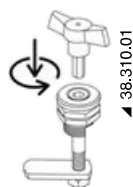

▲ 38.310.01

OSCULATI



▲ 38.310.01

▲ 38.310.00



Lever lock with key

Chromed brass, equipped with watertight protection cap, key and double lever, 90° rotation with anti-vibration internal spring.

Code	Neck Ø mm	Fitting length mm	Lever draft mm
38.310.50	20	10	13/35



Cylinder lock

90° rotation of the back latch by turning a knurled ring nut under the flange (loose rotation). Press the side button to **lock** the latch. Insert the key to **release** the latch. The advantage is that the lock can always be used without key. Supplied with 3 latches (16/20/25 mm) for different thickness. Made of **nickel-plated brass (springs included)**.

Code	Hole Ø mm	Thread length mm
38.131.70	16	16



Small rotating latch lock

Made of **nickel-plated brass**.

Code	Ø Hole mm	Thread length mm
38.131.65	16	16

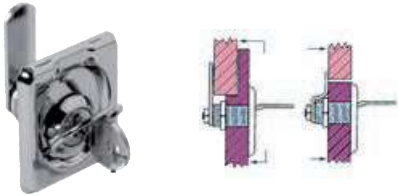

Swivelling lock for portholes and peaks

Made of mirror polished **stainless steel**, fitted with flush handle, fitted with stop lock.

Code	Ø hole mm	Frontale mm	thread length mm
38.977.00	16	50x55	20



Hasps and Staples

Locker latch

OSCULATI



38.405.50 Made of **stainless steel**, fitted with spring button and padlock ring hole plate.

Locker latch Deluxe

OSCULATI



38.405.51 Made of **stainless steel**, fitted with checking plate, **faired with hidden screws**.



Drop-down Hasp & Staple

AISI 316

Made of **precision cast AISI 316 stainless steel**, mirror polished, fitted with **swivelling padlock**.

Code	mm
38.932.80	75x26 (without strip), 90x26 (with strip)

Hasp & Staple

Made of **stainless steel**. Without screw strip cover.

Code	↔ mm
38.981.00	Closed 65x23

**Hasp & Staple**

Made of **chromed brass**; suitable for lockers, hatches and various uses, jointed to allow one section to work as a screw cover

Code	↔ mm
38.980.00	open 140x35

**Hasp & Staple**

Made of **chromed brass**, fitted padlock; suitable for trunks, hatches and various uses..

Code	↔ mm
38.980.01	95x25

**Heavy Duty hasp and staple**

Made of **mirror polished stainless steel**.

Code	Closed mm	Open mm
38.211.25	33x67	33x87
38.211.26	33x87	33x107

**Peak hasp**

Mirror-polished **stainless steel** with **swivelling** microcast eyelet.

Code	A mm	B mm	C mm	D mm
38.441.15	74	20	26x29	27

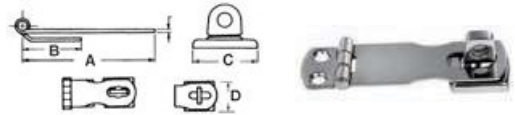
**Peak hasps**

Made of **stainless steel** with special "Chromelux[®]" mirror polished finish, fitted with **swivelling** padlock eye ring.

Code	A mm	B mm	C mm	D mm
38.441.12	64	29	32	24
38.441.13	91	29	32	24

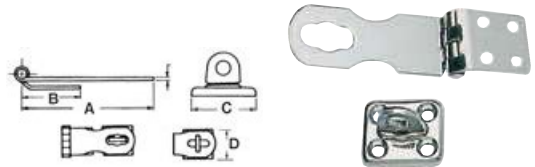
**Hasp & Staple**

Made of **chromed brass**, fitted with padlock ring, made exclusive by Osculati; through a clever system, the padlock ring can **swivel and fold**, in resting position it is **completely** aligned and does not disturb when is set on top, **universal** stud mounting.

Code	↔ mm
38.982.00	89x32

**Locking hasp & staple for lockers and hatches**

Made of **polished stainless steel**, fitted with lock and key.

Code	↔ mm
38.978.00	80x30 (closed)
38.978.01	105x30 (closed)



Lifting handles and lockers

Door stoppers/bottom boards stoppers



Made of mirror polished **stainless steel and nylon**.

Code	Ø mm
38.116.70	60

Wing nuts with supports



38.169.20 Porthole stopper or hatch stopper, all made of **chromed brass**.

Button plate

AISI 316



Made of **AISI 316 stainless steel**; designed to fix bottom boards or cabinet doors.

Code	Ø mm
38.145.00	45

Hatches stop



38.670.00 **stainless steel** mirroro polished



Bottom board lifting handle

Made of **AISI 316 stainless steel**.

Code	mm	Height mm	Wheelbase mm
38.158.00	88x35	20	73

Concealed bottom board



Made of **chromed brass**.

Code	mm
38.144.00	65x50

Bottom board raising device handle



Made of **chromed brass**.

Code	mm
38.141.00	75x55



▲ 38.143.20



▲ 38.141.21

Bottom board lifting ring

AISI 316

Made of **precision cast mirror polished AISI 316 stainless steel**.

Code	mm	Version
38.143.20	56x48	Heavy Duty, with ring
38.141.21	55x77	Heavy Duty, fitted with handle and return spring



▲ 38.510.33



▲ 38.510.34

Spring ring pull for floors

Code	mm	Material	Version
38.510.33	83x21	AISI 316 S.S.	with screws
38.510.34	83x21	chromed brass	with studs

OSCULATI



New

Delux pull handle

FLUSH

ERGONOMIC

38.511.00 Small stainless steel handle.

The rotary opening system provides a **large and ergonomic grip** in a reduced space. For recess-fit mounting. Fitted with anti-vibration closing system.

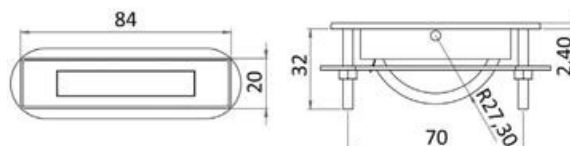

Chromed brass handles



Code	mm
38.107.60	50x75
38.107.61	60x90

Polished stainless steel handle



Code	mm
38.218.21	57x77

Bottom board lifting ring



Made of **stainless steel**, light and sturdy, mirror polished finish. Model fitted with ring return spring to eliminate vibrations.

Code	mm
38.142.00	55x65
38.142.01	38x40

Bottom board lifting ring



Made of **chromed brass**, foldable flush ring, also suited for hatch handles.

Code	mm
38.143.00	62x47 external

Cabinet lifting ring



Made of **chromed brass**, fitted with flush ring.

Code	Thread size mm
38.107.50	38x45

Anti-vibration cam latch

AISI 316 Mirror-polished AISI 316 stainless steel. Spring retractable handle, counterflange for fixing.

Code	External Ø mm	Bore Ø mm	Hatch thickness Ø mm
38.426.90	60	50	2/16



Eclipse anti-vibration pull latch

EXTRA LARGE HANDLE Featuring an extremely easy grip:
 - Mirror-polished AISI316 stainless steel.
 - Flush deck design.
 - Large ergonomic handle.
 - Spring retractable handle.
 - Plastic spacer with marks for customized cut.

Code	External Ø mm	Bore Ø mm	Hatch thickness Ø mm
38.164.00	60	50	0-24

OSCULATI

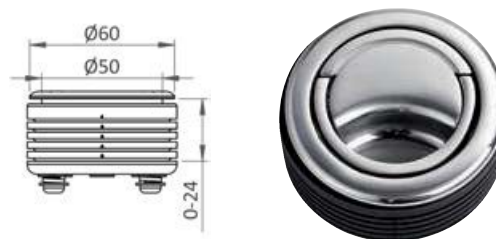

Flush crack



Made of **chromed brass**; lowered with spring, use for lockers and other uses.

Code	mm	Plate mm
38.131.40	57x40	18x40

Hatch or drawer stopper



Made of **chromed brass**, fitted with spring.

Code	mm	Plate mm
38.153.00	50x42	20x42

Flush bottom board pull latch

AISI 316 Made of **precision-cast mirror polished AISI 316 stainless steel**.

Code	mm
38.138.00	57x76



Push to close latches



Pull latches / hatch lifting device

Made of mirror polished **precision-cast AISI 316 stainless steel**; using a pressure lock, the handle can stay opened or closed.

Code	For hatches with thickness mm	Hole Ø mm	Flange Ø mm
38.147.50	3/19	51	62



▲ 38.147.00



▲ 38.147.01

Plastic flush pull latches

Made of **white nylon**, fitted with **stainless steel** lock stopper and two 2 mm stoppers.

Code	Version	Color	recess Ø size mm	external Ø size mm	Inner size mm	Fites thickness size mm
38.147.00	without lock	white	49,6	61,4	38,8	from 7 to 18
38.147.01	without lock	black	49,6	61,4	38,8	from 7 to 18
38.147.20	with lock	white	49,6	61,4	38,8	from 7 to 18
38.147.21	with lock	black	49,6	61,4	38,8	from 7 to 18



▲ 38.147.20



▲ 38.147.21

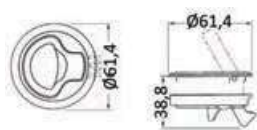

▲ 38.147.20



▲ 20.366.98

Lock for small hatches/flush pulls

AISI 316

Snap lock with spring handle. Mirror-polished AISI 316 stainless steel.

Code	Lock	For thickness mm	outside Ø mm	recess Ø mm	Depth mm
38.152.70	no	7 - 19	44	38	25,3
38.152.71	yes	7 - 19	44	38	25,3



20.366.98 Spare key for 38.152.71.



▲ 38.147.06



▲ 38.147.05



▲ Key for 38.147.06

Flush pull latches small

AISI 316

Made of **mirror-polished AISI 316 stainless steel**. Equipped with square stop.

Code	Lock	For thickness mm	External Ø mm	Recess Ø mm
38.147.05	No	5 - 12	62	48
38.147.06	Yes	5 - 12	62	48



▲ 38.147.06



▲ 38.147.05



▲ 38.147.06



▲ 38.152.05



▲ 38.152.08



▲ 20.366.98

Flush pull latch with spring handle and snap lock

Mirror polished AISI 316 stainless steel.

Code	Lock	For thickness mm	External Ø mm	Recess Ø mm	Version
38.152.05	No	5-12	62	50	Standard
38.152.06	Yes	5-12	62	50	Standard
38.152.08	Yes	5-12	62	50	Opening from inside and outside



20.366.98 Spare key for 38.152.06/08

Flush pull latches large

AISI 316 Snap lock with spring handle. Mirror-polished AISI 316 stainless steel.

Code	Lock	For thickness mm	outside Ø mm	recess Ø mm	Depth mm
38.152.80	no	7 - 19	75	63	40
38.152.81	yes	7 - 19	75	63	40

 **20.366.98** Spare key for 38.152.81.



Eclipse PUSH LOCK pull latch (push closure)

EXTRA LARGE HANDLE Featuring an extremely easy grip: - Mirror-polished AISI316 stainless steel. Flush deck design. Large ergonomic handle. Spring retractable handle. It opens from inside and outside.

Code	Lock	For thickness mm	External Ø mm	Recess Ø mm
38.163.01	No	9-19	60	50
38.163.02	Yes	9-19	60	50

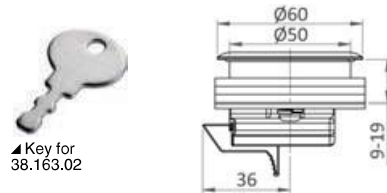

OSCULATI



Lift and turn latches

Lift and turn latch

Made of nylon + chromed brass; for mounting with 2 crews on boards, thickness of 6-16 mm, fitted with snap-in stopper.

Code	Size mm	Bottom board hole mm	Adjustable stop lever mm
38.137.00	63x63	50	27-50



Flush turn latch for winch handle

AISI 316 REGISTERED DESIGN / DISEGNO DEPOSITATO

Completely flush when not in use thanks to a spring system that closes the star hole, 90° rotation. Made of AISI 316 stainless steel.

Code	Outer Ø mm	Hole Ø mm	Bulkhead thickness mm	Stop stroke mm
38.165.01	51	42	4-26	32-130

 **38.152.78** OPTIONAL Pushbutton KEY



OSCULATI



Pull handle with pulling system

Made of **chromed brass**, recess fit, fitted with locking cover. Fitted with lower adjustable stopper height from 50 mm to 5 mm.

Code	Ø hole mm	Version	Adjustable stop lever mm
38.140.02	68	with key	38-58
38.140.03	68	without key	38-58



Lift and turn latch with compression system

Made of **mirror polished AISI 316 stainless steel**, fitted with counter stop plate; no visible screws; special **pulling** system which turns the handle to **completely lock** the bottom boards, thus avoiding vibrations, supplied with angled locking lever + straight lever + stop plate.

Code	Ø A mm	Ø B mm	C mm	D mm	E mm	L mm	H mm
38.426.80	70	60	30/80	78	2/42	71	22
38.426.86	90	70	30/80	88	2/49	71	22

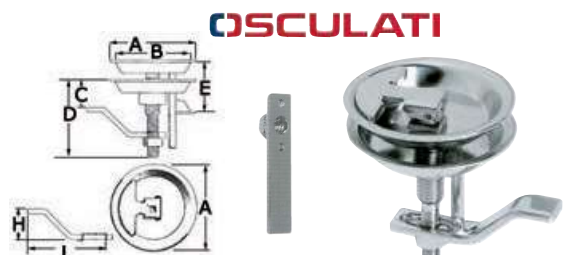

OSCULATI

**Lift and turn latch with cover****AISI 316**Made of **precision cast mirror polished AISI 316 stainless steel**; adjustable fixing board; built-in padlock ring.

Code	A mm	B mm	C mm	D mm	E mm	F mm	Base mm
38.151.00	115	120	92	52-65	11	75	110x115

OSCULATI**Lift and turn flush latch small****AISI 316**

Made of mirror polished AISI 316 stainless steel.

Code	Version	External Ø mm	Bulkhead hole Ø mm	Bulkhead thickness mm	Adjustable stop lever mm
38.152.01	without lock	60	51	4-19	35-90
38.152.02	with lock	60	51	4-19	35-90

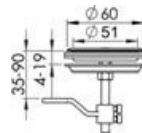
**OSCULATI****Lift and turn flush latch large****AISI 316**

Made of mirror polished AISI 316 stainless steel.

Code	Version	External Ø mm	Recess hole Ø mm	Bulkhead thickness mm	Adjustable stop lever mm
38.152.20	without lock	90	76	8-23	38-93
38.152.21	with lock	90	76	8-23	38-93

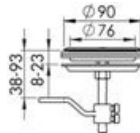
**OSCULATI****Cam Latch pull latch, 60 mm****AISI 316**Fitted with eccentric cam system, by **lowering the handle** it shifts the inner lock lever upwards, making a safer locking, watertight, no vibrations; by **lifting** the handle, the inner lever raises and frees the hatch; made of **AISI 316 stainless steel**, mirror polished finish.**COMPRESSION SYSTEM**

Code	Lock	External Ø mm	Bulkhead hole Ø mm	Bulkhead thickness mm	Adjustable stop lever mm
38.152.40	no	60	50	8-30	37-97
38.152.41	yes	60	50	8-30	37-97

20.366.98 Spare key for 38.152.41

OSCULATI**Cam Latch pull latch, 75 mm****AISI 316**Fitted with eccentric cam system, by **lowering the handle** it shifts the inner lock lever upwards, making a safer locking, watertight, no vibrations; by **lifting** the handle, the inner lever raises and frees the hatch; made of **AISI 316 stainless steel**, mirror polished finish.**COMPRESSION SYSTEM**

Code	Lock	outer Ø mm	bulkhead hole Ø mm	Bulkhead thickness mm	Stop stroke mm
38.152.50	no	75	60	8-20	20-99
38.152.51	yes	75	60	8-20	20-99

20.366.98 Spare key for 38.152.51.

OSCULATI**Cam Latch pull latch, 90 mm****AISI 316**Fitted with eccentric cam system, by **lowering the handle** it shifts the inner lock lever upwards, making a safer locking, watertight, no vibrations; by **lifting** the handle, the inner lever raises and frees the hatch; made of **AISI 316 stainless steel**, mirror polished finish.**COMPRESSION SYSTEM**

Code	Lock	External Ø mm	Bulkhead hole Ø mm	Bulkhead thickness mm	Adjustable stop lever mm
38.152.60	no	90	76	10-34	39-100
38.152.61	yes	90	76	10-34	39-100

20.366.98 Spare key for 38.152.61.

LIFT & TURN compression latch

38.161.XX - Characterized by a particularly easy grip, they enclose all the best features of the pull latches in a single model.

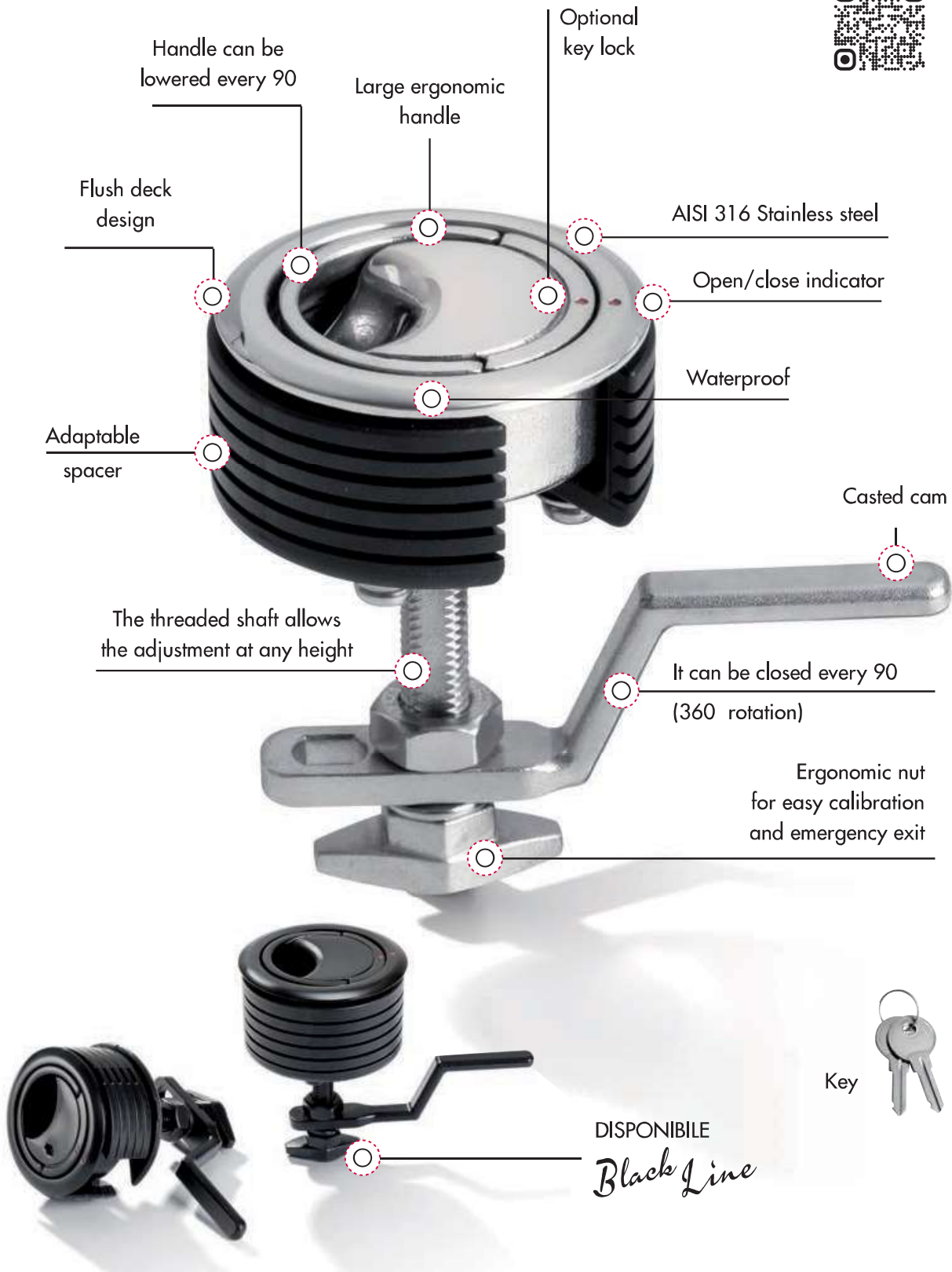



▲ 38.161.01

▲ 38.161.02



▲ 38.161.61

▲ 38.161.62



▲ Spacer included

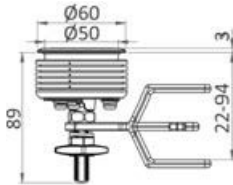

▲ Key for 38.161.02

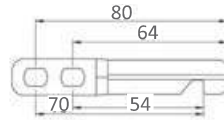

▲ Universal straight cam included

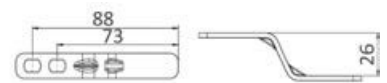

▲ Angled cam included

Eclipse LIFT & TURN flush latch (with compression closure) - SMALL

COMPRESSION SYSTEM

EXTRA LARGE HANDLE

Featuring a very comfortable grip, it offers all the best characteristics in a single flush deck design model.

- Flush design.
- Large ergonomic handle.
- 360° rotation.
- Handle can be lowered every 90°.
- Open/close indicator.
- Ergonomic nut for easy calibration and emergency exit.
- Straight cam suitable for sliding doors.
- Two-position cam.
- Plastic spacer with marks for customized cut.

Polished SS version	Black SS version	Lock	Outer Ø mm	Bore Ø mm	Bulkhead thickness mm	Stop stroke mm
38.161.01	38.161.61 New	No	60	50	3-26	22-94
38.161.02	38.161.62 New	Yes	60	50	3-26	22-94



▲ 38.161.32

▲ 38.161.31

▲ 38.161.71/72



▲ Spacer included

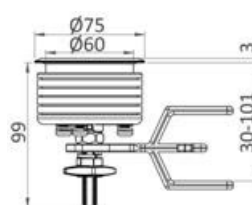

▲ Key for 38.161.32; 38.161.4x

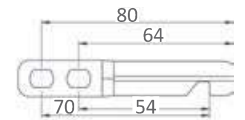

▲ Universal straight cam included

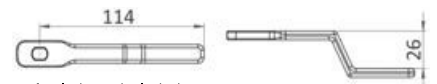

▲ Angled cam included

Eclipse LIFT & TURN flush latch (with compression closure) - MEDIUM

COMPRESSION SYSTEM

EXTRA LARGE HANDLE

Featuring a very comfortable grip, it offers all the best characteristics in a single flush deck design model.

- Flush design.
- Large ergonomic handle.
- 360° rotation.
- Handle can be lowered every 90°.
- Open/close indicator.
- Ergonomic nut for easy calibration.
- Ergonomic nut for emergency exit.
- Straight cam suitable for sliding doors and having two different positions.
- Two-position cam.
- Plastic spacer with marks for customized cut.

Polished SS version	Black SS version	Lock	Outer Ø mm	Bore Ø mm	Bulkhead thickness mm	Stop stroke mm	Kit	No. of latches per kit (same key)
38.161.31	38.161.71 New	No	75	60	5-36	30-101	No	-
38.161.32	38.161.72 New	Yes	75	60	5-36	30-101	No	-
38.161.42	-	Yes	75	60	5-36	30-101	Yes	2
38.161.43	-	Yes	75	60	5-36	30-101	Yes	3
38.161.44	-	Yes	75	60	5-36	30-101	Yes	4
38.161.45	-	Yes	75	60	5-36	30-101	Yes	5

Eclipse LIFT & TURN flush latch (with compression closure) - BIG

COMPRESSION SYSTEM **EXTRA LARGE HANDLE**

Featuring a very comfortable grip, it offers all the best characteristics in a single flush deck design model.

- Flush design.
- Large ergonomic handle.
- 360° rotation.
- Handle can be lowered every 90°.
- Open/close indicator.
- Ergonomic nut for easy calibration and emergency exit.
- Straight cam suitable for sliding doors and with two possible positions.
- Plastic modular spacer for different thickness bulkheads,

Code	Lock	Outer Ø mm	Bore Ø mm	Bulkhead thickness mm	Stop stroke mm
38.161.51	No	100	87	5,5-33	30-103

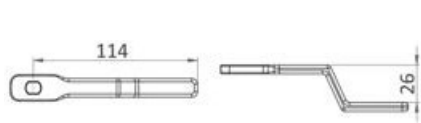

▲ Angled cam included



▲ Spacer included

OSCULATI

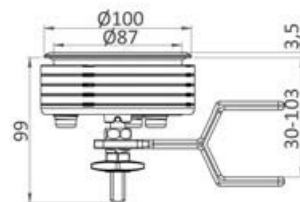

Spares for Eclipse lift and turn latch

Their different shapes easily fit multiple hatches or applications.

Code	Description	Compatible models
38.161.80	Cam/lever	38.161.01/02/31/32/42/43/44/45/51
38.161.81	Cam/lever	38.161.01/02
38.161.82	Cam/lever	38.161.31/32/42/43/44/45
38.161.90	Spacers	38.161.01/02; 38.162.00; 38.152.40
38.161.91	Spacers	38.161.31/32/42/43/44/45



▲ 38.161.80

▲ 38.161.81



▲ 38.161.90



▲ 38.161.82



▲ 38.161.91

Eclipse (medium) pull latch for Marinaio cabins or large lockers

OPENING FROM INSIDE **COMPRESSION SYSTEM**

Very comfortable grip, it encompasses all the best features of a flush deck pull latch. Internal handle for opening/closing from the inside.

Code	Lock	Outside Ø mm	Bore Ø mm	Bulkhead thickness mm	Stopper course mm
38.161.39	No	75	60	5-36	30-101

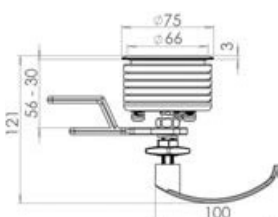

OSCULATI



▲ video



OSCOLATI



Lift and turn flush pull latch with compression system

AISI 316

COMPRESSION SYSTEM

**REGISTERED DESIGN /
DISEGNO DEPOSITATO**

Smooth pull catch system, with the same features of similar products but smoother and more practical to use. Cam system mechanism that compresses the locker/cabinet when closed and releases the pressure when the handle is lifted. Totally watertight.

Code	Lock	External Ø mm	Bulkhead hole Ø mm	For thickness mm	
				min	max
38.159.01	no	82	68	5,5	45
38.159.02	yes	82	68	5,5	45

Emergency open from inside

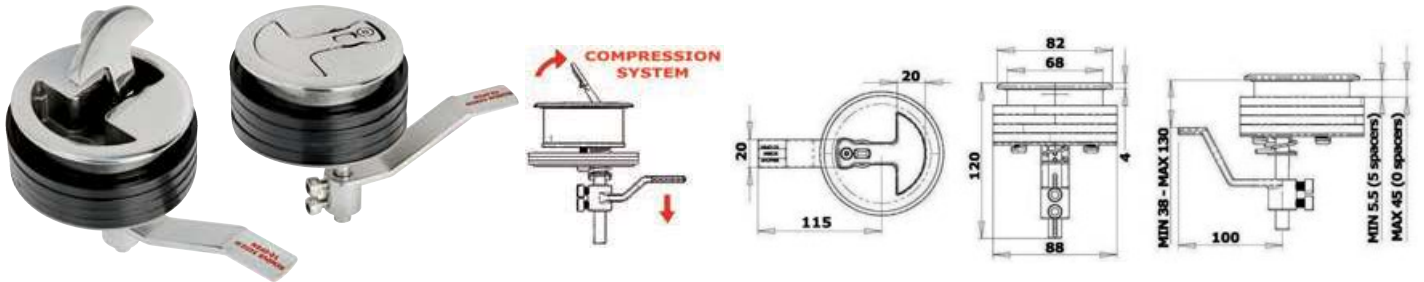

Spare cams/levers for pull latches

Their different shapes easily fit multiple hatches or applications.



Code	Standard on model
38.159.80	38.159.01; 38.159.02; 38.152.01; 38.152.02
38.159.81	38.159.01; 38.159.02; 38.152.60; 38.152.61

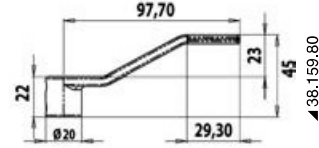
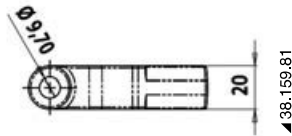
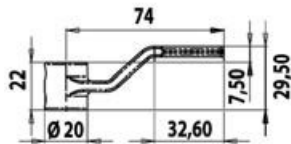

Door-stoppers

Jointed door stopper hook



Made of **chromed brass**, double joint.

Code	Length mm
38.192.79	60
38.192.80	80
38.192.81	100

Hooks



Made of **chromed brass**, door stoppers.

Code	Length mm
38.174.60	60
38.174.80	80
38.174.10	100



Doorstop hook

AISI 316

Made of **AISI 316 stainless steel** USA model.

Code	Length mm
38.173.10	100
38.173.75	75

Door/cabinet door stopper



Fitted with support **rolls** made of **stainless steel**.

Code	Base mm	Size mm
38.442.85	34x20	30
38.442.84	37x29	38

Snap latch made of chromed brass



Code	Description
38.107.40	Snap latch made of chromed brass suitable to lock doors, hatches and others.

Snap latch

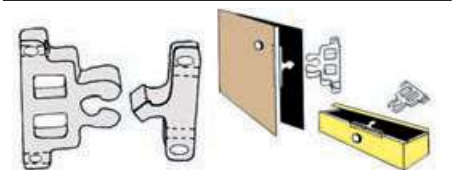

Code	Description	ORDER BY BOX
38.107.41	White nylon snap latch for cabinet doors and others uses	10

Snap-in door stopper

Made of **nylon and rubber**.

Code	Color	Base Ø mm	Total hangover mm	 ORDER BY BOX
38.422.88	white	50	17	10 pcs



New

Flush magnetic door stopper

OSCULATI

AISI316

FLUSH

PATENTED (UTILITY MODEL)

38.155.80 Door stopper with magnet inclined at 18° + ground stopper with embedded plate. When the door gets near the plate, the magnet raises the plate and the stop activates. When not in use, the plate automatically gets back in flat position and prevents tripping over it or any obstacle while passing.

Fitted with shockproof and vibration-proof gasket and a set of 2 gaskets (2 mm and 4 mm) to adjust the height of the ground stopper according to your needs. For doors mounted at 4 to 10 mm above the ground.

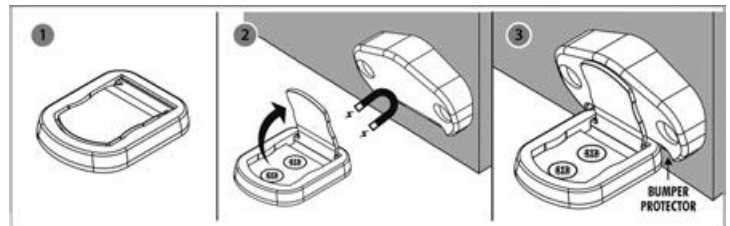
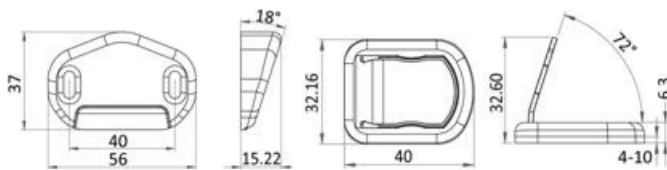

▲ Cushioned end stop

Adjustable magnetic doorstop

OSCULATI

Code	Description
38.155.00	Magnetic swivelling doorstop made of chromed brass .
38.155.01	Magnetic swivelling doorstop made of mirror-polished AISI 316 stainless steel



Magnetic doorstop

Made of **brass**, fitted with checking plate.

Code	Version
38.155.20	chromed brass



Telescopic magnetic doorstop



Made of **brass**, fitted with checking plate; adjustable from 50 to 82 mm.

Code	Version
38.155.30	chromed brass

Doorstop



Made of **chromed brass**, leaf with terminal vibration dampening rubber top.

Code	Ø base mm	Total length mm
38.154.00	40	50

Delux doorstop

EXTRA STRONG MAGNETE

Mirror-polished stainless steel doorstop. Magnet cover made of soft plastic to absorb impacts. Automatic circular orientation up to 10°. Sold in pairs (1 couple = 1 piece).

Code	Holding force kg	←→	
		Ø mm	Thickness mm
38.155.70	6	5	30+30

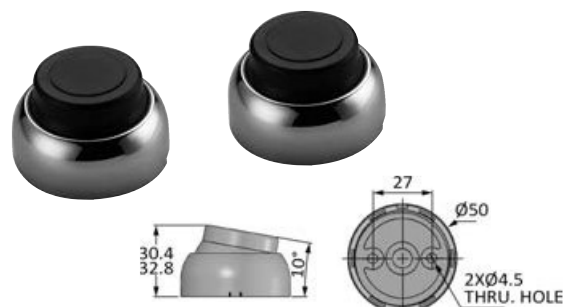

Door-stoppers for sliding doors

Sliding glass/door folding stopper

AISI 316



Made completely of **polished AISI 316 stainless steel**, fitted with stop plate coated with **shock-proof PVC**.

Code	Fixing base mm	Total length mm
38.156.00	47x18	74 including movable part

Openable hinges for glass stoppers/sliding door stoppers

AISI 316



Mirror polished AISI 316 stainless steel with anti-vibration plastic coated stopper

Code	closed mm	open mm
38.156.40	73x30	87x30

Sliding door stopper

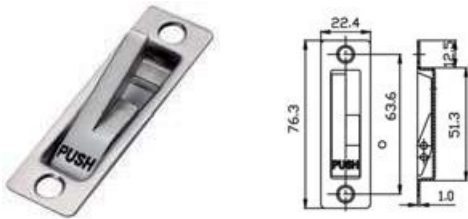

It comes out with an easy push. Made in precision cast, mirror polished AISI 316 stainless steel.

Code	mm
38.157.00	76.3x22.4

Sliding glass/door folding stopper



made in chromed brass

Code	mm
38.156.20	33x72

Latches



Sliding bolt lock

With special **vibration dampening** device.

Code	Material	mm
38.177.00	chromed brass	85x30
38.177.01	mirror polished AISI 316 stainless steel	85x30



Snap-in locking

AISI 316

made of **mirror polished AISI 316 stainless steel**, fitted with opening handle, ideal for access gangway hatches, for peaks and fridges/iceboxes.

Code	Base mm
38.190.00	48x38



Spring doorstop made of chromed brass

Made of **chromed brass**, designed for rear gangway access hatches.

Code	mm
38.189.01	120x40x12h



Stainless steel spring doorstops

AISI 316

Made of **polished AISI 316 stainless steel**, suitable for back gangplank access hatches.

Code	mm
38.189.03	134x53x16h



Blocking latches

made of **cast chromed brass**, very sturdy, brass piston.

Code	Length mm
38.188.19	60
38.188.20	90



Latch lock

Made of **polished stainless steel**, fitted with anti-vibration system, made-ready for lock fitting.

Code	mm
38.214.00	85x27

Latches

Spring lock



38.641.00 Chromed-brass spring lock, "Japan" product. For several uses, fitted with teak seal.

Spring lock



38.642.00 black nylon spring lock with seal on fake wood hole. Ring nut no longer available in black.

Door stopper pawl

Snap hatches and cabinet door with striker and with two adjustable screw spheres. Made of **chromed brass**.

Code	↔ mm
38.533.00	49x10

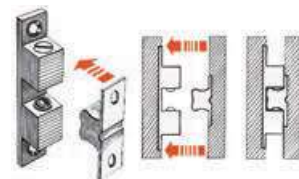

Deluxe doorstop ratchet

Made of chromed brass with stainless steel bearings and springs.

Code	↔ mm	Material
38.533.44	44x8	Chromed brass
38.533.49	49x8	Chromed brass
38.533.50	49.6x10	Stainless steel



Latch for door's cabinet

AISI 316

It must be installed on the interior side of the door's cabinet. It remains a hole which is closed from the mirror polished side. To open the door, you must push the hole also acting as handle. Counterplate with inclined tooth for easy installation.

Code	Hole Ø mm
38.184.00	28/33

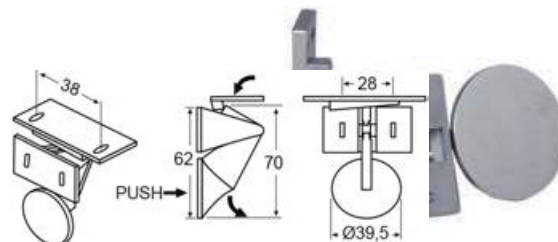

Closure handle for doors

It stays hidden under the door upright. Made of chromed brass.

Code	↔ mm
38.191.00	72x30x20

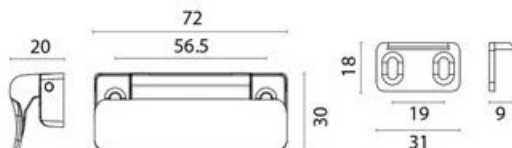

Recess fit lock for doors and drawers

38.192.00 To be recessed into the woodwork. Made of chromed brass. 19-mm hatch minimum thickness. **Simply press** the door to open it.

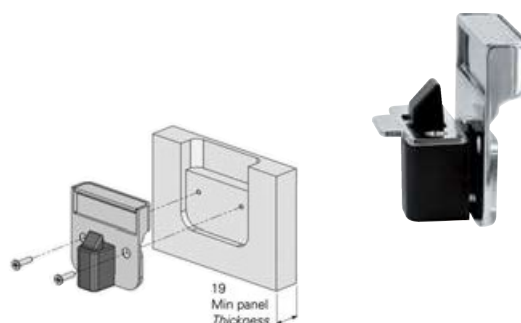
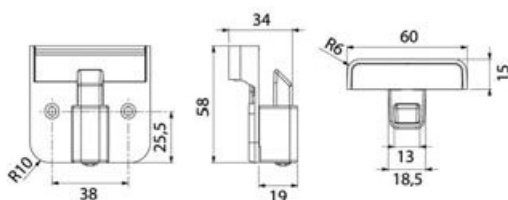

Button latch



Button latch made of **chromed brass**.

Code	mm	Knob Ø mm
38.309.20	30x23	25

Latch with pressure opening



38,644.00 Flush latch made of **chromed brass with pressure opening**. Very elegant and practical.



SUGATSUNE sealed magnetic lock - flat mounting

The magnet is embedded in the resin and is totally stainless. Thin lock, ideal for confined spaces.

Code	Colour	Magnetic force kgf	mm	SS counterplate	
				Code	mm
38.107.43	Black	3	45x17x5.6	38.107.45	49x15
38.107.44	White	3	45x17x5.6	38.107.45	49x15

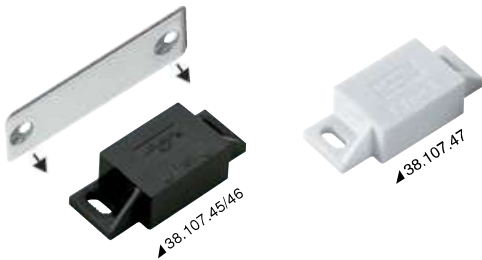
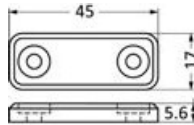

SUGATSUNE sealed magnetic lock - angle mounting

The magnet is embedded in the resin and is 100% stainless.

Code	Colour	Magnetic force kgf	mm	SS counterplate	
				Code	mm
38.107.46	Black	3	50x21x13	38.107.45	49x15
38.107.47	White	3	50x21x13	38.107.45	49x15

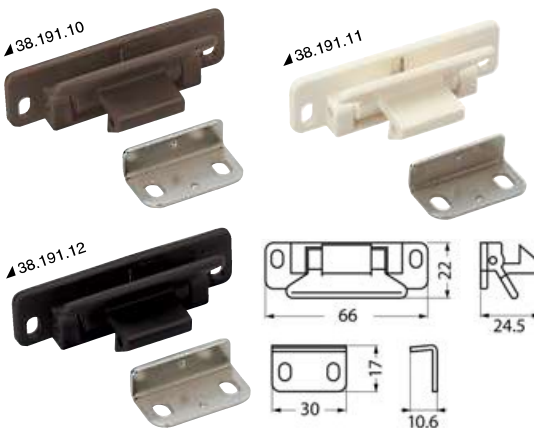
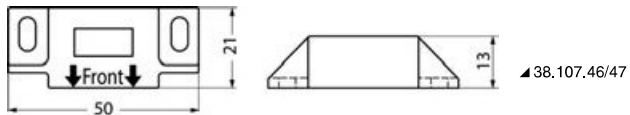

SUGATSUNE snap lever latch

Made of polyamide (PA). For doors without knobs or handles. Adjustable installation position (± 1.5 mm horizontally or vertically).

Code	Colour	Restraint force N
38.191.10	Brown	196
38.191.11	White	196
38.191.12	Black	196

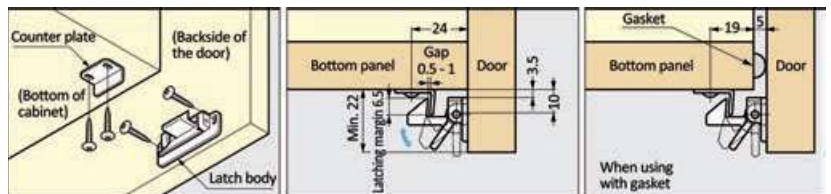

Cabinet door snap lock

Made of **stainless steel and ABS**; it may be opened or closed by lightly tapping on to it from the outside; universal model.

Code	mm	thickness mm	ORDER BY BOX
38.107.42	46x27	10	5

Pushbutton spring locks

MEDIUM pushbutton spring lock

Push-pull system spring lock for hatches and doors. Fitted with 4 spacers + 1 seal. Nylon body with SS springs.

- A = Round S knob.
- A1 = Round knob with spacer.
- B = Rectangular knob.
- B1 = Rectangular knob with Spacer
- C = Convex knob
- C1 = Convex knob with Spacer

Code	Finish	For hatch thickness mm					
		A	A1	B	B1	C	C1
38.182.50	White	15/18	15/24	16/19	16/25	16/19	16/25

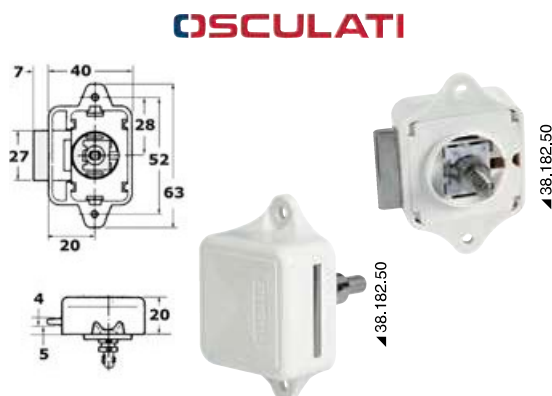

Self-Latching push latch

It makes the hatch close by **simply pushing it**. It works with both a recessed or projecting knob. Pull the knob to open the hatch. Nylon frame and stainless steel springs.

- A = Round S knob.
- A1 = Round knob with Spacer.
- B = Rectangular knob.
- B1 = Rectangular knob with Spacer.
- C = Convex knob.
- C1 = Convex knob with Spacer.

Code	Finish	For hatch thickness mm					
		A	A1	B	B1	C	C1
38.182.40	White	18/24	15/21	20/26	17/23	23/29	20/26

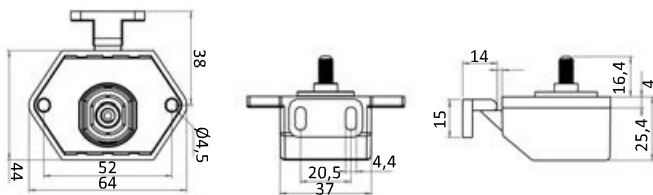

Knob + ring for spring locks 38.182.40/50/51/54

It comes with a spacer for use on 15/25-mm thick bulkwards.

Code	Type	Finishing		Hole Ø mm
		Ring	Pushbutton	
38.182.55*	Round S	Polished AISI316 SS	Polished AISI316 SS	25
38.182.60	Round	Chromed ABS	Chromed ABS	25
38.182.68	Round	Polished AISI316 SS	Satin AISI316 SS	25
38.182.70	Convex	Chromed ABS	Chromed ABS	25
38.182.78	Convex	Polished AISI316 SS	Polished AISI316 SS	25
38.182.80	Rectangular	Chromed ABS	Chromed ABS	25
38.182.88	Rectangular	Polished AISI316 SS	Polished AISI316 SS	25

* S version: superior design and finish. Product made from a CNC-wrought bar.



OSCULATI



Stop for latches 38.182.50/51 and 38.180.01

Electro-polished stainless steel

Code	Version	ORDER BY BOX
38.182.90	Flat	10
38.182.92	Square	10

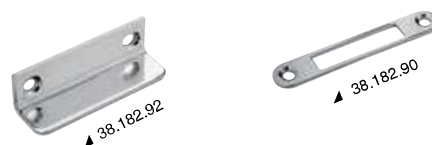

OSCULATI



Push-button click

Made of chromed zamak, fitted with nylon stop. When the knob is inserted aligned, the safety catch is connected and the hatch cannot be opened. Press the knob to push it out and release the safety catch.

Code	Neck Ø mm	Outer Ø mm
38.179.00	31x25	42

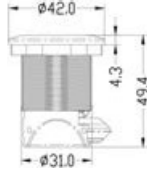

Brass switch with lock

Made of chrome brass. For 13/16/19/23-mm thickness.

Code	mm
38.193.00	30x40x21.5

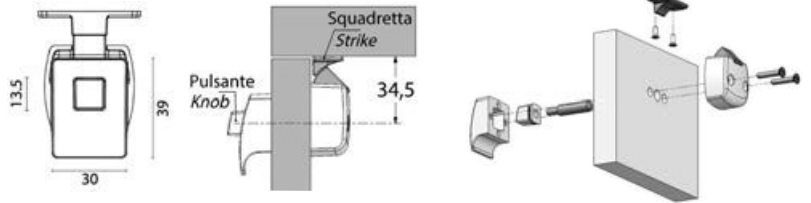

Flush Lock

Universal lock almost flush with the panel. Suitable even for heavy drawers and doors since it offers a very good grip. Made of stainless steel + chromed brass. MAGNETIC version for soft close drawers.



RETAIL (1 pc)	BULK (20 pcs)	Panel thickness mm	Finish	Version	Knob mm	Stop	Type
38.179.40	38.179.40BU New	4 - 27	Polished S.S.	Oval	36x25	Yes	A
38.179.41	38.179.41BU New	4 - 27	Polished S.S.	Square	35x35	Yes	A
38.179.45*	-	4 - 27	Polished S.S.	Oval	36x25	Yes	A (magnetic)
38.179.50	-	4 - 26	Polished S.S.	Oval	35x27	Yes	B
38.179.51	-	4 - 26	Polished S.S.	Rectangular	36x24	Yes	B

* MAGNETIC version for soft close guide drawers.

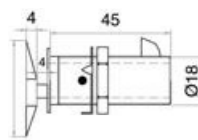

▲ 38.179.40/41 (Type A)

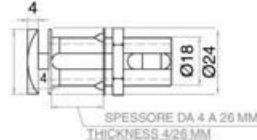

▲ 38.179.50/51 (Type B)

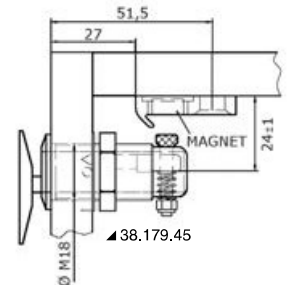

▲ 38.179.45

SELF-LATCHING pushbutton spring lock

This pushbutton spring lock allows to close the hatch by **simply pushing it**. Nylon frame with stainless steel springs. Opening by pressing the knob.

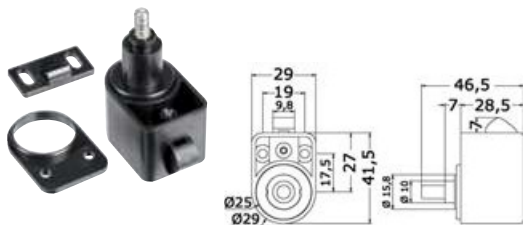

Code	Version	For hatches mm	Knob optional
38.182.54	automatic lock	16/22	38.182.55; 38.182.60; 38.182.68; 38.182.70; 38.182.78; 38.182.80; 38.182.88

Spring locks

Spring lock for hatches and cabinet doors

Press the push-button to **lock** it and is then **aligned**, press the button to **open** and to release the cabinet doors making a knob grip at the same time; 2-screw mounting click and ring nut from the outside with a hole of Ø size 26 mm; **nylon** casing, **stainless steel** springs.

Code	Version
38.180.01	Simple nylon ratchet
38.180.02	simple nylon ratchet with lateral anti-vibration stoppers

Minimum flange required 5 mm.

Attention: ratchet, only. Knob and ring nut art. 38.181.xx to be ordered separately.

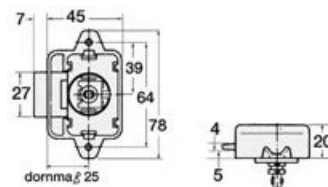
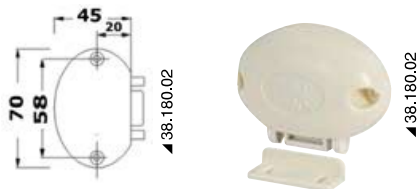

Chromed brass ring knob

To pair with spring latch 38.180.01/02.

Code	For thickness up to mm
38.181.01	13
38.181.02	16
38.181.03	19
38.181.00	23

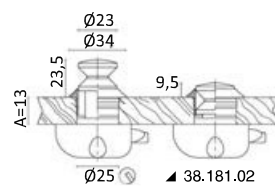
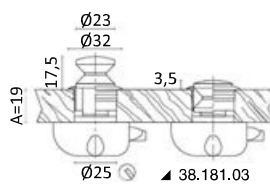
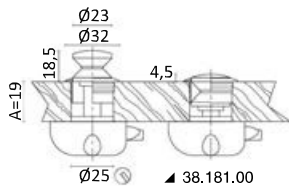
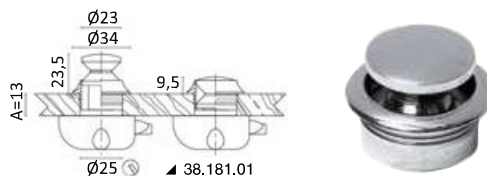

Knob with polished painted brass ring

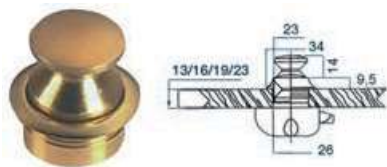

To pair with spring latch 38.180.01/02.

Code	For thickness up to mm
38.181.04	13
38.181.05	16
38.181.06	19
38.181.07	23

Knob with pearl chromed brass ring

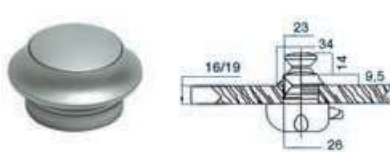

To pair with spring latch 38.180.01/02.

Code	For thickness up to mm
38.181.11	16
38.181.12	19

Knob with chromed brass ring



To pair with spring latch 38.180.01/02.

Code	For hatches up to mm
38.181.20	16
38.181.21	19
38.181.22	23

L shape stop plates

for pawl series: 38.180.01/02 and 38.182.01/04.

Code	Material
38.183.05	chromed brass



Mini push-lock



Classic version

Made of **nylon**, with **brass** button and ring. For 24-mm Ø ring.

Code	Finish	For hatches up to mm
38.182.01	Chromed brass	16
38.182.04	Polished and coated brass	16

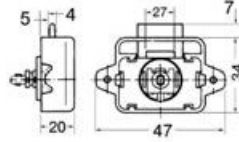

Flat version

Made of **nylon**, with **brass** button and ring. For 26-mm Ø ring.

Code	Model	for thickness up to mm
38.182.09	Chromed brass	16
38.182.10	Chromed brass	19

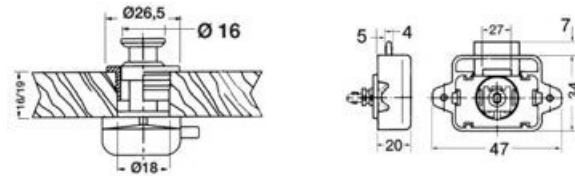

SUGATSUNE latches



Push Knobs for cabinet doors and drawers "Sugatsune Pkl-08"

Compact size, perfect functioning; after closing the cabinet door, press the knob to connect and secure it so that it will not re-open until the knob is pressed and pulled; suitable for thickness of 15 to 30 mm, capacity of 10 kg.

Code	Product	Color
38.185.01	Lock	white
38.186.01	Knob	golden
38.186.02	Knob	chromed



38.185.01

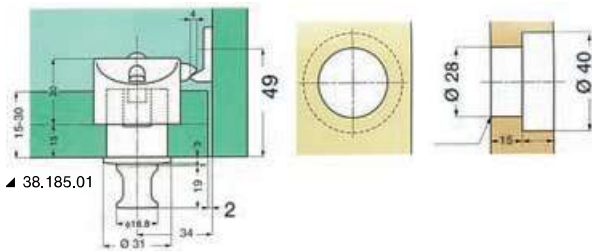

38.185.01

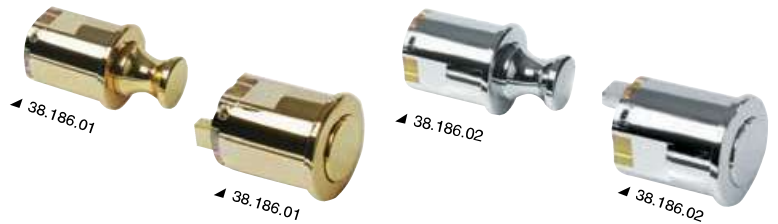

38.186.01

38.186.01

38.186.02

38.186.02

AISI 316 stainless steel built-in locks

Mirror-polished, suitable for doors 16 mm thick minimum. 6 mm handle square.

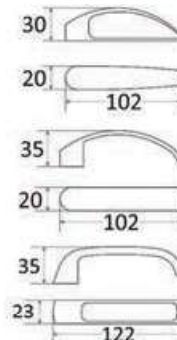
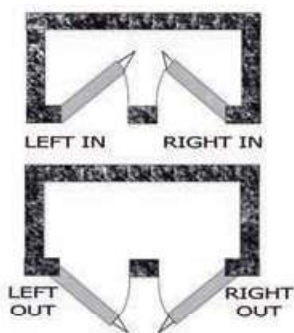

Lock/Latch Type:
LEFT INWARD
Regular Bevel



Lock/Latch Type:
LEFT OUTWARD
Reverse Bevel

Lock/Latch Type:
RIGHT OUTWARD
Reverse Bevel

Simple and lockless

Size: 51x45x10,5 mm. For 16/38-mm thick doors.

Code of lock with anti-vibration system	Handle pair with plates	Handle
38.129.04	38.129.07	SMART
38.129.04	38.129.08	CONTEMPORARY
38.129.04	38.129.09	LEATHER

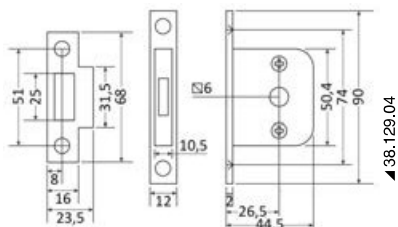

38.129.07 - SMART



38.129.08 - CONTEMPORARY



38.129.09 - LEATHER

With internal lock and external emergency lock (for toilets and cabins)

Size: 94x57x11,5 mm. For 16/38 mm thick doors.

Lock code	Version	Handle pair with plates		
		SMART	CONTEMPORARY	LEATHER
38.129.10	Internal left	38.129.14	38.129.16	38.129.18
38.129.10	External right	38.129.15	38.129.17	38.129.19
38.129.11	External left	38.129.14	38.129.16	38.129.18
38.129.11	Internal right	38.129.15	38.129.17	38.129.19



38.129.18/19 - LEATHER

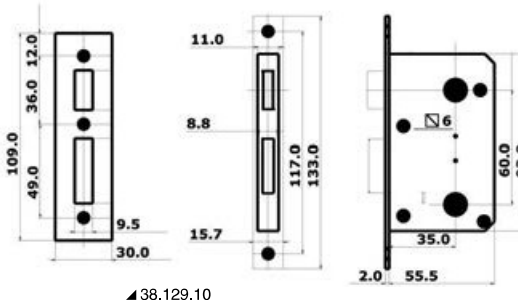

38.129.10



38.129.11 + 38.129.14 SMART



38.129.11 + 38.129.14 SMART



38.129.11 + 38.129.16 CONTEMPORARY



38.129.11 + 38.129.16 CONTEMPORARY

With Yale external lock, internal block

Size: 94x57x11,5 mm. For 16/38 mm thick doors.

Lock code	Version	Handle pair with lock and plates		
		SMART	CONTEMPORARY	LEATHER
38.129.30	Internal left	38.129.34	38.129.36	38.129.38
38.129.30	External right	38.129.35	38.129.37	38.129.39
38.129.31	External left	38.129.34	38.129.36	38.129.38
38.129.31	Internal right	38.129.35	38.129.37	38.129.39

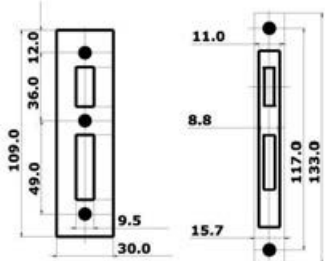

38.129.30



38.129.38/39 - LEATHER



38.129.34 - SMART



38.129.36 - CONTEMPORARY



38.129.38/39 - LEATHER



Magnet-operated locks

MAGNETIC

The locking pawl stays inside the door until this latter reaches its closed position; the magnet (included) in the lock stile attracts the pawl to stop the door. The magnet makes these locks universal for any kind of door opening direction. For 19/38-mm thick doors.

Lock code	Version	Handle pair with plates	Handle type
38.130.00	Simple	38.130.10	CONTEMPORARY
38.130.02	Right with strike plate	38.130.20	CONTEMPORARY
38.130.02	Left with strike plate	38.130.21	CONTEMPORARY

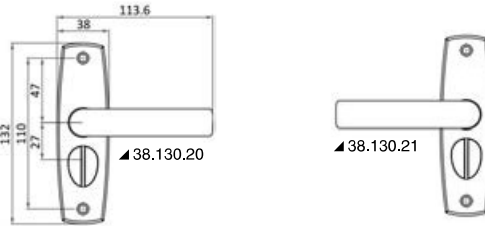
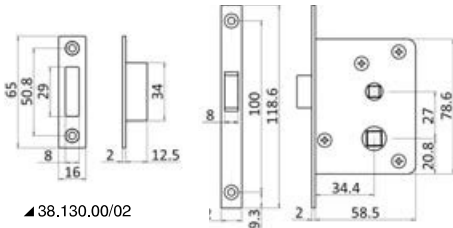

For sliding doors with built-in handle. Yale external key, internal lock

With bench hook. For 19/38 mm thick doors.

Code	Description	Body mm	Thickness mm	Plate mm
38.128.20	With flush hooking	140x68	12	200x18
38.128.21	With projecting hooking	140x68	12	200x18

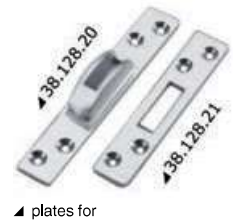
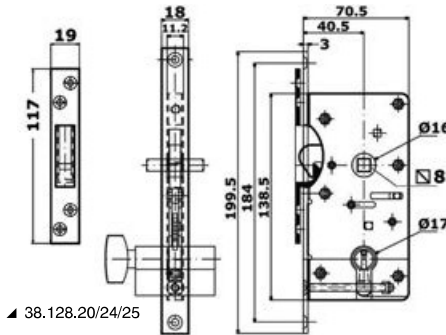
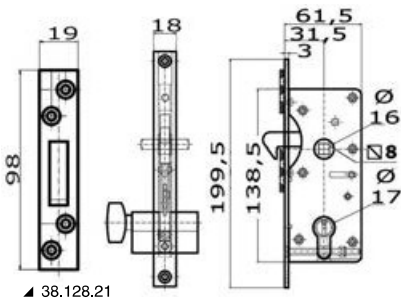

plates for



Lock for sliding doors with external handles, Yale external key and internal strike plate

With bench hook. For 19/38-mm thick doors.

Code	Description	Handle	Body mm	Thickness mm	Plate mm
38.128.24	With flush hooking	SMART	140x68	12	200x18
38.128.25	With flush hooking	CONTEMPORARY	140x68	12	200x18



AISI316 stainless steel free-standing locks

With knob and Yale external key. Knob lock from inside

Equipped with drawer bench hook. For doors 16/38-mm thick.

Code	Size: mm
38.128.30	90,5x57

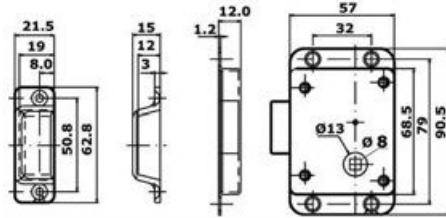

Handleless lock, handle with knob internal lock and Yale external key

Equipped with drawer bench hook. For doors 16/38-mm thick.

Lock code	Version	Dimensions mm	SMART handle (pair)	CONTEMPORARY handle (pair)
38.129.50	Internal right	118,5x57	38.129.55	38.129.57
38.129.51	Internal left	118,5x57	38.129.54	38.129.56
38.129.52	External right	118,5x57	38.129.55	38.129.57
38.129.53	External left	118,5x57	38.129.54	38.129.56

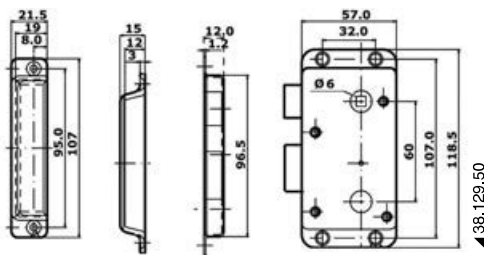

Door locks

MANO SERRATURE
Lock

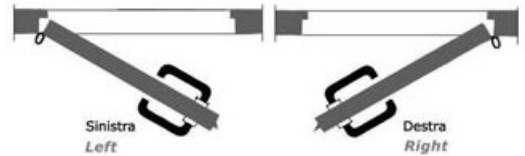
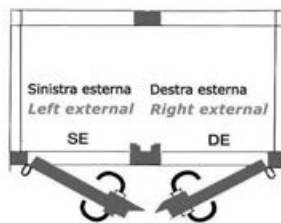
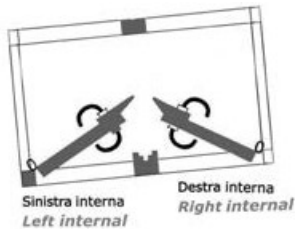

Lock with rim latch

Externally made of **chromed brass**, YALE type with two keys; **brass** mechanism.

Code	Version
38.132.00DX	right
38.132.00SX	left

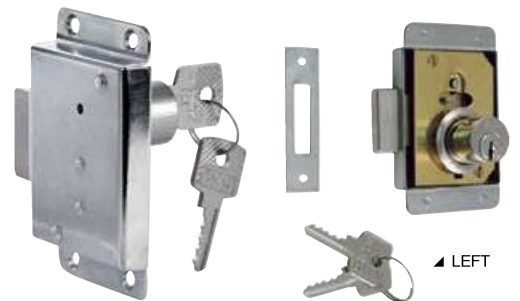
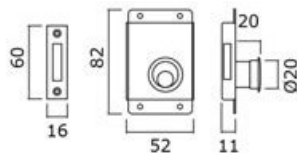

Double-turn lock with rim latch

Made of **chromed brass**, fitted with cylinder key from the outside and internal knob; very practical locking, suitable for doors, fitted with striker.

Code	mm	Cylinder neck length mm	Version
38.132.10DX-20	98x58	20	right
38.132.10DX-25	98x58	25	right
38.132.10DX-30	98x58	30	right
38.132.10SX-20	98x58	20	left
38.132.10SX-25	98x58	25	left
38.132.10SX-30	98x58	30	left

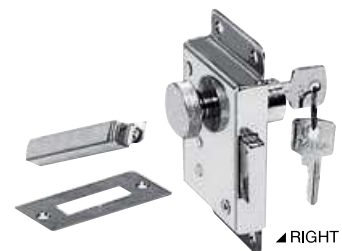

▲SX external



Two-turn lock

Version with rim latch made of **chromed brass**, suitable for entrance doors, fitted with external handle and cylinder, internal knurled knob. Very practical and sturdy lock, fitted with striker.

Code	mm	Frame mm	Cylinder mm	Version
38.132.20DE-20	58x138	8	20	External right
38.132.20SE-20	58x138	8	20	External left
38.132.20SE-35	58x138	8	35	External left

Handles not included.



Lock for W.C. units fitted with locking lever

Made of **chromed brass**; all rust-proof material.

Code	mm	Frame mm
38.131.50	72x46	8

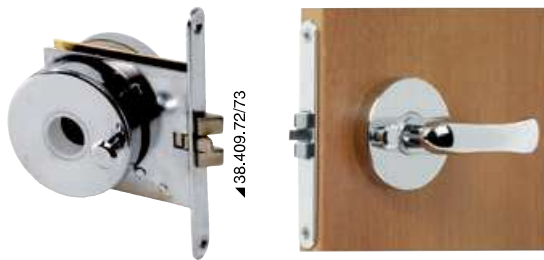

Antivibration recess fit reversible lock (RIGHT-LEFT)

Made of chromed brass, compact and thin. Handles: all 8mm square models on the catalogue.

Code	Version	Lock mm	Door thickness mm
38.409.70*	simple	68.2x60x13	min 15
38.409.72	with internal locking button and emergency release hole	66x60x9.5	18-23
38.409.73	with internal locking button and emergency release hole	66x60x9.5	24-29

* 38.348.12 Socket required for 8-mm frame handles.

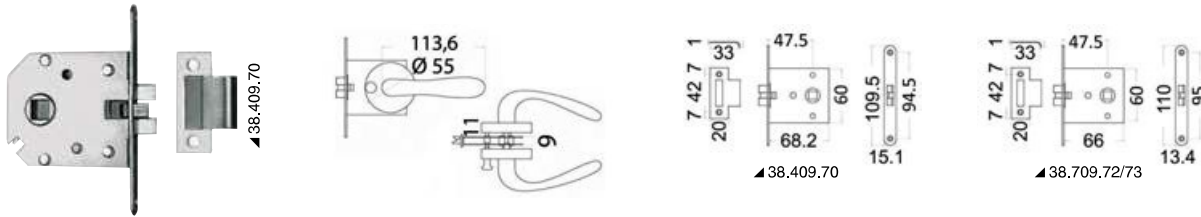

Universal RIGHT/LEFT lock for sliding doors

Made of chromed brass. Built-in version for 15-mm thick doors. Safety cylinder, internal block and doorstop.

Code	mm	Door thickness mm
38.132.05	134x80	15

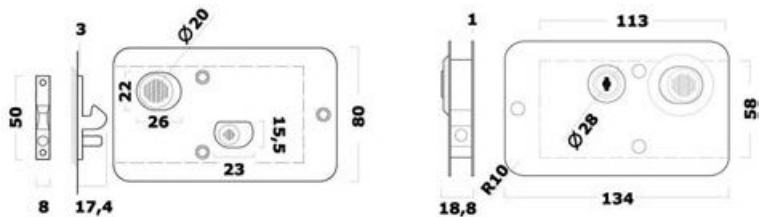

Recess-fit lock for sliding doors



Made of chromed brass, designed for sliding doors with flush handles, suitable for doors with minimum thickness of 20 mm.

Code	Version	Plate mm	Frame mm
38.132.07	Complete with traditional key lock	158x87	112x15

Recess-fit lock with sliding door stopper



Made of chromed brass, designed for sliding doors with flush handle, suitable for doors with minimum thickness of 20 mm.

Code	Version	Plate mm	Frame mm
38.132.08	With lock lever and unlock key from other side	158x87	112x15

Recess-fit lock for sliding door with Yale-type key

Made of **chromed brass**.

Code	Version	Model	Thickness mm	Frame mm	Fitted with two plates mm	Square mm
38.348.70	Yale lock	With handle	15	160x15	198x45	8

any handle and washer on the catalogue, 8-mm square.



Recess-fit lock for sliding door with traditional key

Made of **chromed brass**.

Code	Version	Model	Thickness mm	Frame mm	Fitted with two plates mm	Square mm
38.348.71	Regular key	With handle	15	140x15	140x70	8



Flush lock

Made of **chromed brass**, designed also for thin doors.

Code	Version	Front part mm	Plate mm
38.131.47	anti-vibrating spring latch	110x13,4	8
38.131.46	for sliding doors	110x13,4	8

38.131.48 Pair of 118x36 chromed brass plates with inside latch.

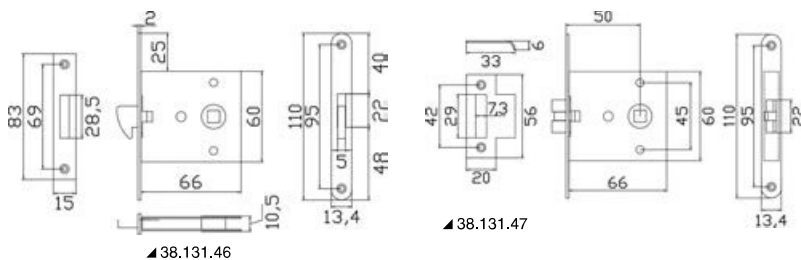

Stainless Steel sliding door lock

Made of **stainless steel**; fitted with stopper, Yale type cylinder and flat handle, its low depth makes it especially suitable for doors with thin borders.

Code	Frame mm	Box mm	Panel mm	Depth mm	Length cylinder mm
38.132.03	250x25x3	194x43x15	8	43	45



Flush lock with safety cylinder



Made of **chromed brass**, 8-mm plate.

Code	Version	Complete with plates and handles	Front panel mm	Frame mm
38.134.83DX	right	Fitted with 2 plates and handles	150x15	110x63
38.134.83SX	left	Fitted with 2 plates and handles	150x15	110x63

Lock for W.C. units, fitted with internal locking system



Code	Version	Complete with plates and handles	Front plate mm	Frame mm
38.347.40DX	right	Fitted with 2 chromed brass plates and handles 84 mm	133x15	93x55
38.347.40SX	left	Fitted with 2 chromed brass plates and handles 84 mm	133x15	93x55



Recess-fit lock

Flush mount, made of **satín finish chromed brass**, fitted with vibration dampening device and safety cylinder.

Code	Version	Complete with plates and handles	Front part mm	Frame mm
38.203.50DX	right	fitted with 2 plates and handles 110 mm	212x22x2	9
38.203.50SX	left	fitted with double plate and handle 110 mm	212x22x2	9
38.203.51DX	right	No*	212x22x2	9
38.203.51SX	left	No*	212x22x2	9



* 38.348.12 Socket needed for 9- to 8-mm frame for any handle and washer on our catalogue, 8-mm frame.



Vibration dampening lock, flush mount, fitted with internal locking system, designed for toilets. External safety locking

Made of **chromed brass**, standard frame and external lock release key.

Code	Version	With plates and handle	Frame mm	Plate mm
38.203.71DX	right	No*	9	212x22
38.203.71SX	left	No*	9	212x22



* 38.348.12 Socket needed for 9- to 8-mm frame for any handle and washer on our catalogue, 8-mm frame.



Locks with swivelling lock from one side and key lock release from the other

Chromed brass locks, designed for door thickness 15 mm, fitted with stopper, stainless steel plate set and handle set 84 mm.

Code	Version	With handle	Pin mm	Front part mm	Plate mm
38.134.03	left	Yes	8	133x15	133x70
38.134.04	right	Yes	8	133x15	133x70
38.135.03	left	No*	8	133x15	133x70
38.135.04	right	No*	8	133x15	133x70

* Uses any handle and ring from the catalogue, pin 8 mm.



Locks without key

Chromed brass locks, designed for door thickness 15 mm, fitted with stopper, stainless steel plate set and handle set 84 mm.

Code	Version	With handle	Pin mm	Front part mm	Plates mm
38.134.05	left	Yes	8	80x15	80x70
38.134.06	right	Yes	8	80x15	80x70
38.135.05	left	No*	8	80x15	80x70
38.135.06	right	No*	8	80x15	80x70

* Uses any handle and ring from the catalogue, pin 8 mm.



Lock for W.C. units

made of **chromed brass**, fitted with external application, includes handle with knob and push-sown ring, oval tab with **double stop**, external or wall mounting.

Code	Body mm
38.227.10	95x57



Kit fitted with over-hanged handle

Made of **chromed brass, chromed nylon and stainless steel**, fitted with internal locking system and recess stop or draw stop, ideal for W.C. units and cabins.

Code	Body mm
38.177.60	54x44

Door handles with universal square pin

Classic handles

Code	Fitted with washer	Type	← mm	Material	Square pin mm
38.395.00	no	Oval M	26x51	Chromed brass	8
38.340.50	no	Style	40x32	Anodized aluminium	8
38.348.50	no	Classic	80x35	Chromed brass	8
38.348.46	no	Kata	113	Chromed brass	8
38.348.47	no	Kata II	85	Chromed brass	8
38.348.48	no	Spoon	82	Chromed brass	8
38.348.60	yes	Guerini	133	Chromed brass	8



Handles

Code	Fitted with washers	Type	← mm	Material	Square pin mm
38.349.11	Yes	Slim	124	Chromed brass	8
38.348.40	Yes	Nauta S	100	Polished AISI 316 SS	8
38.348.41	Yes	Nauta R	120	Polished AISI 316 SS	8
38.348.56	Yes	Square	110	Chromed brass	8

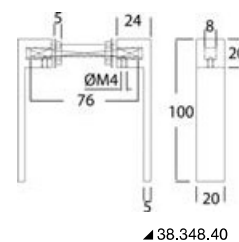
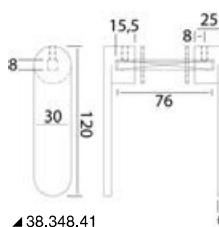
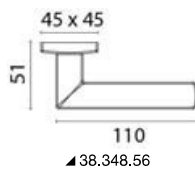
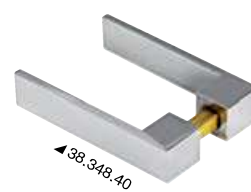
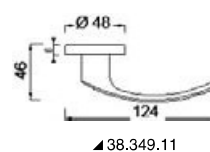

Door handles and accessories

Handle washers

Chromed brass. Sold in pairs.

Code	Ø mm	Version
38.348.10	28x53	Round hole
38.348.11	45	Round hole



Sliding door accessories



Nickel-plated brass rail and carriage slide for sliding doors

Made of **nickel-plated brass**, designed for mounting on the lower part of the door; sold by 2-meter bars.

Code	Product	←→ mm	Note
38.342.80	rail	30x12x2000	-
38.342.90	car	64x37	Ø wheel 30 mm

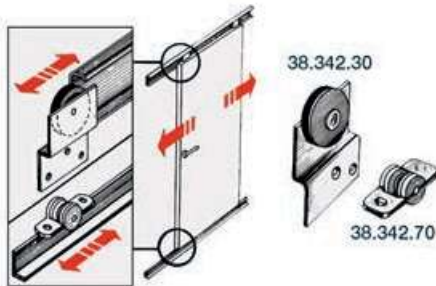

Stainless steel rail and carriage slide for sliding doors

Code	Part	Description	←→ mm	Mounting
38.342.20	upper	stainless steel rail	45x14x2000	on the upper part of the door
38.342.30	upper	Sliding traveller with self-lubricating plastic wheels	support 60x70	each door needs two travellers
38.342.60	lower	stainless steel rail	12x11x2000	on the lower part of the door
38.342.70	lower	car with wheel	38x15	each door needs two travellers



Sold in 2-meter bars.



Shelves

38.026.00 Made of **stainless steel**, designed for cabin tables; model fitted with two hooks an two hook supports; pressed pieces, very sturdy.

Coat hangers and accessories

Coat hanger with 3 swivelling hooks



Code	Version	Plate mm
38.162.00	polished brass	73x36
38.162.01	chromed brass	73x36

Coat hanger with 4 swivelling hooks



Code	Version	Plate mm
38.205.00	polished brass	81x39
38.205.01	chromed brass	81x39

Coat hanger made of cast polished AISI 316 stainless steel

AISI 316

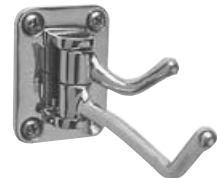

Code	Base mm	Thickness mm
38.313.00	38x53	90 (max)

Foldaway coat hangers



Stainless steel spring.

Code	Version	←→ mm
38.104.01	Chromed brass	75x25
38.104.02	Polished brass	75x25

Coat hanger



made of **polished stainless steel**.

Code	Base mm	Size mm
38.031.31	40x26	70

AISI316 stainless steel cast hook

made of cast polished stainless steel.

Code	D mm	H mm
38.313.50	25	25
38.313.90	22	30
38.313.40	29	32
38.313.30	25	41
38.313.45	33	53
38.313.70	47	27
38.313.80	66	36



Coat hook

AISI 316

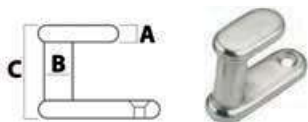

Made of polished **AISI 316 stainless steel**.

Code	A mm	B mm	C mm
38.031.29	5.7	9.2	30

Double-screw cast hook

AISI 316

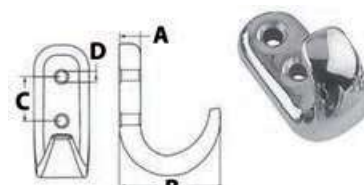

Made of cast mirror polished **AISI 316 stainless steel**.

Code	A mm	B mm	C mm	D mm	ORDER BY BOX
38.301.09	6.5	31	10	3.6	10

Multipurpose hook



Made of polished stainless steel.

Code	Length mm	Base
38.102.10	55	two holes

Plate with ring

AISI 316



Made of **AISI 316 stainless steel**.

Code	Base mm	Overhang mm	ORDER BY BOX
38.301.11	27x30	19	10

Compact cast hook

AISI 316



Made of cast mirror polished **AISI 316 stainless steel**.

Code	Base mm	thickness mm	ORDER BY BOX
38.301.10	23x23	20	10

Single-screw hook

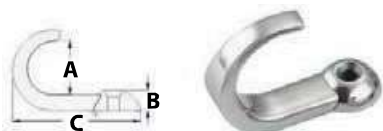

Made of polished **AISI 316 stainless steel**.

Code	AxBxC mm
38.301.08	15x5.7x35.8

High-resistance single-screw hook

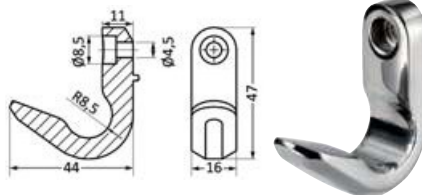

Mirror-polished **AISI316 stainless steel**.

Code	mm
38.301.14	47x16x44

High-resistance hook with hidden screws

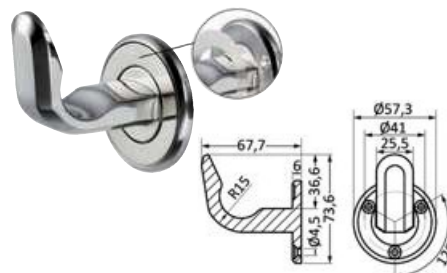

Mirror-polished **AISI316 stainless steel**. The screws are hidden by a self-adhesive bezel made of polished AISI316 stainless steel.

Code	mm
38.301.15	73.6x67.7x57.3

Multipurpose hook



made of **chromed brass**.

Code	mm
38.178.00	43x13x14

Chromed cast hook



Made of **chromed brass**.

Code	mm
38.102.20	45x33

Moulded stainless steel hook



Made of **polished stainless steel**, designed for wall mounting.

Code	Length mm	Base mm
38.320.00	40	32x15
38.320.01	60	43x20

Ceiling hooks



Made of **polished stainless steel**.

Code	Length mm	Base mm
38.321.00	33	32x15
38.321.01	45	43x20

Pressed hooks



Made of **stainless steel**.

Code	Length mm	Base mm
38.102.05	32x24	32x13

Coat hook



Made of **nylon**.

Code	Length mm	Base mm
38.105.65	55x24	24x35



SUGATSUNE slide

Made of **stainless steel**, on sphere for drawers; perfect sliding, heavy duty; two extension parts (3/4 opening). Fitted with limit switch friction to hold the drawer in open position.

Code	Slide length mm	Sliding length mm	A mm	B mm	C mm	D mm	E mm	F mm	Capacity kg
38.272.12	304	300	155	255	98	137	247	260	24
38.272.14	350	347	225	310	-	-	290	310	23
38.272.16	397	397	265	357	-	-	358	378	21

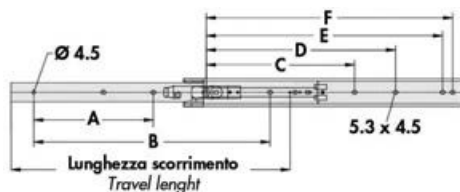

SUGATSUNE soft-close drawer slide

Stainless steel ball bearing slide. Total extension (3 steps).
Soft **automatic** closing: it closes automatically when it reaches 20 or 35 mm from the end of its stroke (series 300/350 mm and series 400/500 mm, respectively).
The drawer can be **removed** from its slides.

Code	Length		Load capacity kgf per pair
	stroke A mm	slide B mm	
38.273.12	275	300	20
38.273.14	353	350	25
38.273.16	404	400	25
38.273.18	455	450	30
38.273.20	505	500	35

Sold in pairs.

Self & Soft Closing

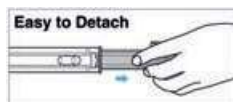
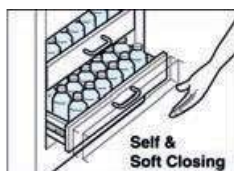

Padlocks

Sicurbolt antitheft device for outboard engines

Made of mirror-polished AISI 316 stainless steel.
To be mounted onto one of the outboard engine fastening bolts.
Extra-strong make for higher protection. For all engines.

Code	↔ mm
38.175.20	Ø48x61

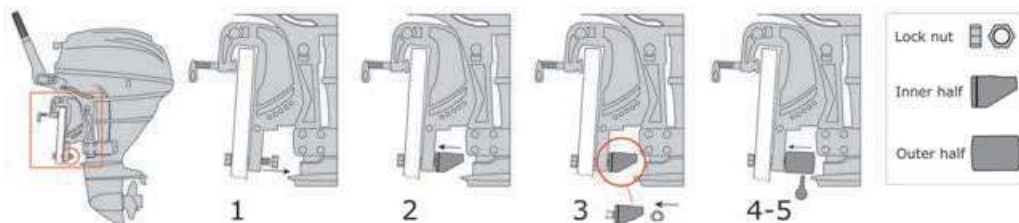

SECURE LOCK antitheft device for outboard engines

Locks the butterfly nut: So the engine cannot plunge into the water; prevents the outboard engine from been stolen, as it the Secure Lock must be broken. Made of **anodized aluminium** pipe thickness 4 mm (very sturdy); **brass and stainless steel** lock with two keys. Tough sturdy look discourages thieves; compact model with in **stainless steel** end-pieces and inner pipe made of anti-rattle foam

Code	For engines
38.175.10	up to 25 HP
38.175.11	over 25 HP ad for all Mercury engines

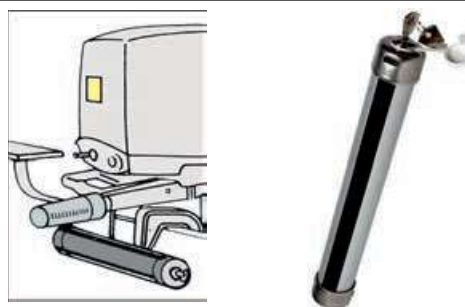

Antitheft device made of stainless steel for outboard engines

It locks the wing nuts and is equipped with **marine** padlock with chromed-brass body, **stainless steel arc and springs**, water **self-draining** system.

Code	Length mm	Recommended for engine upto HP
38.176.10	230	25
38.176.11	280	over 25



Padlock fitted with Abloy safety key

Chromed brass body, fitted with **stainless steel** shackle.

Code	↔ mm	A mm
38.021.25	25	19
38.021.30	30	20
38.021.40	40	26
38.021.50	50	31
38.021.60	60	38



Set of 4 marine padlocks with the same ABLOY safety key

Four padlocks in display blister with four identical keys. Chromed brass body and stainless steel arc.

Code	↔ mm	A mm
38.022.34	30	20



Special marine padlocks



Made of **marine bronze and stainless steel shackle**, sold in single boxes.

Code	Arc size mm
38.024.30	30
38.024.40	40
38.024.50	50

Heavy duty burglar-proof locks with Fisher key

AISI 304



Body and shackle made of AISI304 stainless steel, locking mechanism made of chromed brass.

Code	Arc mm
38.025.30	30
38.025.40	40
38.025.50	50