



## Hatches, housings and lockers type-tested in compliance with Directive 2013/53/UE

**OSCULATI**

### FLUSH inspection hatch CE

The faired cover hides the frame completely. 100% flush hinges. **180° opening**. Walking surface. UV BASF resistant. It can be installed on any sports craft, boat design category A, B, C, and D, area II a, III, IV, watertightness degree 2.



▲ 20.291.00

▲ 20.291.00

White	Cream RAL 9001	Black	Grey RAL 7042	Outside mm	Inside mm	Cut mm	OPTIONAL lock kit
20.291.00	20.291.40	20.291.50	20.291.60	380x280	295x198	310x210	20.093.00
20.292.00	20.292.40	20.292.50	20.292.60	600x350	513x265	530x280	20.093.00
20.293.00	20.293.40	20.293.50	20.293.60	375x375	285x285	300x300	20.093.00
20.294.00	20.294.40	20.294.50	20.294.60	520x465	430x375	445x390	20.093.00
20.295.00	-	20.295.50	20.295.60	600x250	515x165	530x180	20.093.00



▲ 20.292.00



▲ 20.294.00



▲ 20.293.00



▲ 20.291.40



▲ 20.291.60



▲ 20.291.50



▲ 20.295.00

**CE APPROVED**  
based on  
**UNI EN ISO 12216:2004**

**OSCULATI**

### Faired inspection hatch with hidden screws

180° opening, very sturdy, antiskid finish, interchangeable sizes with product numbers 20.301.00-20.302.00.

Code	Outside mm	Inside mm	Cut mm	OPTIONAL lock kit for ready installation
20.298.00	280x380	198x295	210x310	20.093.00
20.299.00	350x600	265x513	280x530	20.093.00



▲ 20.299.00



▲ 20.298.00



▲ 20.298.00



▲ 20.093.00  
Ready  
installation lock  
kit OPTIONAL

### Inspection hatch with very sturdy anti-slip walking surface, CE

**Splash-proof** cover locking with neoprene gasket. Flush-mount. It may be used as hatch for lockers, fishing tanks, storeroom hatch and bulkhead hatch, **160° opening**. It can be installed on any sports craft, boat design category A, B, C, and D, area II a, III, IV, watertightness degree 2.

White	Grey	Outside mm	Inside mm	OPTIONAL lock kit for ready installation
20.301.00	20.301.60	280x380	180x280	20.093.00
20.302.00	20.302.60	345x595	250x500	20.093.00

OSCOLATI

CE APPROVED  
based on  
UNI EN ISO 12216:2004

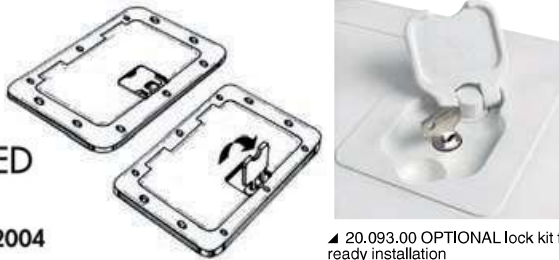

▲ 20.093.00 OPTIONAL lock kit for ready installation



▲ 20.302.00



▲ 20.301.00



▲ 20.301.00

### Inspection hatch with removable front lid

OSCOLATI

Very sturdy anti-skid surface; **splash-proof** lid closure with neoprene seal; flush mounting; they can be used as hatches for lockers, fishing containers or as boxroom hatches or bayonet front bulkheads; removable front for easy access. Ideal for installation on dashboard with nearby steering bench.

White	Cream RAL 9001	Grey	Black	Outside mm	Inside mm	OPTIONAL lock kit for ready installation
20.302.20	20.302.21	-	20.302.23	305 x 355	225 x 275	-
20.302.30	20.302.31	20.302.32	20.302.33	375 x 375	295 x 295	-
20.302.40	-	-	-	350 x 600	250 x 500	20.093.00



▲ 20.302.20



▲ 20.302.30



▲ 20.302.33



▲ 20.302.40



▲ 20.302.40



▲ 20.093.00 Lock kit for ready installation - OPTIONAL

### PUSH PULL inspection hatch

OSCOLATI

**EASY OPEN** Opening and closing with flush handle and snap-in locking system; neoprene cover gasket; 175° opening.

white	RAL 9001 cream	Outside mm	Inside mm	Cut mm	OPTIONAL lock kit
20.303.00	-	380x280	295x198	310x210	20.094.00
20.305.00	20.305.40	405x375	320x290	330x300	20.094.00
20.306.00	-	520x465	430x375	445x390	20.094.00
20.304.00	-	600x350	513x265	530x280	20.094.00



▲ 20.094.00 lock kit



▲ 20.305.40



▲ 20.304.00



▲ 20.305.00



▲ 20.306.00



▲ 20.303.00

**OSCULATI**

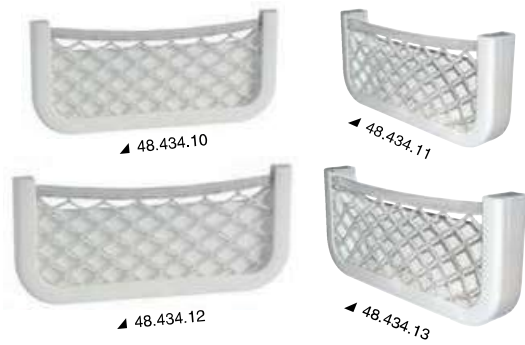

**Storage pocket**

White ABS body with woven nylon elastic net.  
Self-adhesive back or to be fixed with 4 screws.

White	Black	mm	Suitable to be fixed on hatches
48.434.10	48.434.20	250x115x10 (LxHxP)	20.291.00; 20.293.00; 20.303.00; 20.305.00; 20.305.40
48.434.11	48.434.21	250x115x30 (LxHxP)	-
48.434.12	-	360x160x12 (LxHxP)	20.292.00; 20.294.00; 20.299.00; 20.304.00; 20.306.00
48.434.13	-	360x160x30 (LxHxP)	-



**Locker with watertight hatch**

Fitted with seal and 3 removable drawers with internal compartments; ideal for storing fishing gear or as a hardware drawer.

white	Outside mm	Inside mm	Cut mm	Depth mm	Frontal type	Hatch type	OPTIONAL lock kit	Spare drawer
20.871.10	380x280	280x180	310x210	180	A	20.298.00	20.093.00	20.871.90
20.871.11	380x280	280x180	310x210	180	B	20.291.00	20.093.00	20.871.90
20.871.12	380x280	280x180	310x210	180	C	20.303.00	20.094.00	20.871.90



**OSCULATI**



**Locker with lid**

Comprised of lid and polyethylene peak

white	Outside mm	Inside mm	Depth mm	Hatch type	OPTIONAL lock kit
20.310.00	380x280	280x180	180	20.301.00	20.093.00
20.311.00	380x280	280x180	180	20.298.00	20.093.00
20.312.00	380x280	280x180	180	20.291.00	20.093.00
20.313.00	380x280	280x180	180	20.303.00	20.094.00
20.316.00	375x375	285x285	240	20.293.00	20.093.00
20.320.00	595x345	500x250	280	20.302.00	20.093.00
20.322.00	600x350	500x250	280	20.292.00	20.093.00



**Side-mount locker**

Made of white ABS, fitted with fully faired cover, hides the frame completely. Flush-mount front bulkhead, the pocket may be mounted with the opening towards the top or bottom.

Code	Compartment	Outside mm	Inside mm	Depth mm	OPTIONAL ready-to-install locking kit
20.028.01	All open	600x250	530x190	190	20,093,00

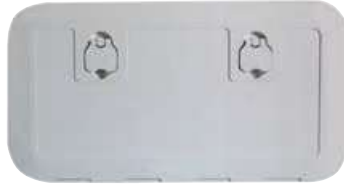

▲ 20.093.00 locking kit

**OSCULATI****Storage locker**

Pleasant look and fine finish; can be mounted anywhere in the boat; **white polypropylene** compartment with watertight locking hatch and **neoprene** seal; hidden screw frame, **white polycarbonate, UV resistant** cover.

Code	External size mm	Internal size mm	Depth mm
20.017.00	364x183	321x140	150
20.017.01	364x183	321x140	75

**OSCULATI****5-drawer storage locker**

White polypropylene compartment, pleasant look and fine finish, watertight locking with **neoprene** seal; hidden screw frame, **clear polycarbonate, UV resistant** cover. Designed for vertical mounting; fitted with 5 removable drawers; ideal for storing small parts or fishing items.

Code	Outer size mm	Internal size mm	Depth mm	Drawers mm
20.019.00	364x183	321x140	150	130x150x50

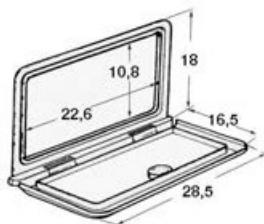
**OSCULATI****Locker with white frame**

Code	Outside mm	Depth mm	Lock
20.021.00	285x180	260	yes
20.021.01	285x180	260	no

**Storage locker****OSCULATI**

Code	Outside mm	Inside mm	Depth mm
20.033.00	240x145	195x95	48

**Spare handles for Osculati hatches**

Code	Colour	For hatches and trapdoors	mm				
			A	B	C	D	E
20.339.00	White	<b>Flush and Classic series hatches</b> 20,291.00 / 20,292.00 / 20,293.00 / 20,294.00 / 20,295.00 / 20,298.00 / 20,299.00 / 20,302.20 / 20,302.30	95	56	30	66	30
			20.338.00	White	<b>Round trapdoors and hatches with visible screws</b> 20,840.00 / 20,844.00 / 20,301.00* / 20,302.00*	95	56



\* A 4-mm Ø hole is required

## Compartments and ABS storage pockets

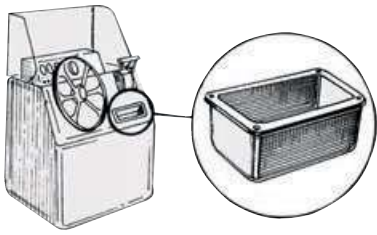

### Cockpit or instrument panel storage compartment

White polished ABS

Code	Outside mm	Compartment mm
20.026.00	240x140	200x100x100

### Locker with cup holders

Made of white plastic, fitted with push-button lock and key.

Code	External size mm	Internal size mm	Depth mm
20.021.50	335x130	295x95	153



### White ABS side pocket

Object-holder side pocket with elastic net and self-adhesive caps.

Code	Compartment	Outside mm	Net compartment mm	Depth mm
20.025.00	rigid	540x244	500x200x116	120
20.025.60	with screen and screw cover plate	540x244	500x200x116	120



▲20.025.00



▲20.025.60

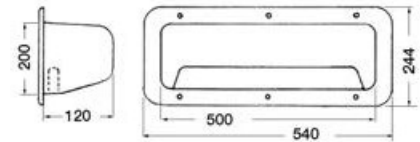
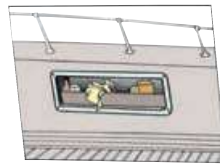

### Side storage locker

Designed for mounting stereo speakers, made of **polished white ABS**; wall-mounting.

Code	Outside mm	Inside mm	Depth mm	For OPTIONAL stereo speakers
20.024.00	535x320	495x280	116	29.722.00; 29.721.99



### Side housing.

Designed for stereo speaker mounting, White polished ABS.

Code	External size mm	Internal size mm	Depth mm	For side
20.027.40	520x280	484x244	105	Right
20.027.41	520x280	484x244	105	Left



▲20.027.40



▲20.027.41

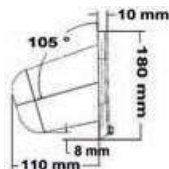

### Storage compartment

Made of polished ABS with snap closure.

Code	External size mm	Internal size mm	Depth mm	With lock
20.027.61	470x180	435x145	110	yes

**Side housing fitted with two glass/can/small bottle holder**

Made of white ABS. Also designed for speaker bulkhead mounting.

Code	Outside mm	Inside mm	Depth mm	Side
20.027.01	740x320	685x275	120	right
20.027.02	740x320	685x275	120	left

**Glass/mug/bottle side holder**

White polished ABS.

Code	Outside mm	Inside mm	Depth mm
20.029.00	290x290	250x170	64

**Wall-mounting peak**

Made of white polished ABS, fitted with hinged hatch.

Code	Outside mm	Net compartment mm	Depth mm
20.023.00	220x195	135x180	70
20.022.00	545x255	190x490	116

**Twin-compartment locker designed for wall mounting**

White ABS, pre-set for 1-kg type-tested extinguisher and storage box.

Code	Extinguisher compartment mm	Object locker mm	External size mm	Recess mm
20.030.00	300x130	285x210	370x440	300x360x125

**Storage locker for toilets**

Suitable for storing personal toiletry items or medicines

Code	External size mm	Recess mm	Depth mm
20.035.00	260x260	190x190	75

**Storage pocket**

Made of sturdy white sail fabric, suitable for stowing lines, winch handles, personal objects, etc. It includes wall mounting eyelets and upper elastic band.

Code	mm		Compartments
	height	width	
20.175.24	250	400	1 with elastic
20.175.26	330	400	1 with elastic
20.175.28	310	400	8, 7 of which are open and 1 with hook&loop fastener



20.175.24



20.175.28



20.175.26

# Inspection hatches, type-tested in compliance with Directive 2013/53/UE



▲20.840.00 / 20.844.00



▲20.840.50

## Inspection hatch with cover, CE approved

Antiskid **watertight** surface, recess hole with swivelling hollow flat. It can be installed on any sports craft, boat design category A, B, C, and D, area II a, III, IV, watertightness degree 2.

White	Cream RAL 9001	Black	Grey	Max external Ø mm	Passage mm	Recess Ø mm	Hole centre distance mm
20.840.00	20.840.40	20.840.50	20.840.60	265	190	215	242
20.844.00	-	20.844.50	-	315	240	270	290



▲20.840.40



▲20.840.60

**CE APPROVED**  
based on  
UNI EN ISO 12216:2004



## Hatch fitted with hidden screws and cam cover locking

Code	Max outer Ø mm	Inner Ø mm	Recess mm
20.845.00	325	240	290

## Easy opening inspection hatches

Screw locking, **watertight**, equipped with rubber O-RING; fitted with ridge for easy opening (non flush).

Code	Outer Ø mm - A	Opening Ø mm - B	Color
20.201.00	145	100	<input type="checkbox"/> white
20.202.00	170	127	<input type="checkbox"/> white
20.203.00	206	155	<input type="checkbox"/> white



▲20.199.01/02/03



▲20.199.11/12/13

## Polypropylene Inspection hatches, fitted with hidden mounting screws

Screw-locking, 100% watertight, equipped with rubber O-RING

White	Black	External Ø mm	Opening Ø mm
20.199.01	20.199.11	160	102
20.199.02	20.199.12	182	127
20.199.03	20.199.13	220	152

## Stylish and practical EC type-approved inspection hatch.

Screw turning lock, 100% watertight, fitted with rubber O-RING.



▲20.205.00;20.204.00;  
20.206.00;20.207.00  
20.206.00;20.207.00



▲20.205.01;20.204.01;  
20.206.01;20.207.01  
20.206.01;20.207.01

Polypropylene			Clear with white ring nut	Outside Ø mm	Opening Ø mm
white	black	Grey RAL 7042			
20.204.00	20.204.20	20.204.30	20.204.01	147	102
20.206.00	20.206.20	20.206.30	20.206.01	172	125
20.205.00	20.205.20	20.205.30	20.205.01	205	152
20.207.00	20.207.20	20.207.30	20.207.01	260	203



▲20.205.20;20.204.20;  
20.206.20;20.207.20  
20.206.20;20.207.20



▲20.205.30;20.204.30;  
20.206.30;20.207.30  
20.206.30;20.207.30

**CE APPROVED**  
based on  
UNI EN ISO 12216:2004

**Polypropylene inspection hatch, fitted with rotating lock and bayonet**

100% flush. The lid also covers the screws.

white	black	Ø Outer mm	inner Ø mm
20.337.01BI	20.337.01NE	135	100
20.337.02BI	20.337.02NE	204	155

**Watertight white/transparent ABS inspection hatch**

Fitted with rear nylon object/document holding bag.

Code	External Ø mm	Internal Ø mm
20.209.00	205	150

**Watertight inspection hatch with quick opening**

Made of **AISI 316 stainless steel**, 1/4 turn opening with winch handle (not included). The cover remains attached to the winch handle for easy removal.

Code	External Ø mm	Passage mm
20.103.50	132	91
20.100.20	141	95
20.100.40	185	120
20.100.50	247	203

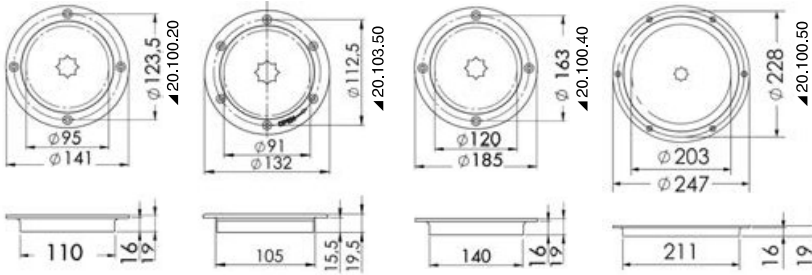
**OSCULATI****Watertight WHALE hatch, fitted with screw cover**

Fitted with nitrile seals; approved for lifeboats; made of **nylon**; it can bear a maximum internal pressure of 0,46 kg/cm<sup>2</sup> = 6,5 psi.

Code	Plug color	Ø Outer mm	Opening mm	Thickness mm	housing mm	holes on centre mm
20.400.00	black	236	180	32	187	212
20.400.01	- transparent	236	180	32	187	212

**Whale®****Compartments and deck fillers****Flush-mount plastic compartment for fuel plug housing**

Made of hydrocarbon-resistant nylon

Code	Recess mm	Inner size mm	Frame mm	Colour
20.899.00	110x155	78	182x136	White
20.899.50	110x155	78	182x136	Black

**Built-in compartment for Deck Filler**

Fitted with hatch, made of hydrocarbon-resistant nylon.

Code	Version	Color	A mm	B mm	C mm	D mm	E mm	Symbol
20.900.01	Standard	White	190	148	150	113	71	Fuel
20.900.02	With lock	White	190	148	150	113	71	Fuel

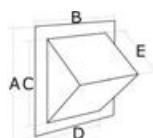





**Nylon deck filler with built-in vent, snap-in opening**

Code	Type	Colour	Base mm	Protrusion mm	Neck Ø mm
20.670.01	FUEL	White	110x70	18	38
20.670.02	WATER	White	110x70	18	38



▲20.669.02



▲20.669.04



▲20.669.05

**Nylon/fiberglass white fuel plugs, made in accordance with EC standards**

Code	Type	Cap colour	Flange Ø mm	Neck length mm	Neck Ø mm
20.669.02	FUEL	Red	88	65	50
20.669.04	FUEL	Green	88	65	38
20.669.05	WATER	Blue	88	65	38

**OSCULATI**



**Black nylon deck fillers**

Code	Type	Ø Neck mm	Ø Cover mm	Neck length mm
20.868.02	WATER	38	89	65
20.868.03	DIESEL	50	89	65
20.868.04	FUEL	38	89	65
20.868.05	WASTE	38	89	65

**Deck fillers  
CLEVER**



### Clever deck fillers made of composite and stainless steel

Body made of technopolymer and co-moulded mirror-polish stainless steel cover.

- Flush design.
- 1/4-turn quick opening (except Waste version).
- The lanyard can be replaced in case it breaks.
- Coloured inner star-shape element for unobtrusive yet effective detectability.

Waste version: 38/50 double diameter complying with the ISO 8099 standards.

Code	Type	Neck Ø mm	Flange Ø mm	Projection mm	A mm	B mm	C mm
20.463.01	FUEL	50	88	8,5	92	80	-
20.463.02	WATER	38	88	8,5	92	80	-
20.463.03	DIESEL	50	88	8,5	92	80	-
20.463.04	FUEL	38	88	8,5	92	80	-
20.463.09	WASTE	38+50	88	8,5	92	123	85



▲20.463.09



▲20.463.02

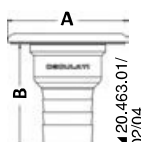

▲20.463.01/0204



▲20.463.03



▲20.463.09

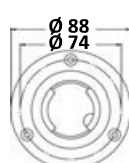

OSCOLATI



▲20.463.01/04



▲20.463.02



▲20.463.03



▲20.463.09

### Chromed brass deck filler

Fitted with special opening system that avoids the use of keys, coins or any other device. Designed to cover the flange **completely**, thus improving its watertight features. Version fitted with straight or 30° sloped joint pin (to be used when the fueling surface is sloped, in accordance with ISO 8099/1 standards). Fitted with small internal chain, 88-mm max Ø. RINA type-approved.

Chromed brass deck filler				Chromed brass deck filler only with key without sleeve
Code	Type	Version	Neck Ø mm	
20.667.01	FUEL	Straight	50	20.668.21
20.667.02	WATER	Straight	38	20.668.23
20.667.03	DIESEL	Straight	50	20.668.22
20.667.04	FUEL	Straight	38	20.668.21
20.667.06	WASTE	Straight	38	-
20.667.07	WATER	Straight	50	20.668.23
20.667.08	FUEL	30° angle	38	20.668.21
20.667.09	FUEL	30° angle	50	20.668.21
20.667.10	WATER	30° angle	38	20.668.23
20.667.11	DIESEL	30° angle	50	20.668.22

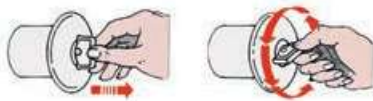

▲20.667.02



▲20.667.01



▲20.667.11



▲20.668.21/22/23



▲20.667.03

### Utility chromed brass deck filler for flush mounting with rotating opening lever

The special rotating lever opening system avoids the need for keys, coins, screwdrivers or any other device; certified by RINA.

Code	Type	Neck Ø mm
20.367.01	FUEL	50
20.367.02	WATER	38
20.367.03	DIESEL	50
20.367.11	FUEL	38
20.367.12	WATER	50
20.367.13	NO WRITING	38





**Chromed brass filler cap**

Hidden lever opening. Innovative system to prevent water ingress. 7-mm projection.

Code	Type	Version	Neck (D1) Ø mm	Flange (D) Ø mm	Length (H) mm
20.666.02	WATER	Straight	38	88	81
20.666.03	DIESEL	Straight	50	88	81
20.666.04	FUEL	Straight	38	88	81
20.666.09*	WASTE	Straight	38	88	115
20.665.02	WATER	Sloped at 30°	38	88	-
20.665.04	FUEL	Sloped at 30°	38	88	-

\* Conforming to ISO 8099, long neck.

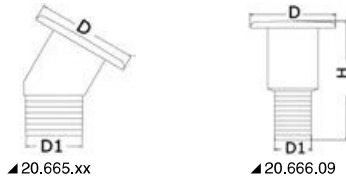

**Chromed brass deck filler with key**

The key cover is also used as opening handle

Chromed brass deck filler with key					Chromed brass deck filler only with key without sleeve
Code	Type	Version	Neck Ø mm	Outer Ø mm	
20.668.05	FUEL	Straight	38	95	20.668.21
20.668.01	FUEL	Straight	50	95	20.668.21
20.668.03	DIESEL	Straight	50	95	20.668.22
20.668.02	WATER	Straight	38	95	20.668.23
20.668.06	WASTE	Straight	38	95	-
20.668.08	FUEL	30° angle	38	95	20.668.21
20.668.09	FUEL	30° angle	50	95	20.668.21
20.668.10	DIESEL	30° angle	50	95	20.668.22
20.668.11	WATER	30° angle	38	95	20.668.23



**Chromed brass fuel deck plug**

3-hole ring screw mounting. Knurled finish plug for better grip.

Code	Neck Ø mm
20.155.00	60



**Mirror polished stainless steel deck fillers, flush mounting, fitted with opening handle**

Flush mount, deck plug opening handle; fitted with safety small chain, **new version with precision-cast plug**; available with straight joint pin or 45° inclined with respect to the vertical one (to be used when the fuelling level is inclined).

Code	Type	Version	Neck Ø mm	Flange Ø mm
20.467.01	FUEL	Straight	50	80
20.467.02	WATER	Straight	38	80
20.467.03	DIESEL	Straight	50	80
20.470.00	FUEL	With 45° angled fitting	38	80
20.470.01	FUEL	With 45° angled fitting	50	80
20.470.02	WATER	With 45° angled fitting	38	80

### Precision cast mirror polished AISI 316 stainless steel Deck filler plugs Fuel, low profile

Clean flat finish (protrudes 6mm once installed). To be opened with a winch handle or with hex keys.

Code	Type	Neck Ø mm	cover Ø mm	neck width mm
20.450.01	FUEL	50	87	55
20.450.02	WATER	38	87	55
20.450.03	DIESEL	50	87	55
20.450.04	WASTE	38	87	55

20.715.10; 20.169.90; 20.714.01 *Opening key OPTIONAL*



### "Francia" Mirror-polished AISI 316 stainless steel deck fillers

With symbols in compliance with DIN standards. Opening by means of the winch handle hexagon.

Code	Type	Neck Ø mm	Flange Ø mm	Length mm	Notes
20.461.02	WATER	38	90	75	With key
20.461.03	DIESEL	50	90	82	With earth connection
20.461.04	ESSENCE/ PETROL	50	90	82	-
20.461.06	WASTE	50	90	75	Without chain
20.461.09	WASTE	38	88	114	Without chain
20.461.12	DIESEL	54	90	82	Beneteau/Jeanneau version up to 2017

20.715.10; 20.714.01 *Opening key OPTIONAL*



### AISI316 stainless steel deck filler

Precision cast and mirror polished, RINA certified. Opening lid, screws fully covered by the flange.

Code	Type	Neck Ø mm	Flange outer Ø mm	Key
20.568.21	FUEL	50	88	yes
20.568.22	WATER	38	88	yes
20.568.23	DIESEL	50	88	yes
20.568.06	WASTE	38	88	no
20.568.31	FUEL	38	88	yes



### Precision-cast mirror polished AISI316 stainless steel deck filler

Flush-mount plug, invisible screws hidden by the deck filler cap.

Code	Type	Port Ø mm	A mm	B mm	C mm
20.866.23	WATER	38	84,5	12	76
20.866.35	WASTE	38	84,5	12	76
20.866.39*	WASTE	38	96,3	11	114
20.866.30	FUEL	38	84,5	12	76
20.866.31	DIESEL	50	95,5	12	81,5
20.866.32	FUEL	50	95,5	12	81,5

\* In compliance with ISO 8099, long neck



### Square deck fillers

Tip-over opening system. Thin profile with only 3,5 mm thickness. Made of mirror-polished AISI 316 stainless steel.

Short version	Long version	Hose Ø mm	Type
20.454.01	-	38	FUEL
20.454.02	20.455.02	38	WATER
20.454.03	20.455.03	38	DIESEL
20.454.06	20.455.06	38	WASTE

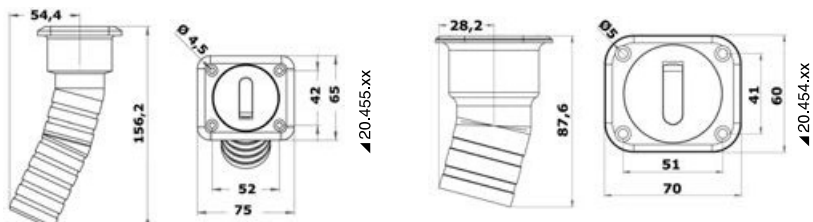



**OSCU**

**Quick Lock - Deck Filler - User Manual**

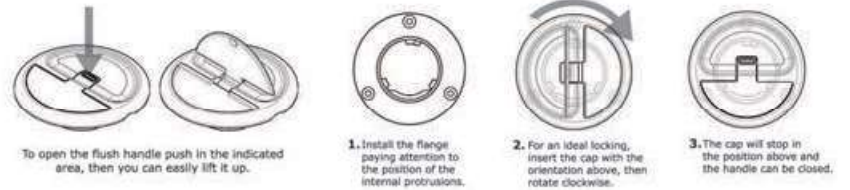

**Quick Lock deck fillers**

**AISI 316**

Technical characteristics: 45° rotation snap lock, 7,7-mm projection, hidden screws, stainless steel check cable with spring, fuel and diesel versions with earthing cable, made of mirror-polished AISI 316 stainless steel, DIN standard symbols.

**REGISTERED DESIGN / DISEGNO DEPOSITATO**

Code	Type	Version	Neck Ø mm	Outside Ø mm	Neck thickness	With key
20.366.01	FUEL	Straight	50	94	81,9	20.366.21
20.366.02	WATER	Straight	38	94	82,5	20.366.22
20.366.03	DIESEL	Straight	50	94	81,9	20.366.23
20.366.04	FUEL	Straight	38	94	82,5	20.366.24
20.366.05	WASTE	Straight	38	94	82,5	-
20.366.09*	WASTE	Straight	38	94	82,5	-
20.366.11	FUEL	30°	50	94	96	20.366.31
20.366.12	WATER	30°	38	94	92	20.366.32
20.366.13	DIESEL	30°	50	94	96	20.366.33
20.366.14	FUEL	30°	38	94	92	20.366.34
20.366.15	WASTE	30°	38	94	92	-



\* In compliance with ISO 8099, long neck, screw thread (no chain)

**20.366.98** Spare key.



**OSCU**

**Mirror polished AISI 316 stainless steel refuel plugs, fitted with built-in vent**

Fitted with special clever system, the plug neck can be mounted on the deck with just one hole



Code	Type	Neck Ø mm	Mounting hole Ø mm	Vent Ø mm	Plug Ø mm	Size mm	Mounting ring nut Ø mm
20.565.01	FUEL	38	50	16	82	14	74
20.565.02	WATER	38	50	16	82	14	74
20.565.03	DIESEL	38	50	16	82	14	74
20.565.05	DIESEL	50	50	16	82	14	74

**Flush-mount deck filler**

Mirror polished AISI316 stainless steel deck fillers, fitted with 30° elbow. Plug opening with universal key type 20.169.90.

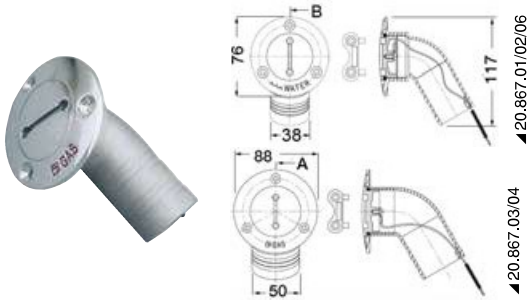

Code	Type	Neck Ø mm	Flange Ø mm
20.867.01	FUEL	38	76
20.867.02	WATER	38	76
20.867.03	FUEL	50	88
20.867.04	DIESEL	50	88
20.867.06	WASTE	38	76

**Anti-theft device for filler plugs**

Made of polished AISI 316 stainless steel, it fits all plugs on the market and can be installed without removing the existing plug by simply loosening the fastening screws.



Code	Writing
20.569.01	GAS
20.569.02	DIESEL

**Hose connector to make waste deck filler ISO8840-compliant**

To be screwed onto thread filler caps, BSP for connection to the dock draining nozzles in compliance with ISO8840.

Code	Thread	Ø thread	For deck fillers
20.866.90	1 1/2"	47,80	20.366.09; 20.450.04; 20.461.09; 20.463.09; 20.666.09; 20.667.06; 20.668.06; 20.866.39
20.866.91	1 1/4"	41,90	20.454.06; 20.455.06
20.866.92	<b>New</b> 1 1/8"	37,90	-

**Deck filler keys****Universal plug keys**

Code	Description
20.169.90	Made of <b>stainless steel</b> , designed to unscrew fuel filler cap

**Handle suitable for opening fuel/water and locker plugs**

Code	Description
20.714.01	Made of <b>AISI 316 stainless steel</b> . Standard hexagon winch-type for sailboat.

**Water/fuel plug opening fiberglass key**

Code	Description
20.460.11	Hexagonal – To open 20.461.03. Recommended for Jeanneau/Beneteau diesel plugs from 2000 on.
20.715.10	Octagonal – Winch handle type recess, 100-mm length.

**Tank vents****Plastic vent**

Made of **nylon** with double internal mesh. Designed in compliance with the requirements of the UNI EN ISO 21487 regulation.

Code	Hose fitting Ø mm
20.283.00	16

**ATTWOOD special fuel vent**

16-mm 90° hose adaptor and vent fitted with valve to **totally** prevent water from getting into the hull. **Nylon** body, **polished stainless steel** outer part. Designed in compliance with the requirements of the UNI EN ISO 21487 regulation.

Code	Hose fitting Ø mm
20.446.19	16

**Elbowed fuel vent**

Made of **nylon**, fitted with double internal screen. Designed in compliance with the requirements of the UNI EN ISO 21487 regulation.

Code	Hose fitting Ø mm
20.287.90	19

**Chromed brass fuel vent**

Splash-proof screen protection. Designed in compliance with the requirements of the UNI EN ISO 21487 regulation.

Code	Ø Hose adaptor mm
20.120.80	16
20.172.01	20

**Mirror polished stainless steel fuel vent**

Fitted with fire-proof screen and hose adaptor. Designed in compliance with the requirements of the UNI EN ISO 21487 regulation.

For pipe Ø mm	degree angle 90°	straight
16	20.288.01	20.287.80
19	20.289.01	20.287.82
25	-	20.287.81

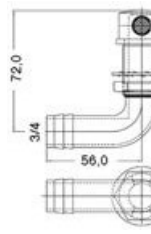
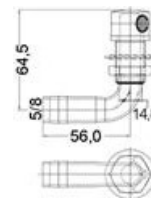
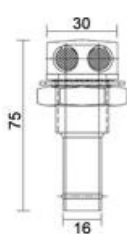
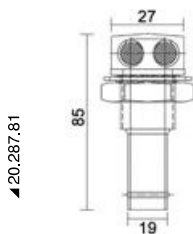
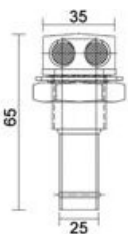

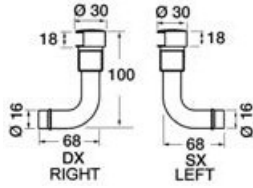

**Chromed brass fuel vents with 90° hose adaptor**

Fitted with flame-proof screen. Designed in compliance with the requirements of the UNI EN ISO 21487 regulation.

Code	Direction	Hose adaptor Ø mm
20.287.91	right	16
20.287.92	left	16



▲ 20.284.01;  
20.286.01



▲ 20.285.01/03



▲ 20.285.02/04

**Chromed brass flush mount fuel vent**

Fuel vents. Designed in compliance with the requirements of the UNI EN ISO 21487 regulation.

90° elbow, right	90° elbow, left	Straight	Hose adaptor Ø mm
20.285.01	20.285.02	20.284.01	16
20.285.03	20.285.04	20.286.01	20

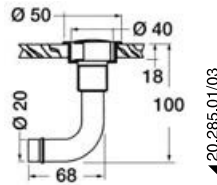

▲ 20.285.01/03

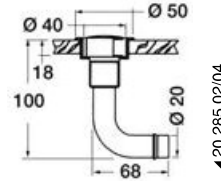

▲ 20.285.02/04



▲ 20.274.16/19

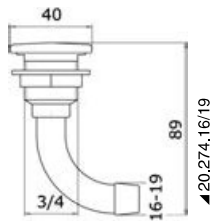

▲ 20.274.16/19

**Full Flush chromed-brass fuel vent**

The vent is located in the lower part for a completely closed design. Designed in compliance with the requirements of the UNI EN ISO 21487 regulation.

90° model	Straight model	Hose adaptor Ø mm
20.274.16	20.275.16	16
20.274.19	20.275.19	20



▲ 20.275.16/19

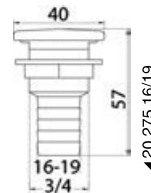

▲ 20.275.16/19

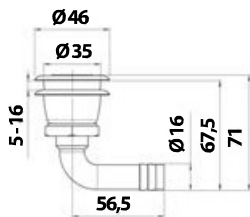

**Flush-mount fuel vent made of stainless steel.**

With flame-resistant grid. Designed in compliance with the requirements of the UNI EN ISO 21487 regulation.

Code	Hose fitting
20.271.02	90°



▲ 20.272.01/02



▲ 20.273.01/02

**Cast and mirror polished AISI316 stainless steel fuel vents**

Fitted with flame-proof screen, detachable for easy maintenance. Designed in compliance with the requirements of the UNI EN ISO 21487 regulation.

Model 90°	Model straight	For pipe Ø mm	Bulkhead hole mm	Bulkhead thickness mm	Ø head mm
20.272.02	20.272.01	16	35	7/24	45
20.273.02	20.273.01	19	38	8/27	49

**90° fuel vent made of stainless steel wire**

Designed with a patented system, it is perfectly flush with the bulkhead and can be adjusted right or left. Chromelux finish. Designed in compliance with the requirements of the UNI EN ISO 21487 regulation.

Code	Fitting	Mounting hole mm	hose adaptor mm	head Ø mm
20.267.60	with 3 screws	40	16	66
20.267.69	with 3 screws	40	19	66
20.267.61	invisible	40	16	50

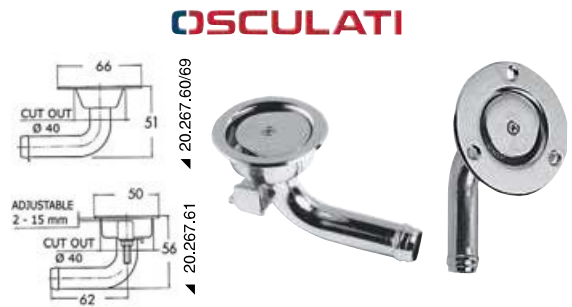
**Mirror polished AISI 316 stainless steel fuel vent, fitted with anti-flood system**

Fitted with fire- and flood-proof screen. Made of nickel-plated micro-pore bronze. Designed in compliance with the requirements of the UNI EN ISO 21487 regulation.

Code	Hose adaptor for pipe size mm	Head Ø mm	Size mm
20.268.00	16	35	7,5

**Vent trap**

20.251.00 Made of polypropylene, it suits all 16-mm Ø vents and avoids water from flowing in.

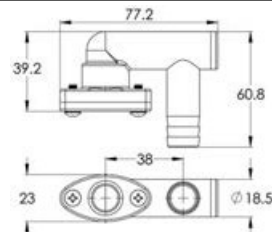
**Ecologic device to be fitted along the fuel vent piping system**

20.250.00 It lets **only** air out and blocks the fuel when it arrives, therefore it **eliminates the streaks of fuel** on the boat sides.

When fuel is near this device, the hiss of the passing air stops to indicate that the tank is full.

**Fuel block device, certified ISO 7840**

20.250.02 It lets air in and block fuel when it arrives.

Coated in a Pyrojacket sheath, fastened with heat-resistant clamps supplied with the device and resistant to high temperatures.

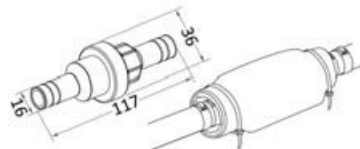
**Fuel-Lock vent with trap to prevent water to flow back**

Fuel-Lock lets air but not fuel out. Fuel is locked inside by a trap system that removes marine pollution and streaks on the side.

An internal bulkhead device also avoids water to reach the tank through the vent. Polished AISI 316 stainless steel external element, hydrocarbon-resistant copolymer polypropylene internal element.

Code	Hose adaptor for hose Ø mm
20.168.22	16

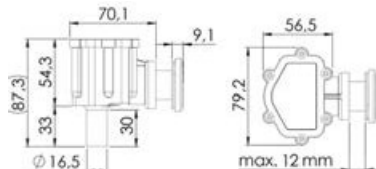

OSCULATI

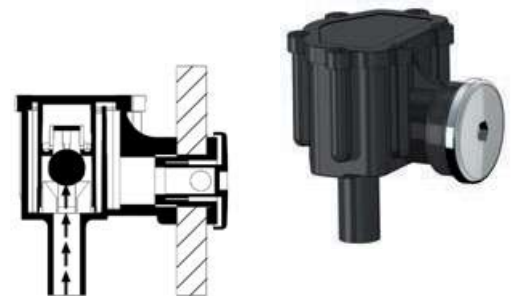
**Anti-Froth funnel to be connected to the fuel filler cap**

Designed to prevent foam and fuel overflowing when refuelling. The device causes the foam to turn back into liquid, which then flows to the tank.

Code	For plugs Ø mm
20.364.00	38/50

